

SPECIFICATIONS

DESCRIPTION:

MR16 halogen sign light with a 24" 90° stem extension. Suitable for wet/damp/dry location installations.

MATERIAL:

Standard overall material is 6061 aluminum.

HL-716 - Machined Aluminum

FINISH:

AA - Anodized Satin Aluminum

AP - Powder Coat Aluminum

BK - Powder Coat Black

BZ - Powder Coat Bronze

WT - Powder Coat White

HALOGEN LAMPING OPTION:

Lamp Type - 12V halogen MR16 lamp, bi-pin
GX5.3 base, 50W max, not included.

LED OPTIONS:

Integral high output LED, warm white
(3000K CCT) standard, others available.

3LED - 3W LED

8LED - 8W LED

Optics

SP - Spot, 12°

NF - Narrow Flood, 24°

FL - Flood, 36°

VOLTAGE:

12 - 12 VAC output transformer required, not included.

MOUNTING:

Fixture is equipped with a 4.75" mounting plate and (2) mounting screws.

OPTIONS:

Glare shields

GL-10 - Short Angled, aluminum

GL-11 - Angled, aluminum

GL-13 - Straight, aluminum

Lenses/Louvers/Color Filters

LA-1 - Hexcell Louver (Black)

LA-2 - Prismatic lens

LA-3 - Linear spread lens

LA-4 - Soft focus lens (diffused)

LA-5 - Moonlight lens

LA-6 - Blue lens

See fixture accessories for more information.

SAMPLE ORDER SPECIFICATION:

HL-716-AA-12-GL-13-LA-3

RATING:

Wet/damp/dry location.



MADE IN THE USA

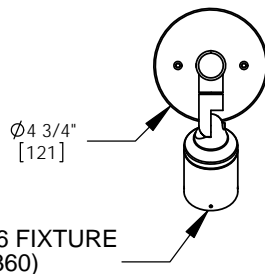
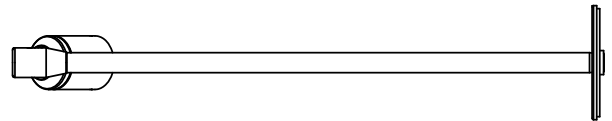
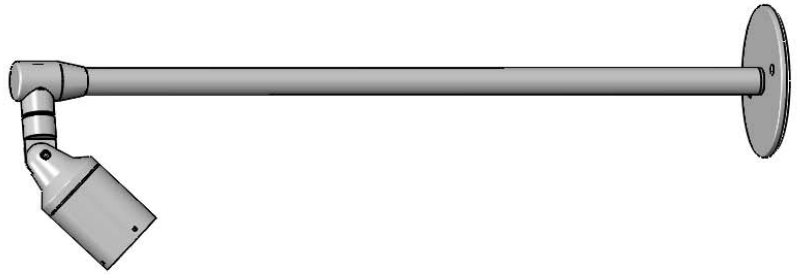

MR16 FIXTURE
(HL-360)

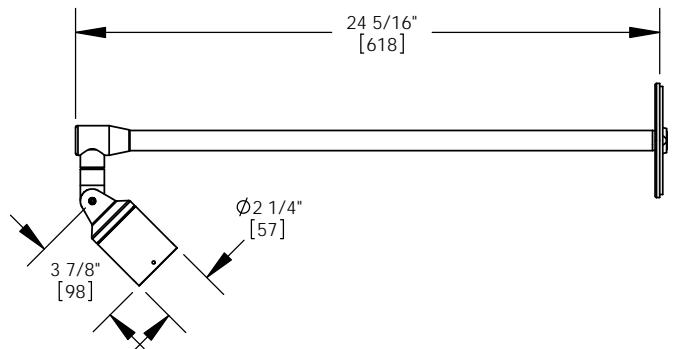

ORDER SPECIFICATION: _____ - _____ - _____ - _____ - _____
Fixture Finish Lamping Voltage Options/Access.

PROJECT:

APPROVED:

NOTE:

TYPE:



HEVI LITE, INC.

9714 Variel Ave, Chatsworth, CA 91311
Tel., (818) 341-8091 - Fax (818) 998-1986
Web Site <http://www.hevilite.com>

CATALOG NUMBER:

HL-716