

## Reading in Libby

On your **Shelf**, tap the cover of the book you want to read. To start reading, swipe to the right to change the page.

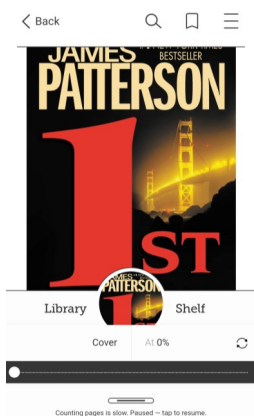

Tap the bottom of your screen to bring up the **status bar** that allows you to track how many pages you've read or choose to go back to your bookshelf.

## Your Shelf

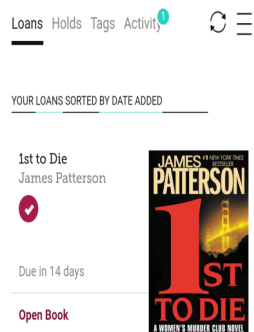

Your **Shelf** allows you to look at your **Loans**, check on your **Holds** to see your place in line and what your estimated wait time is, add **Tags** to your books (such as "Liked It" or "Hated It") and track your reading history through the **Activity**

## Renewing and Returning Items

To renew a title or return one to the library, go to the **Loans** tab on your **Shelf**. Click the book cover for the title you wish to renew or return.

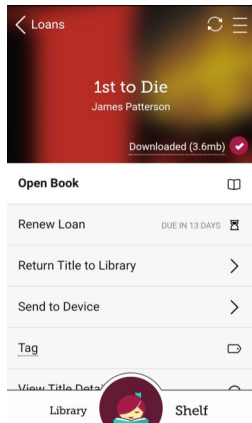

To **Renew** a title, tap **Renew Loan** and follow the prompts on the page. To **Return A Title**, tap **Return Title to Library**.

## Sending a Title to Another Device

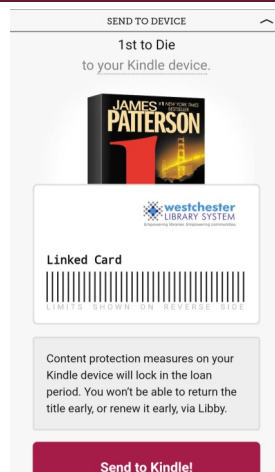

On your **Shelf**, tap the cover of the book you want to send to another device. Tap **Send to Device**. Follow the prompts that come up on the next screens. **Note:** Kindle limits how much time you have with each title so once the

title is sent to your Kindle, you may not be able to renew it or return it early.

If you have any questions please contact us at [optech@wlsmail.org](mailto:optech@wlsmail.org)



# Libby, by OverDrive



## A How-To Guide for Android Devices

Ossining Public Library  
[www.ossininglibrary.org](http://www.ossininglibrary.org)  
[optech@wlsmail.org](mailto:optech@wlsmail.org)

## What is Libby?

Libby is an app from OverDrive with a built-in ebook reader and audiobook player. The app allows you to sign in with multiple library cards, download books and audio for offline reading and access your holds and loans on a single bookshelf.

## How To Get Libby

Search the Google Play Store for "Libby" and download the Libby, by OverDrive app.

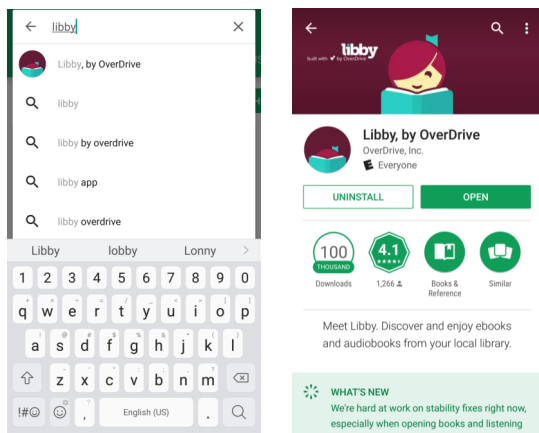

## Logging In

To log-in to the Libby app, you will need your **Library Card Number** and **PIN**. When the app opens, tap **Add It Now** to sign in to your account.

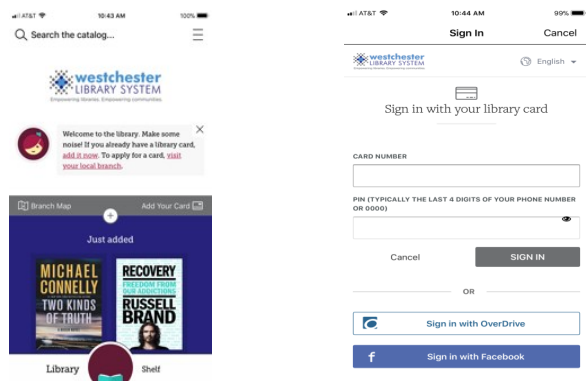

## Finding Books With Libby

You can **Search** the Libby collection by title, author, or keyword, or **Browse Popular Collections**.

## Borrowing a Title

After you've found the title you want to borrow, tap **Borrow**.

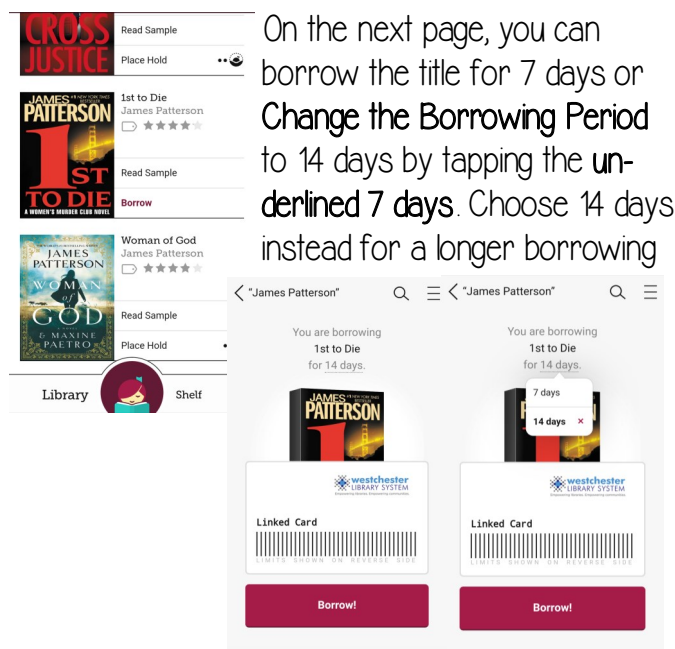

Tap the burgundy Borrow! Button to check the title out. You can **Go To Your Shelf** to begin reading or **Keep Browsing** the library collection.



## Placing A Hold

If the title you want to read is unavailable, you may **Place A Hold** by tapping **Place Hold**. You'll be taken to a new screen where you can read a sample of the book or can continue browsing the library collection.

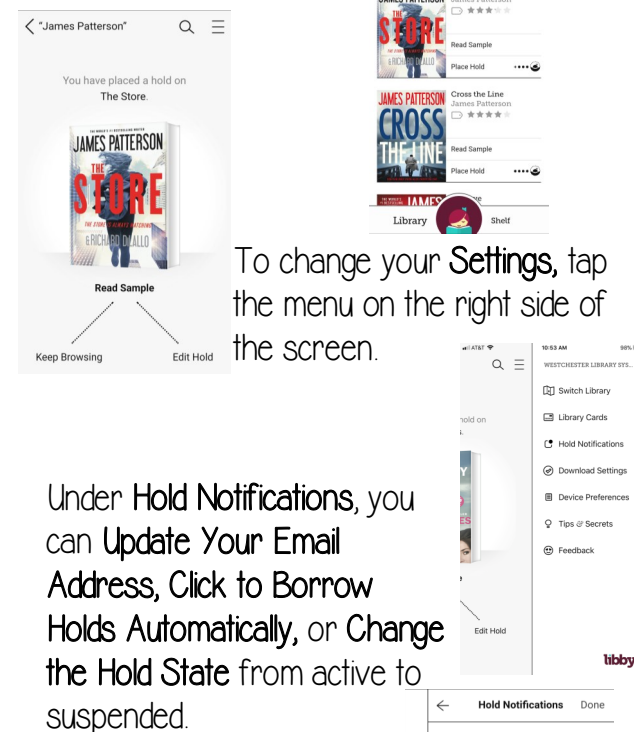

Under **Hold Notifications**, you can **Update Your Email Address**, **Click to Borrow Holds Automatically**, or **Change the Hold State** from active to suspended.

You can also change your **Download Settings** so that books will only download when you are connected to Wifi.

