



# Building a Better Halton

April 8, 2021

## Road Resurfacing Program

Intersection of Appleby Line  
(Reg. Rd. 20) and Upper Middle  
Road (Reg. Rd. 38)



Road resurfacing



Road improvements

### Notice of Planned Construction – PR-3342D

#### Planned Construction 2022

##### About This Project

Halton Region is planning to resurface Appleby Line (Reg. Rd. 20) from Upper Middle Road (Reg. Rd. 38) to north of Heron Way, and Upper Middle Road (Reg. Rd. 38) from Heron Way to Imperial Way/Broadleaf Crescent (see attached map), Wards 4, 5 & 6, in the City of Burlington. The construction of this project is tentatively scheduled to begin in 2022. A more detailed letter will be sent out once the construction dates are established.

As part of the project design process, Halton Region staff will be surveying, locating and marking above-ground and underground infrastructure within this area. ***Please do not disturb or remove any stakes or paint markings from your property. Our staff will remove them once the survey work is completed.***

**COVID-19 Update:** Regional staff and contractors will be following health and safety guidelines set out by the Province and Public Health to help stop the spread of COVID-19. For more information, please visit [halton.ca](https://www.halton.ca)

#### MORE INFORMATION

Building a Better Halton is about more than construction. It is about investments in infrastructure, service delivery improvements and building complete communities that maintain the high quality of life that residents expect and enjoy.

For more information about Regional improvement projects:

- Visit [halton.ca](https://www.halton.ca)
- Sign up to receive email notices and updates
- Email [accesshalton@halton.ca](mailto:accesshalton@halton.ca) or call 311.



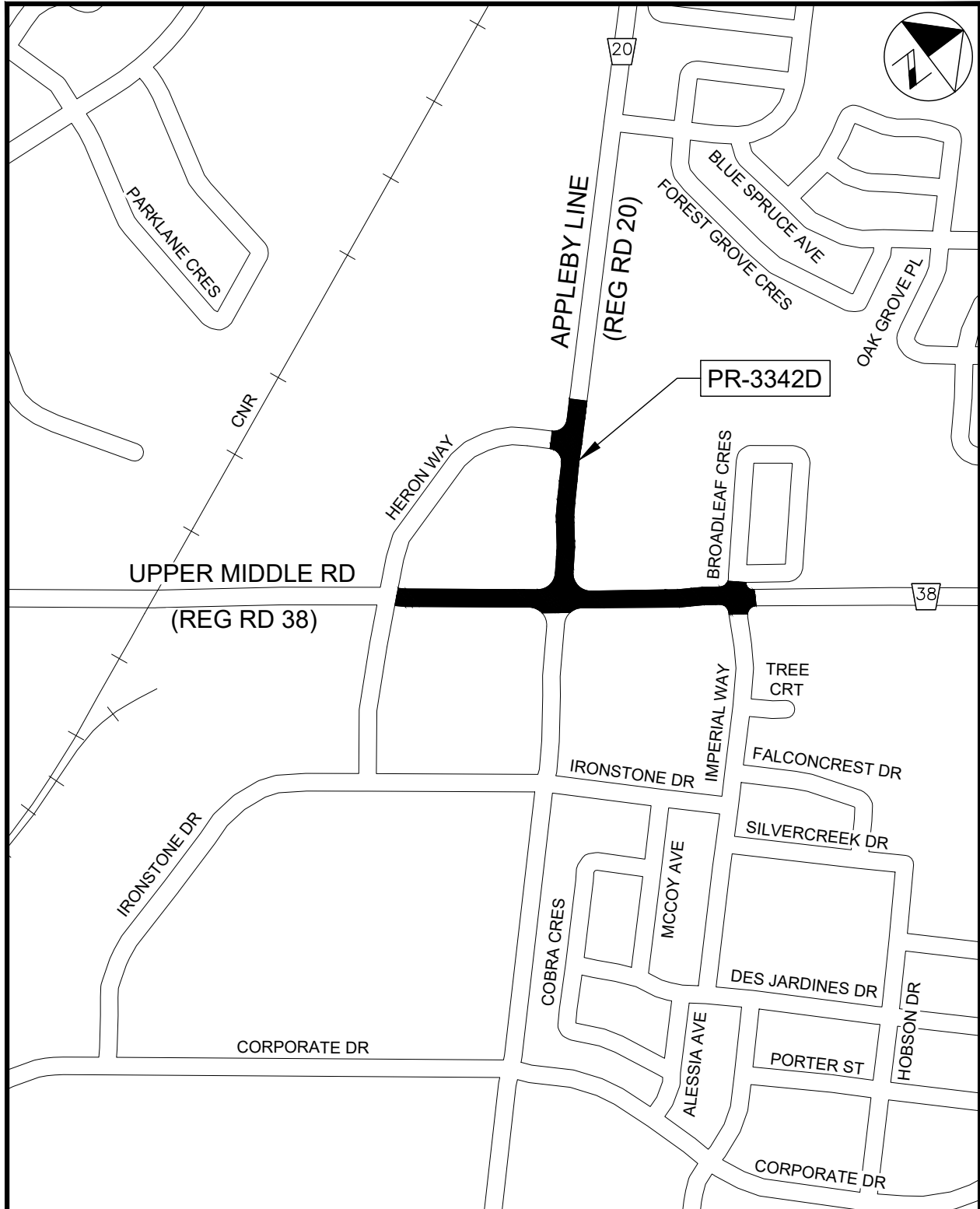

ROAD RESURFACING PROGRAM  
 INTERSECTION OF APPLEBY LINE (REG RD 20)  
 AND UPPER MIDDLE ROAD (REG RD 38)  
 WARDS 4, 5 & 6, IN THE CITY OF BURLINGTON  
 PR-3342D

PUBLIC WORKS

APRIL 2021