

Exclusive Charter



Wilmington Chamber of Commerce presents

# *Vienna & Christmas Markets of the Danube*

featuring Rothenburg, Nuremburg & 6 Nights aboard the Amadeus Queen

9 Days November 28, 2022



**BOOKING  
DISCOUNT!**

Save \$200 per person  
\$400 per couple\*

\*See Reservation Info for  
Booking Discount details





9 Days November 28, 2022

## Vienna & Christmas Markets of the Danube

### Day 1 - DEPART US - OVERNIGHT FLIGHT

### Day 2 - ARRIVE FRANKFURT

Meet your CE Tour/Cruise Manager - Hotel Transfer/Check In

**Frankfurt Christmas Market Experience** - Welcome Drink at the hotel  
*Overnight - Frankfurt*

### Day 3 - FRANKFURT - ROTHENBURG - NUREMBERG

Travel via motorcoach to Rothenburg

Enjoy a **Rothenburg City Walking Tour & Christmas Market Experience**

Travel to Nuremberg & board the **MS Amadeus Queen** for 6 Night Cruise

**Welcome Dinner Onboard** - Ship docked overnight in Nuremberg

⊗ (B,D) *Overnight - Amadeus Queen*

### Day 4 - NUREMBERG

Morning **Nuremberg City Tour & Christmas Market Experience**

Afternoon Cruising - Passage of the Continental Divide

⊗ (B,L,S & D) *Overnight - Amadeus Queen*

### Day 5 - REGENSBURG

Morning **Regensburg Walking Tour & Christmas Market Experience**

Ship docked into the evening in Regensburg

⊗ (B,L,S & D) *Overnight - Amadeus Queen*

### Day 6 - PASSAU

Morning **Passau Visit & Danube Cruising** or *Salzburg Optional Tour*

⊗ (B,L,S & D) *Overnight - Amadeus Queen*

### Day 7 - MELK - VIENNA

Morning visit to **Melk Abbey & Gluehwein Tasting**

Afternoon Cruising to Vienna

Evening arrival in Vienna - *"Sound of Vienna" Concert Optional*

⊗ (B,L,S & D) *Overnight - Amadeus Queen*

### Day 8 - VIENNA

Morning **Vienna City Tour - Optional Tour to Schoenbrunn Palace**

**Gala Farewell Dinner Onboard**

⊗ (B,L,S & D) *Overnight - Amadeus Queen*

### Day 9 - VIENNA - FLIGHT HOME

Transfer to the Vienna Airport for your flight home

⊗ (B)

B-Breakfast Hotel/Onboard • S-Snacks Onboard afternoon and/or evening

L-Lunch Onboard • D-Dinner Onboard with Beer & Regional Wines

## CITIES & PORTS

### FRANKFURT

Located on the River Main, Frankfurt is the transportation center of Germany and home of the European Central Bank & the German Stock Exchange. Every year, the scent of roasted chestnuts, mulled wine and grilled sausages fill the air above the Roemerberg during the holiday season. Frankfurt's Christmas Market is famous for a number of traditional Christmas delicacies.

### ROTHENBURG

To the west of the Franconian countryside is the medieval city of Rothenburg, Germany's best-preserved medieval town. As you stroll the cobblestone streets, you are spellbound by the city's 700-year-old charm. The quaint buildings with the original half-timbered walls and the town hall square are lined with festively decorated booths. Maybe visit Kathe Wohlfahrt, a famous family run Christmas shop brimming with gifts for you to take or send home.

### NUREMBERG

Experience the world's best known Christmas Market visited by more than 2 million people every year. Located inside this medieval city's walls on the Market Square around the St. Lorenz Church, the Christmas Market has survived in its original state with specialty stalls and booths. Nuremberg's street lamp posts are decorated with Christmas symbols, garlands of natural fir and colored lights. Of course the Nuremberger Lebkuchen (gingerbread), as well as the original Nuremberger Wuerstle (small grilled pork sausages), are known worldwide.

### REGENSBURG

Situated in Eastern Bavaria, Regensburg is one of Germany's oldest towns, founded by the Romans in 179 A.D. Today it is a prosperous city with 3 universities and many landmarks dated to the Middle Ages. Enjoy a Regensburg Walking Tour through one of the most visited cities in Germany and its Medieval Old Town, a UNESCO World Heritage site, and spend time at the colorful Christmas Market.

### MELK ABBEY & GLUEHWEIN TASTING

Visit the Melk Abbey, an Austrian Benedictine abbey and one of the world's most famous monastic sites. The impressive Baroque abbey was built between 1702 and 1736. Continue by coach to the charming town of Dürnstein, one of the best-known wine villages in the Wachau on the banks of the mighty Danube. Later enjoy a mug of hot mulled wine.

### VIENNA

Enjoy an included Vienna City Tour. For over 600 years, the magnificent baroque capital city of Vienna was the seat of the mighty Hapsburg Emperors, a heritage that has bestowed it with many dazzling palaces and monuments: the lavish Hofburg Palace, the impressive Vienna Opera House and the majestic Ringstrasse. The capital is also known as the "City of Music" for having once been the home of composers such as Beethoven, Schubert, Mozart and Johann Strauss. At the traditional Vienna Christmas Market, the Rathausplatz becomes a shining fairy-tale land with 150 stands offering Christmas gifts, Christmas tree decorations, sweets and warming drinks. Maybe visit the Schoenbrunn Palace dressed for the season.

### EUROPEAN CHRISTMAS MARKETS

Enjoy this magical time of year as Europe's countries hold steadfastly onto Old World holiday tradition and transform into fairy-tale Christmas settings. The sights and sensations of the holiday season are everywhere: locals and guests savor the tastes of chocolate covered Lebkuchen (gingerbread), sizzling grilled sausages and spiced hot "Gluehwein" (mulled wine). Delight in the festively decorated markets and shopping for ornaments, crafts, candles, nutcrackers, winter hats, roasted nuts and other traditional items.

### SALZBURG - OPTIONAL FULL DAY EXCURSION

Travel to Salzburg for a walking tour of the famous Old Town, Mirabel Gardens, Mozart Square, the Dom Cathedral and historic center made famous by the "Sound of Music." See Mozart's Birthplace located at No. 9 Getreidegasse, the home where the Mozart family lived from 1747-1773. Enjoy time at leisure to shop, visit a cafe, stroll the wonderful Getreidegasse & experience the famous Christmas Markets throughout this walkable city. Later head to the picturesque village of Mondsee, another film location of "The Sound of Music". Enjoy the beautiful scenery as you return to the ship.





MS Amadeus Queen



Fine Dining

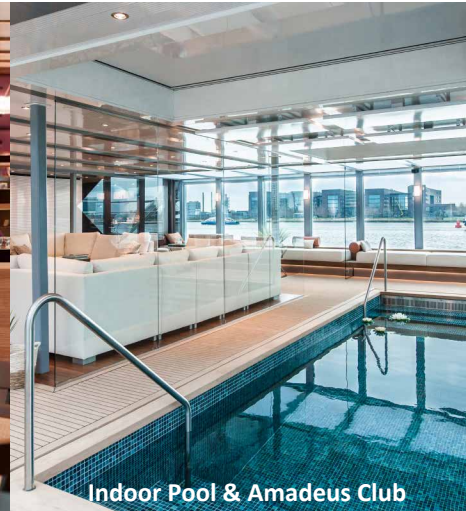

Indoor Pool & Amadeus Club

## MS AMADEUS QUEEN

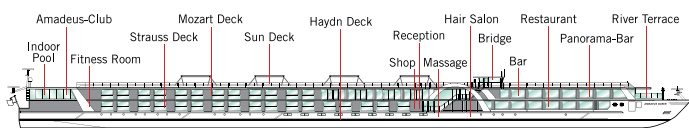

### SUN DECK

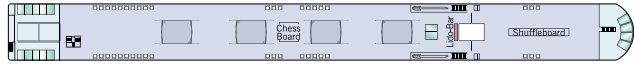

### MOZART DECK



### STRAUSS DECK

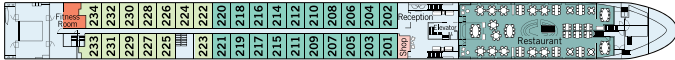

### HAYDN DECK



## THE SHIP - MS AMADEUS QUEEN

The innovative 162 passenger *Amadeus Queen*, launched in 2018, offers all the amenities of a floating 5-star hotel including an indoor pool. This Premium cruise ship features the most modern furnishings that blend masterfully with the architecture of the ship and a luxurious design that is the hallmark of the Amadeus fleet. The extensive Restaurant and the Panorama Bar offer divine views of the passing riverscapes, and the glass-shielded River Terrace allows you to relax in the open air. The attentive English-speaking onboard service staff will see to your comfort with typical European hospitality. The cabin design plans are forward-thinking, bright & modern, all part of a premium focus with 69 large Staterooms & 12 Suites. The beauty of river cruising is that the most interesting destinations come to you. This Queen charter features English-only onboard commentary with inclusive shore excursions balanced with choice to simply relax onboard, get a spa treatment or add sightseeing with optional excursions.

## ALL MEALS INCLUDED ONBOARD

Three meals daily are served graciously in the exquisite restaurant and feature local & international specialties. All dinners are four courses and are served with included regional wines & beer. While dining, you have splendid views of the passing scenic landscapes through the large picture windows. Enjoy afternoon and/or late evening snacks in the lounge based on the daily schedule.

## COMFORTABLE & INNOVATIVE STATEROOMS

After boarding, unpack once. All staterooms are larger than traditional river cruise cabins & offer excellent river views. The Mozart Deck features 12 Suites with Walk Out Balconies. The other 18 Staterooms on the Mozart Deck & 33 Staterooms on the Strauss Deck feature an innovative Drop-Down Panoramic Window. The 18 Staterooms on the Haydn Deck have a fixed window. All staterooms are fully equipped with comfortable & modern furnishings including flat screen TV & large private bathrooms with shower.

### SHIP TECHNICAL DATA

Launched:	2018	Crew members:	40
Decks:	4	Cabins/Suites:	69/12
Length/ Width (ft):	443/37.5		

## INCLUSIONS

- Roundtrip Airfare - ILM
- 1 Night Hotel - Frankfurt
- 6 Night Cruise - Outside Cabin
- 18 Meals (7-B, 5-L & 6-D)
- Tour/Cruise Manager
- Regional Wine & Beer with Dinners
- Welcome & Farewell Dinners
- Ship Staff
- Baggage Handling at Hotel & Ship
- Int'l Air Taxes/Fuel/Port Charges
- Hotel & Ship Transfers

## EXCURSIONS/TOURS

- Vienna City Tour
- Nuremberg City Tour & Christmas Market
- Frankfurt Christmas Market
- Rothenburg Walking Tour & Christmas Market
- Regensburg Walking Tour & Christmas Market
- Melk Abbey & Gluehwein Tasting
- Extended Vienna Port Docking

## RATES

Cat E - Haydn Deck	\$4095 pp dbl*	<b>\$3895 pp dbl with BD**</b>	+\$950 single
Cat D - Haydn Deck	\$4295 pp dbl*	<b>\$4095 pp dbl with BD**</b>	+\$950 single
Cat C - Strauss Deck	\$4695 pp dbl*	<b>\$4495 pp dbl with BD**</b>	+\$1400 single
Cat B - Strauss Deck	\$4895 pp dbl*	<b>\$4695 pp dbl with BD**</b>	+\$1400 single
Cat A - Mozart Deck	\$5095 pp dbl*	<b>\$4895 pp dbl with BD**</b>	+\$1800 single
Suite - Mozart Deck	\$5495 pp dbl*	<b>\$5295 pp dbl with BD**</b>	+\$2200 single

**Booking Discount - \$400 per couple/\$200 pp**

## STATEROOMS & SUITES



### STATEROOMS - 172 or 188 SQ FT

All staterooms feature 2 twin beds that can be separated or put together, flat screen TV, private bath with shower, hair dryer, closet, phone, desk, chair & safe. Mozart & Strauss Staterooms feature Drop Down Panoramic Window with 188 sq. ft. of floor space. Haydn Deck Staterooms feature a fixed window with 172 sq ft. (stateroom size & amenities can vary)

Stateroom Haydn Deck (172 sf)

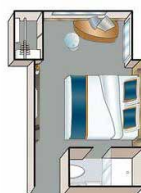

Stateroom Strauss & Mozart Decks (188 sf)



### SUITE - 284 SQ FT WITH BALCONY

All suites are on the Mozart Deck and have panoramic windows with exterior Walk Out Balcony, two twin beds that can be separated or put together, a private sitting area, flat screen TV, mini-bar, private bath with shower, hair dryer, phone, closet, desk, chair, safe & offer 284 square feet of floor space. (Suite size and amenities can vary)

Suite Mozart Deck (284 sf)



**Reservation Form (River Cruise)**Vienna & Christmas Markets of  
the Danube

November 28, 2022

Booking #151888 (Web Code)

**Contact Information/Mail Reservation Form to:**

Wilmington Chamber of Commerce

Attn: Haven Barnes

1 Estell Lee PL • Wilmington, NC 28401

910.762.2611

barnes@wilmingtonchamber.org

**Cabin Category Requested:** *(All Cabin Categories are on a space available basis)*Cat E: ☐ Cat D: ☐ Cat C: ☐ Cat B: ☐ Cat A: ☐ Suite: ☐

Enclosed please find a deposit in the amount of \$ \_\_\_\_\_ (\$500 per person)

to secure reservations for \_\_\_\_\_ # of people.

Travel Protection Plan (TPP):

*(TPP must be purchased with initial deposit)*☐ Yes, I (we) wish to purchase travel protection (TPP)☐ No, I (we) decline travel protection (TPP)

Enclosed please find payment in the amount of \$ \_\_\_\_\_ (\$440 per person)

to secure the Premier's Travel Protection Plan (TPP).

**TOTAL PAYMENT \$** \_\_\_\_\_ Make checks payable to: Chamber Explorations**RT AIR GATEWAY** \_\_\_\_\_ **ROOMMATE'S RT AIR GATEWAY** \_\_\_\_\_*see flyer page 3 for included group RT gateway/departure city, additional charges apply for other RT air packages*

To avoid change fees, submit Passport names (first/mid/last) exactly as they appear on Passports

**Passport Name:** \_\_\_\_\_DOB (MM/DD/YY) \_\_\_\_\_ Gender ☐ M ☐ F

Passport #: \_\_\_\_\_ Exp Date (MM/DD/YY) \_\_\_\_\_

Country of Issuance \_\_\_\_\_

**Roommate's Passport Name:** \_\_\_\_\_DOB (MM/DD/YY) \_\_\_\_\_ Gender ☐ M ☐ F

Roommate's Passport #: \_\_\_\_\_ Exp Date (MM/DD/YY) \_\_\_\_\_

Country of Issuance \_\_\_\_\_

Street Address \_\_\_\_\_ ☐ Check if Roommate's address is the same

City \_\_\_\_\_ State \_\_\_\_\_ ZIP \_\_\_\_\_

Email address \_\_\_\_\_ Mbl# \_\_\_\_\_

Emergency Contact/Tel# \_\_\_\_\_

Notes: \_\_\_\_\_



Cardholder Name (If paying by credit card) \_\_\_\_\_

Credit Card # \_\_\_\_\_ Exp Date: \_\_\_\_\_

CVV# \_\_\_\_\_ Amount to be charged \$ \_\_\_\_\_

Credit Card Billing Address: ☐ Check if address is the same as above

Address \_\_\_\_\_ City \_\_\_\_\_

State \_\_\_\_\_ ZIP \_\_\_\_\_ Tel# \_\_\_\_\_

Sign \_\_\_\_\_ Date \_\_\_\_\_

**SIGNATURE REQUIRED** (for credit card use & acceptance of terms\*)*\*I (We) agree to pay according to the credit card issuer agreement. I understand and accept the cancellation fees/policy and other terms.***DEPOSIT & FINAL PAYMENT**

An Initial Deposit of \$500 per person is due with Reservation Form to secure reservations. Final Payment Due Date is 90 days prior to departure.

**\*BOOKING DISCOUNT**

Make your Final Payment by check prior to the Final Payment Due Date

& receive **\$400 per couple/\$200 per person Booking Discount!**

• Initial Deposit can be made by check or credit card to be eligible.

• Payments after Initial Deposit are part of Final Payment &amp; must be made by check.

**ONLINE BOOKING OPTION**Save time, postage & secure your seat for this group departure. Simply type: <https://res.chamberexplorations.com> into your web browser & use the Booking Number (Web Code) from this flyer to make your Deposit online in just a few minutes. No need to submit a Reservation Form if booking online.**TRAVEL PROTECTION PLAN (TPP) \$440 per person**

(must purchase with Initial Deposit)

**Part A – Cancellation Waiver provided by PWD/CE****I. Trip Cancellation Waiver (TCW)** - Guarantees full refund on all payments, except the Trip Cancellation Waiver Fee itself in case of cancellation up to the time and date of departure due to the passenger's personal illness or death of an immediate family member. Medical/official documentation required.**II. "Any Reason" Cancellation Waiver (ARCW)** - Reimburses 75% of the cancellation fees in the form of a future travel credit certificate (FTCC) valid for 1 year, if you cancel more than 48 hours prior to scheduled departure for any reason not eligible for cash refund under the TCW (Part A – I.). FTCC is non-transferable, may not be redeemed for cash and does not include any credit for the Trip Cancellation Waiver Fee. **The Trip Cancellation Waiver Fee must be paid for with Initial Deposit and is refundable until 180 days prior to departure. The Trip Cancellation Waiver does not cover any single supplement charges due to an individual's traveling companion canceling prior to departure.** The Trip Cancellation Waiver is non-transferable and valid for each applicant only. The Trip Cancellation Waiver does not cover any services such as airline tickets not purchased through PWD/CE. Cancellations, Refunds & Inquiries under Part A will be handled by PWD/CE. Certain Exclusions and Restrictions apply.**Part B – Post Departure Travel Protection Plan\* provided by USI**

Includes coverage for: Trip Interruption (\$1,000); Trip Delay (\$100/Day-Max \$500); Baggage &amp; Personal Effects (\$2,000); Baggage Delay (\$500); Emergency Accident/Sickness Medical Expense- excess coverage (\$30,000); Emergency Evacuation/Repatriation (\$150,000); Accidental Death &amp; Dismemberment (\$25,000); Non-Insurance and Emergency Travel Assistance Services\*\* (24/7). Claims &amp; Inquiries under Part B will be administered by USI.

**For full Part A and Part B plan details visit: [premierworlddiscovery.com/TPP](http://premierworlddiscovery.com/TPP)**

All Benefits described on this page are for general information basis only. There are certain restrictions, exclusions and limitation that apply to all insurance coverages. Plan benefits, limits and provisions may vary by state jurisdiction.

**CANCELLATION FEES**

Cancellations are subject to the following per person fees;

- Cancel 180 days prior to departure: \$200 pp is retained
- Cancel 179-90 days prior to departure: Deposit or TPP\*\* is retained
- Cancel 89-60 days prior to departure: 50% of total price
- Cancel 59-30 days prior to departure: 75% of total price
- Cancel 29 days or less prior to departure/no shows: No refunds

**\*\*If TPP purchased****RESPONSIBILITY**

Premier World Tours LLC dba Chamber Explorations (hereafter PWD/CE), whose vouchers are used by respective agents for the passenger in all matters pertaining to hotel accommodations, sightseeing tours and transportation, hold themselves free of responsibility for any damages occasioned from any cause whatsoever. PWD/CE will not be responsible for any damages or inconvenience caused by late arrivals, departures and change of schedule or other conditions nor will they be responsible for any act, omission, or event during the time the passenger is not on board their conveyance. The passage contract in use by the airline concerned, when issued, shall constitute the sole contract between the airline and the purchaser of this tour/cruise, and/or passenger. PWD/CE does not hold any responsibility for the conduct of any of its members, hotel, motorcoach, cruise line, train, airline or other personnel. PWD/CE reserves the right to decline to accept or retain any person as a member of a tour/cruise at its discretion. PWD/CE &amp;/or its Tour Director retain the right to require any participant to withdraw from a tour/cruise at any time, if determined to be in the best interests of health, safety &amp; general welfare of the tour/cruise group or of the individual participant. Arbitration- I/We agree, any and all disputes concerning this contract or any other material concerning the trip, or the trip itself must be resolved exclusively pursuant to binding arbitration in the state of California, pursuant to the then current rules of the American Arbitration Association. Payment of the deposit for this tour/cruise constitutes acceptance of these terms and conditions. CST #2048841-40

**IMPORTANT CONDITIONS/NOTES**

- A valid US passport is required for this tour and is the responsibility of each passenger. Passports should be valid for up to six (6) months beyond the travel dates. All names must be submitted to Premier exactly as they appear on passenger passports.

- Itinerary and hotels are subject to change.

**AIR NOTE**

Air Schedules may not be available until Final Trip Documentation is received. Air seats are assigned by the airline and sometimes not assigned until the day of travel. Air seat changes can only be attempted upon receipt of e-tickets and Final Trip Documentation at which time availability may be limited. If specific seat assignments or airline choice is extremely important to your reservation, we recommend you book land only and make your own air reservations. Please make this adjustment to land only/own air at time of tour reservation.

