

- Industrial
- Commercial
- Office
- Land
- Business

1000 N. Rand Road (Route 12)
Units 223/224
Wauconda, IL 60084

FOR SALE

2 Combined Industrial Condos (divisible) Manufacturing Use 1,800 - 3,600 SF

OWNER SAYS SELL ! 3,600 SF combined but divisible to 1,800 each. Units have heavy power, 480V, 3 Phase 600 & 800 amp services with buss bar for easy access. Air lines throughout units. 4" incoming gas line. One unit has small office and 2 restrooms, 2nd unit has roughed in restrooms. Floor drains exist but are closed off for their business, yet easy access. External docks for tenant use in rear. Contact Joe H. today for details or to schedule a showing. Visit Premier Commercial Realty website to see more listings.

PROPERTY SPECIFICATIONS

Description:	Industrial Condos
Land Size:	Condo
Year Built:	1985
HVAC System:	Electric Heat - Ceiling Units A/C
Electric:	480V , 600 & 800 amp Services
Sprinklered:	No
Washrooms:	2 + 2 (roughed in)
Floor Drains:	Yes - Currently Closed
Ceiling Height:	11'
Drive In Doors:	(2) 10x10
Truck Docks:	Exterior - Shared
Parking:	8 (Common)
Sewer: City	Water: City
Zoning:	LI
Real Estate Taxes: 2016	\$3,713.64 / \$3,713.75 Total \$7,427.40
Association Dues:	\$300/mo. (for both units) Water, Landscape, Snow
NEW PRICE:	\$216,000 (\$60. PSF) \$185,000 (\$51.39 PSF)

PRICED TO SELL !



MLS: 09632799

Demographics	1 mile	3 miles	5 miles
Avg. HH Income	\$85,636	\$103,910	\$117,082
Population	1,786	27,694	69,450

TRAFFIC COUNTS:
25,400 Vehicles per Day on Rand Road (Route 12)



Directions: Route 176 to Route 12 (Rand Road), North 1 Mile to Building.

PIN: 09-23-300-181, 182

February 14, 2018

No warranty or representation is made as to the accuracy of the foregoing information. Terms of sale or lease and availability are subject to change or withdrawal without notice. This document is for information purposes only. No offer of sub-agency is being made.

[CLICK HERE](#)
TO VISIT OUR WEBSITE

www.PremierCommercialRealty.com

9225 S. IL Route 31
Lake in the Hills, IL 60156
Office: 847-854-2300
Fax: 847-854-2380

Joe Heffernan
Office: 847-854-2300 Ext. 18
Cell: 847-302-5550
JoeH@PremierCommercialRealty.com

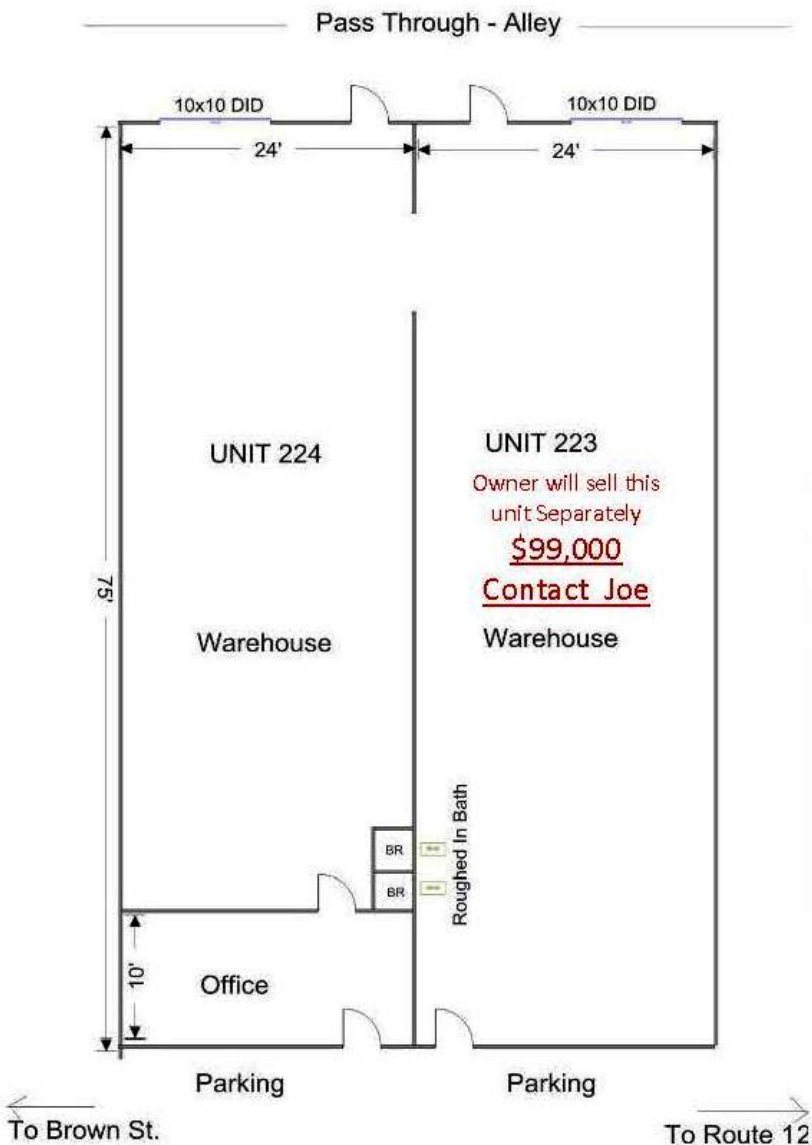

Exterior Dock Shared by Entire Complex

