

Welcome to

Cabot Citrus Farms

Coming in 2023

EPIC Meeting



CABOT

Coastal Engineering
Planning
Surveying
Environmental
Transportation
Construction Management
engineering associates, inc.

Village Core

A Walkable Village nestled within three distinct golf experiences is anchored on each end by amenity hubs.

- Clubhouse
 - Restaurant & Lounge
 - Tavern Bar & Game Room
 - Pro Shop & Locker Rooms
 - Club Accommodations
- The Village
 - Casual, Outdoor Dining
 - Fitness & Game Deck
 - Spa & Therapy Gardens
 - Bowling & Pool Bar
 - Specialty Retail
 - Racquet Sports

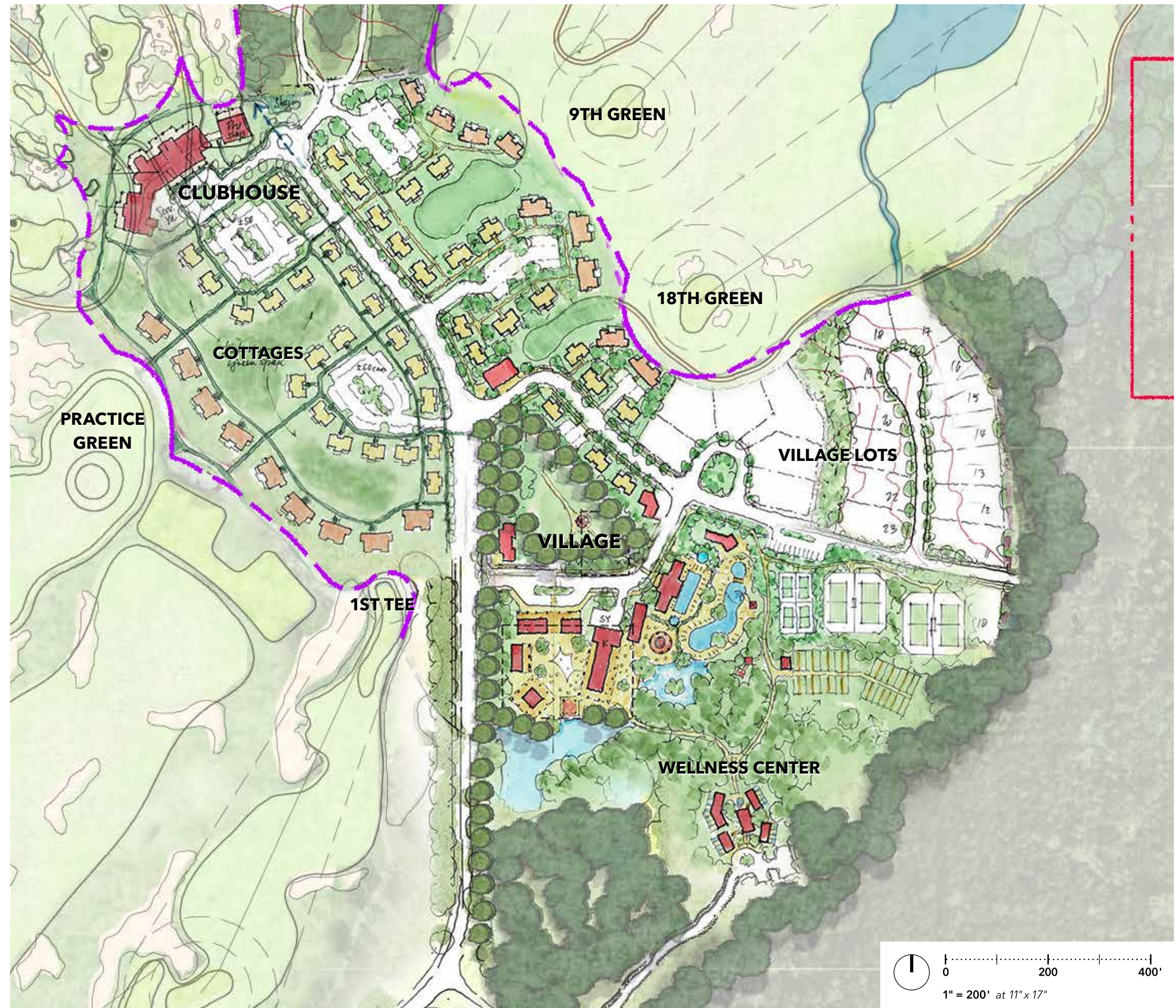



Parcel Key No's

- 00327337
- 00327300
- 00327934
- 01227719
- 00327569
- 00327952
- 00327685
- 01353911
- 00328096



LOCATION

THE CABOT CITRUS FARMS PROPERTY CONSISTS OF THE WESTERN 1,185 ACRES OF THE WORLD WOODS PLANNED DEVELOPMENT DISTRICT LOCATED IN NORTHWESTERN HERNANDO COUNTY (SECTIONS 1, 2, 3, 10, 11, 12, 13 & 14, TOWNSHIP 21 SOUTH, RANGE 18 EAST AND SECTION 7, TOWNSHIP 21 SOUTH, RANGE 19 EAST). THE SUBJECT PROPERTY IS BOUNDED ON THE NORTH BY CITRUS COUNTY, ON THE EAST BY A PORTION OF THE WITHLACOOCHEE STATE FOREST, ON THE SOUTH BY US HIGHWAY 98 AND ON THE WEST BY STATE FOREST LANDS PURCHASED IN PART FOR EXTENSION OF THE SUNCOAST PARKWAY.