

Rosecrans Ave/ Marquardt Ave Grade Separation Project CONSTRUCTION NOTICE - FEBRUARY 27 - MARCH 3, 2023

Due to forecasted inclement weather, scheduled may be cancelled and will be rescheduled.

CONSTRUCTION ACTIVITIES

LOCATION	ACTIVITIES
Marquardt Ave	<ul style="list-style-type: none"> Continue the bridge structure piles.
Rosecrans Ave	<ul style="list-style-type: none"> Pour concrete in the sidewalks. Continue removing asphalt, clearing and grubbing.
Fenced Areas	<ul style="list-style-type: none"> Continue to install falsework and rebar for the bridge structure abutment. Continue constructing the retaining wall.

ROADWAY RESTRICTIONS AND OVERNIGHT LANE CLOSURES

LOCATION	CLOSURES	DATE	TIME
Marquardt Ave between Rosecrans Ave & Milroy Pl	<ul style="list-style-type: none"> All lanes are closed. Follow the detour. 	<ul style="list-style-type: none"> Ongoing-Jun. 2023 	<ul style="list-style-type: none"> 24/7
Stage Rd between Rosecrans Ave and South of Iseli Rd	<ul style="list-style-type: none"> All lanes will be closed. Follow the detour. 	<ul style="list-style-type: none"> Ongoing-Jun. 2023 	<ul style="list-style-type: none"> 24/7
New Traffic Pattern on Eastbound Rosecrans Ave between Coyote Creek and the Railroad	<ul style="list-style-type: none"> One lane will be closed. Straight and left-turn movements will be opened. 	<ul style="list-style-type: none"> Ongoing 	<ul style="list-style-type: none"> 24/7

ACCESS	CLOSURES
Sidewalk	<ul style="list-style-type: none"> Sidewalk access will remain open. Signs will be posted if the sidewalk is closed.
Emergency Responders	<ul style="list-style-type: none"> Access will be maintained.
Businesses	<ul style="list-style-type: none"> Driveway access will be maintained.

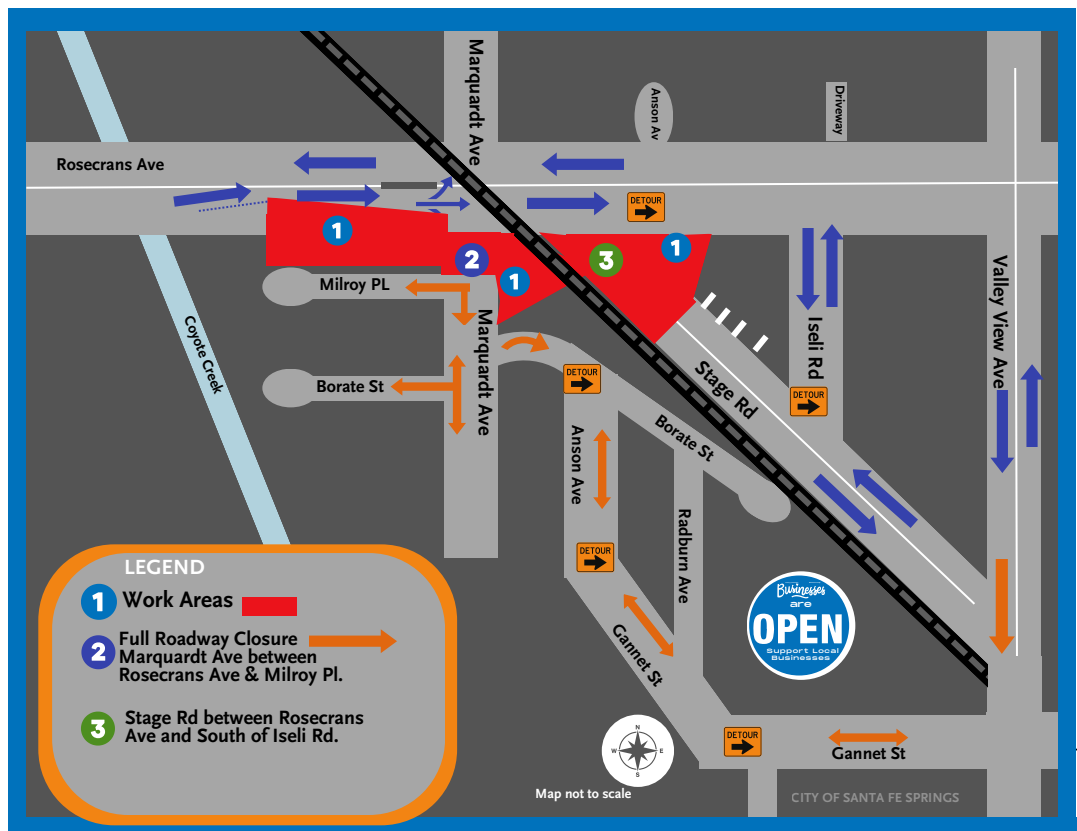

Rosecrans Ave/
Marquardt Ave
Grade Separation
Project

STAY CONNECTED.
STAY INFORMED

Helpline
562-206-7879

Text to Sign Up
to receive EMAIL
UPDATES

Text
METROROSEMARQ
to 22828.

Website
metro.net/projects
Under "Less Traffic"

Email
BarrientosV
@metro.net

Work Hours

Day
Monday-Friday
6:30 am - 4 pm

Day Lane Closures
Monday-Friday
9am-3:30pm

Night Structures
Monday-Saturday
8 pm - 8 am

Night Lane Closures
Monday - Friday
8 pm-6 am

Weather permitting.

SAFETY is priority.
Expect to hear noise,
see large equipment,
and water trucks will
be used to maintain
dust control during
construction working
hours.