

Rosecrans Ave/ Marquardt Ave Grade Separation Project
CONSTRUCTION NOTICE - JANUARY 16-22, 2023



Due to the forecasted weather and onsite conditions after the rain, majority of the construction activities cannot continue and will be rescheduled. If the weather and onsite conditions permit, the contractor will continue the work below.

CONSTRUCTION ACTIVITIES

LOCATION	ACTIVITIES
Marquardt Ave	<ul style="list-style-type: none"> Mobilize equipment for the bridge bent structure.
Rosecrans Ave at Iseli Rd	<ul style="list-style-type: none"> Continue to compact, place concrete for curb and gutter for the new traffic signal intersection. Prepare the roadway to start construction for the new bus pad.
Areas (3) within construction fencing.	<ul style="list-style-type: none"> Continue constructing the retaining wall. Continue to unload column rebar and build cages for bridge structure abutments.

ROADWAY RESTRICTIONS

LOCATION	CLOSURES	TIME/HOURS
Marquardt Ave between Rosecrans Ave & Milroy Pl	<ul style="list-style-type: none"> All lanes will be closed. Follow the detour. 	<ul style="list-style-type: none"> January 9 - March
Lane Closures on Rosecrans Ave and Iseli Rd	<ul style="list-style-type: none"> Curb ramps and one lane is closed in each direction. One lane will be open in each direction. 	<ul style="list-style-type: none"> Ongoing - February
Upcoming Full Closure Stage Rd between Rosecrans Ave and South of Iseli Rd	<ul style="list-style-type: none"> A separate construction notice with a closure details will be provided. All business driveways will remain open. 	<ul style="list-style-type: none"> January 30- June

NIGHT WORK AND ROADWAY RESTRICTIONS

NIGHT WORK	WORK/CLOSURES	TIME/HOURS
Intersection of Marquardt Ave and Rosecrans Ave	<ul style="list-style-type: none"> Install temporary traffic signal. Closed/Open: One lane in each direction on Rosecrans Ave. Flaggers will be on site to direct traffic. 	<ul style="list-style-type: none"> January 19 6:30 pm - 4 a.m.

ACCESS STATUS

ACCESS LOCATION	CLOSURES
Sidewalks within the project limits	<ul style="list-style-type: none"> Sidewalk access will be open. Signs will be posted if the sidewalk are closed.
Emergency Responders	<ul style="list-style-type: none"> Access will be maintained.
Businesses	<ul style="list-style-type: none"> Driveway access will be maintained.

SAFETY is priority. Project cones and traffic control devices will be placed. Expect to hear noise, see large equipment, and water trucks will be used to maintain dust control during construction working hours.

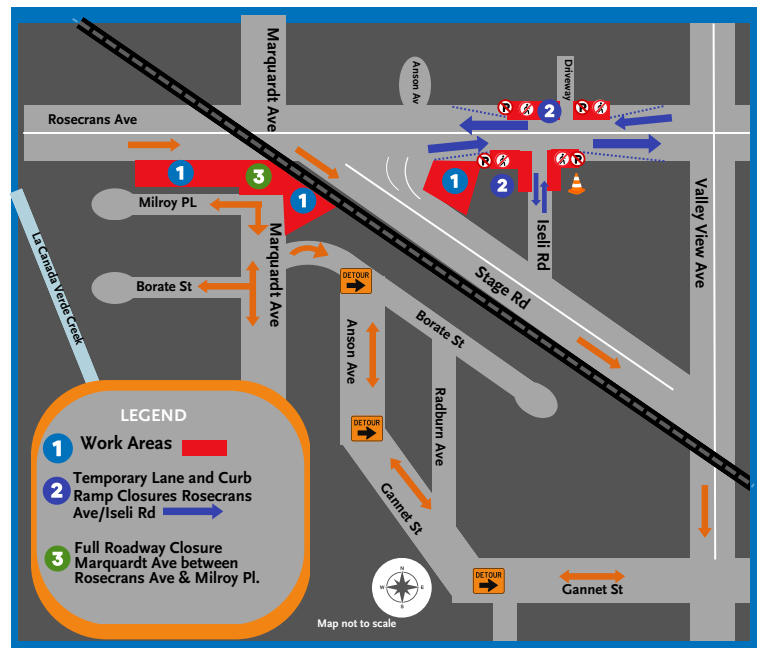

**Rosecrans Ave/
Marquardt Ave
Grade Separation
Project**

**STAY CONNECTED.
STAY INFORMED**

Helpline
562-206-7879

*

Text to Sign Up
to receive EMAIL
UPDATES

Text
METROROSEMARQ
to 22828.

*

Website
metro.net/projects
Under "Less Traffic"

*

Email
BarrientosV
@metro.net

*

Work Hours
Monday – Friday
6:30 am – 4 pm

Sunday - Friday
8 pm - 8 am

Weather permitting.