

Community member,

As you likely already know, Stepping Stones of Dunn County is working to bring a new emergency shelter to our area. There are striking service statistics on the back of this mailing, which speak to the pressing need for assistance for individuals facing homelessness in your community. We have a solid plan, a great location, and most of the resources necessary to help meet this need with a new facility.

In collaboration with the City of Menomonie, we secured a Neighborhood Investment Fund grant to cover the estimated cost of the project. As plans were finalized and the construction market came into more focus, however, it has become clear that the budget prepared more than a year ago will not be enough to make an operational facility a reality.

While the grant funding that we have secured can still cover construction costs, **we need your contribution to help us raise \$255,000** for items that are now beyond the scope of the grant. This includes furnishings, equipment, supplies, and other services and contingencies that are necessary for any emergency shelter to open its doors to people in need.

Our goal is to raise these funds **by August 1, 2023**. I want to be clear that Stepping Stones will make sure that the emergency shelter gets built. I also want to acknowledge a plain truth, though. This truth is that our organization exists only as a place where the community comes together to take care of its own. As is always the case, we need your help to help your neighbors.

In addition to your continued support for our programs, please contribute—today and/or through your pledge—to this one-time campaign for this necessary shelter.

With Gratitude,

Padraig Gallagher
Executive Director—Stepping Stones of Dunn County

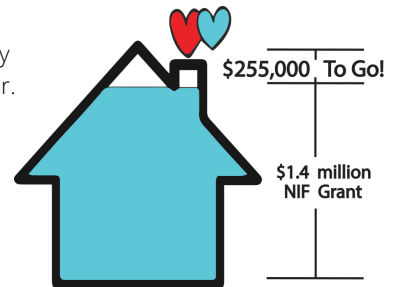

WAYS TO GIVE

CHECK OR ONLINE GIVING

Donations can be made by check or online. Please fill out and include the enclosed card for mailing. For online donations, go to www.steppingstonesdc.org, and click the "DONATE" button on the homepage. In the memo, comment "New Shelter Fund".

PLEDGE GIVING

Want to donate but spread out the length of the campaign? Through our "DONATE" button on our website, you can set up reoccurring monthly payments toward the shelter, pledging an amount that works for your budget. This can also be done by check -- just fill out the attached card with the total pledge amount, and we will contact you to set up a payment schedule.

INDIVIDUAL RETIREMENT ACCOUNT

Money from your Individual Retirement Accounts (IRAs) can be donated to our campaign. This is most beneficial if you have reached an age where you need to make required minimum distributions (RMDs). To ensure your donations meet IRS rules, please work with your financial advisor.

CHAMPIONS | \$50,000

BUILDERS | \$25,000

AMBASSADORS | \$10,000

ADVOCATES | \$5,000

FRIENDS | \$1,000

DONORS | \$100

Stepping Stones of Dunn County is a nonprofit 501(c)(3) tax-exempt charitable organization.

In 2021, our shelter program:

♥ Provided **9,279** total shelter nights ♥ Sheltered **71** children

♥ Sheltered **157** households ♥ Had an average stay of **32** nights

For every household receiving shelter, there were **two** waitlisted

Of the **9,279** total shelter nights:

7,420 were to residents of Dunn County (80%)

Equivalent to 1-in-6 Dunn County residents staying one night in our shelter.

5,344 were to residents of Menomonie (58%)

Equivalent to 1-in-3 Menomonie residents staying one night in our shelter.



Emergency Shelter Features



20-bed shelter facility for individual adults



Client laundry room and secure storage

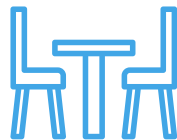

Community and dining area



Staffed 24 hours a day

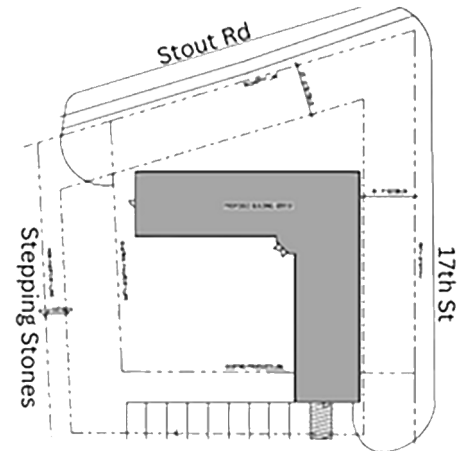

Community resource office



Designated ADA rooms to reduce barriers



Centrally located and accessible



Common areas visible from a central staff desk



Communal commercial kitchen

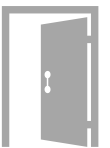

Single-bed rooms with private bathrooms