

# MOBILE COVID-19 TESTING INDOOR EVENTS

## Event Layout

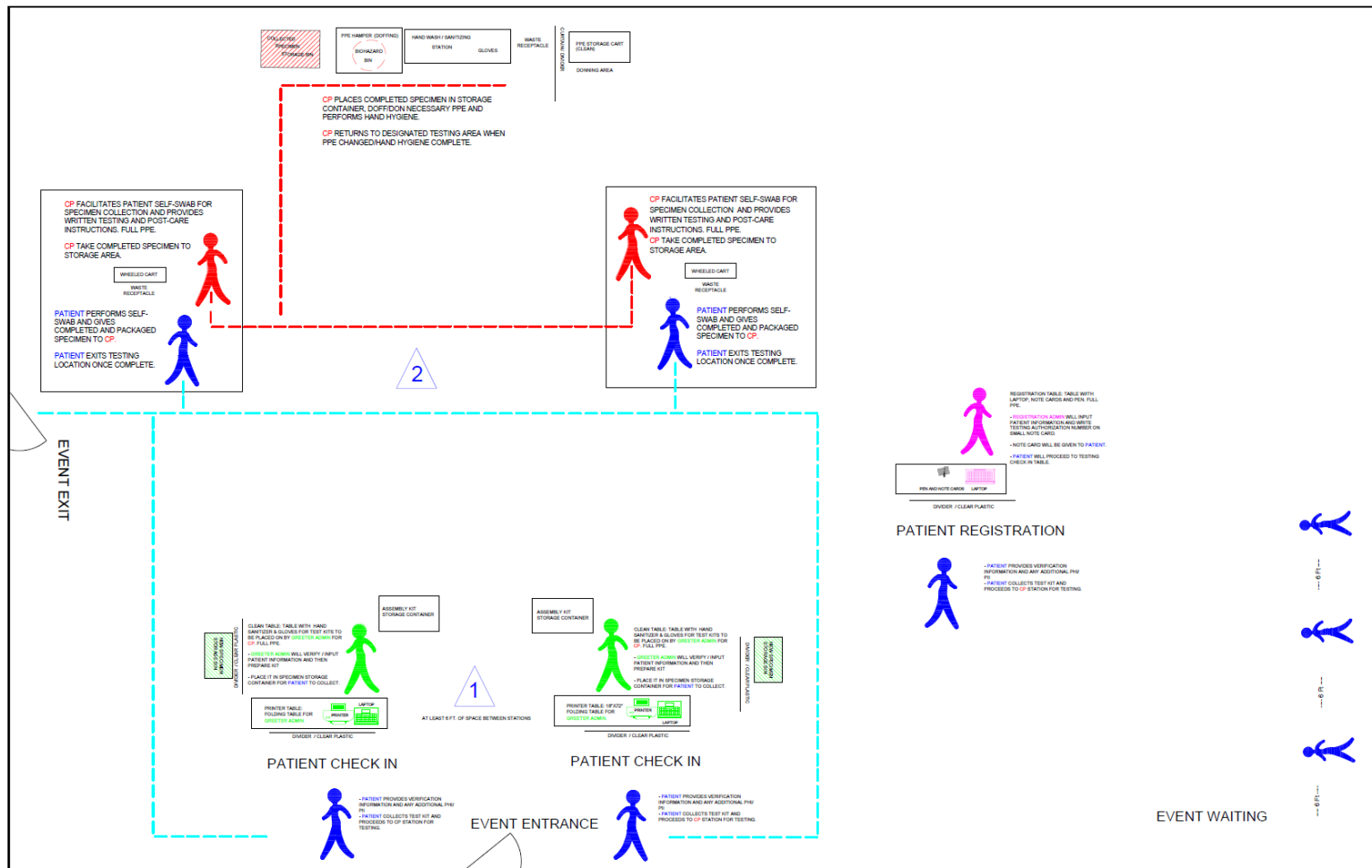

Large Interior Room/Gymnasium 1

## Space Requirements

Building capable of providing the the below requirements for space and logistical needs:

- Secure facility to ensure safety of event equipment and supplies; event room or building must be locked nightly and have established access controls.
- Electrically throughout to support event equipment (e.g.; laptops, printers, etc.)
- Temperature controls (heat or cooling)
- Interior room large enough to accommodate the required stations with at least two exits (note: exits should be on separate walls as illustrated above).
  - Check In Stations – approximately 12x12ft each, spaced at least 6ft from any other station.
  - Clinical Testing Stations – approximately 12x12ft each, spaced at least 10ft from any other station.
  - Specimen Storage – approximately 4x4ft, spaced at least 8ft from any other station.
  - Personal Protective Equipment (PPE) Donning/Doffing Station – approximately 12x8ft to ensure ample separation between doffing and donning.

Note: If a large open space is not available, the event can be coordinated between multiple private rooms or offices.

- Private bathrooms for event staff with running water.
- Waiting area for attendees that allows at least 6ft of separation between each individual (on all sides) outside of the main event location; attendees will enter individuals as prompted by event staff.
- Plenty of parking for event attendees with designated parking for event staff.