

2705
Via Orange Way
SPRING VALLEY, CA 91978

CHURCH SPACE OPPORTUNITY



AVAILABLE FOR SHARED USE

VALLEY COLEMAN

Sales & Leasing Associate
Valley@PacificCoastCommercial.com
Lic. 02065336

KURT KERNER

Sales & Leasing Associate
Kurt@PacificCoastCommercial.com
Lic. 02099773

OFFICE (619) 469-3600

10721 Treena St., Suite 200
San Diego, CA 92109
Lic. 01209930



The information contained herein has been given to us by the owner of the property or other sources we deem reliable, we have no reason to doubt its accuracy, but we do not guarantee it. All information including zoning, financials, leases, square footage, permits and use should be verified during due diligence and prior to completing a lease.

2705

Via Orange Way

PROPERTY FEATURES



SUITE A

±18,589 SF Fully Equipped Church
Shared Use with Non-Competing Church



PARKING

Ample Parking Access to Entire Lot After Hours & Weekends



TENANT IMPROVEMENTS

Recent Improvements and Remodeling Completed



FREEWAY ACCESS

Easy Access to the 54 and 94 Freeways
Time to CA-54 (2 Mins), CA-94 (5 Mins)



HIGHLIGHTS

Café and Lounge Area
Auditorium (Capacity 400) and Raised Stage
State of the Art Equipment \$150,000
Onsite Audio / Visual Technician
Including Online Streaming Access Equipment



ASKING RATE

Church - Negotiable



2705

Via Orange Way
FLOOR PLAN

AVAILABILITY

Suite A: ±18,589 SF Fully Equipped Church

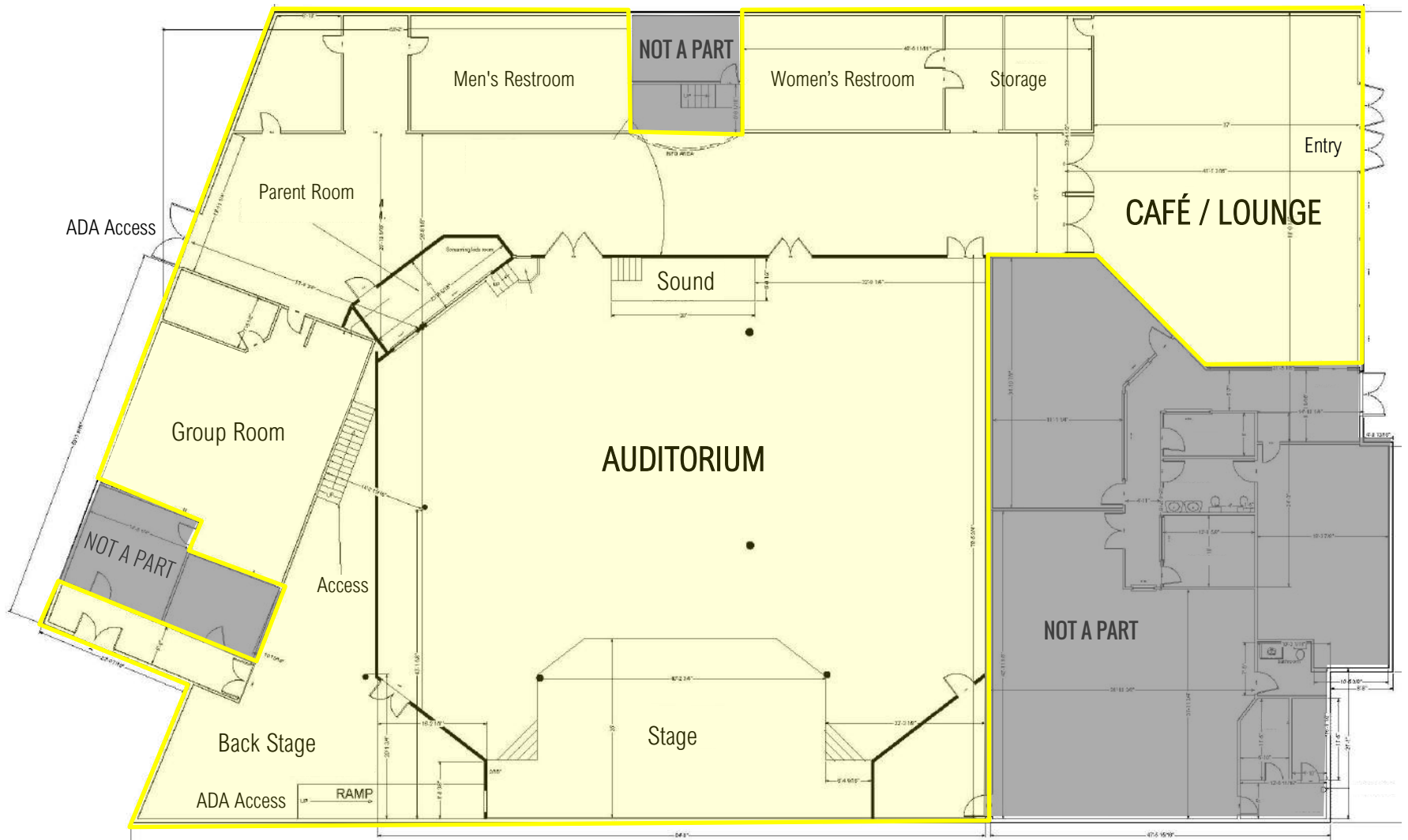

Floor Plan Is Not To Scale; For Reference Purposes Only.

2705

Via Orange Way
MAP

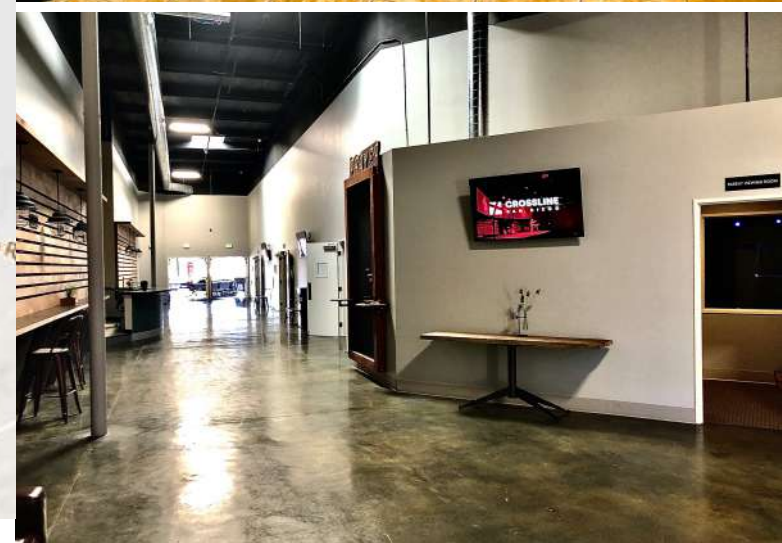
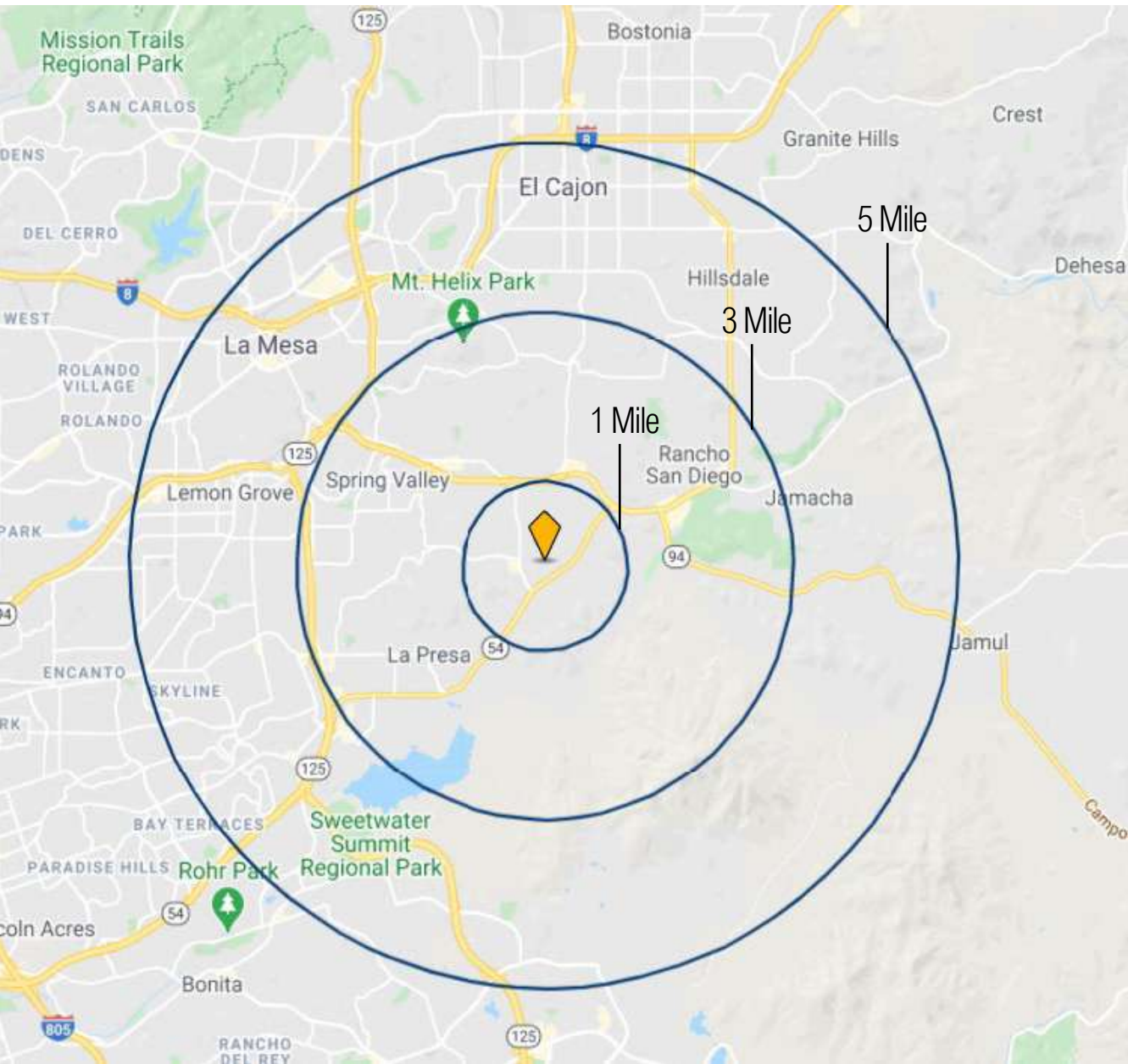

2705

Via Orange Way
SITE PLAN

CHURCH SPACE OPPORTUNITY AVAILABLE FOR SHARED USE

