



# Amazon Sidewalk

## How to Turn Off And On In 6 Steps



Mildred M. Tassone

## Table Of Contents

<b>Overview</b>	<b>2</b>
<b>1. Open Alexa App On Your Phone</b>	<b>2</b>
<b>2. Go Main Screen, Lower Right And Click More</b>	<b>3</b>
<b>3. Go Settings And Click Settings</b>	<b>4</b>
<b>4. Go Account Settings And Click Account Settings</b>	<b>5</b>
<b>5. Go Amazon Sidewalk And Click Amazon Sidewalk</b>	<b>6</b>
<b>6. On The Amazon Sidewalk Screen Click Button To Move It To The Left</b>	<b>7</b>

## Overview

You can turn the Amazon Sidewalk off in several easy steps. You can also turn it back on at any time.

### 1. Open Alexa App On Your Phone

**Note:** You will only be able to see the Sidewalk option you have a compatible Echo-enabled device.

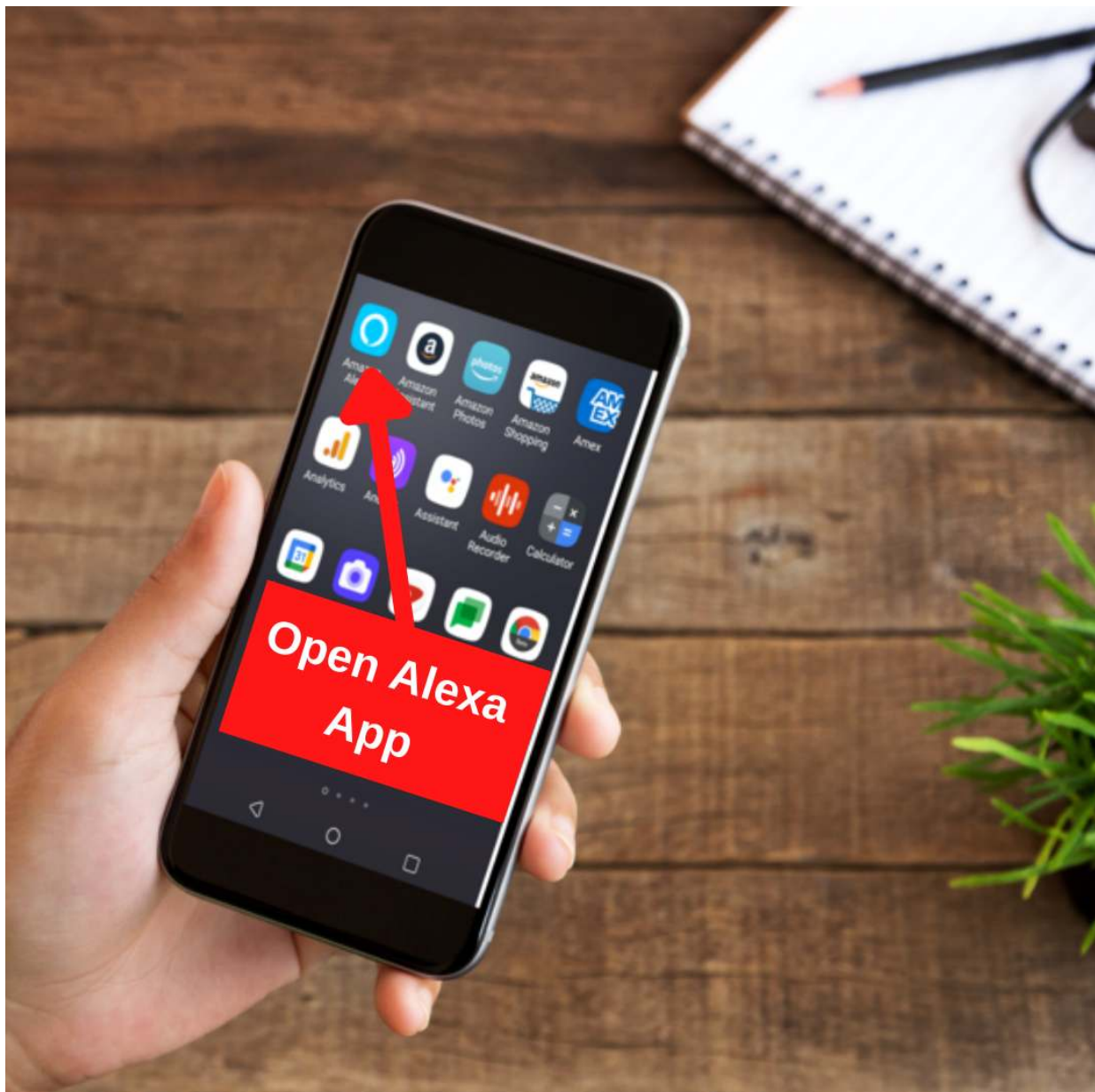



## 2. Go Main Screen, Lower Right And Click More

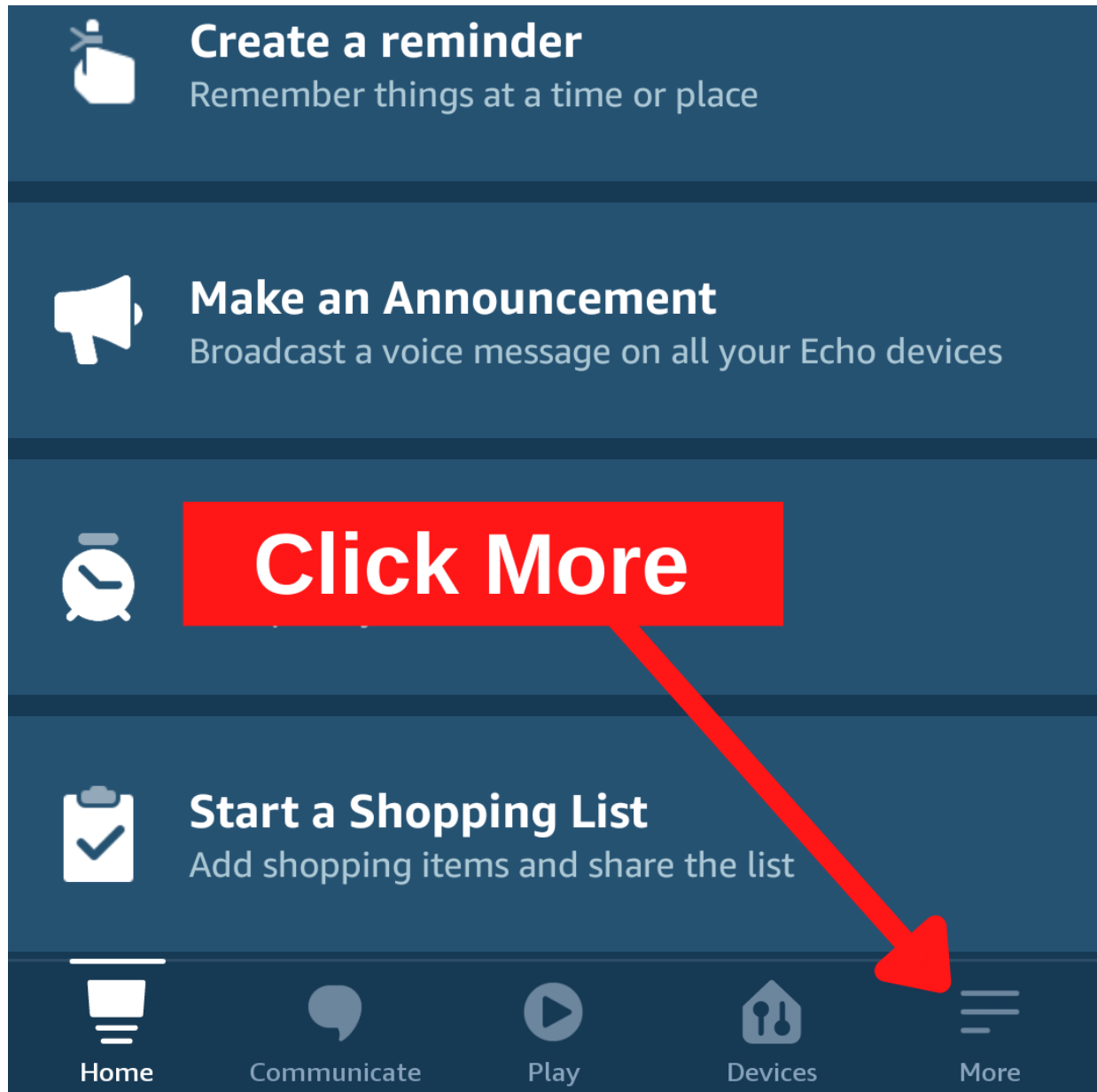

### 3. Go Settings And Click Settings

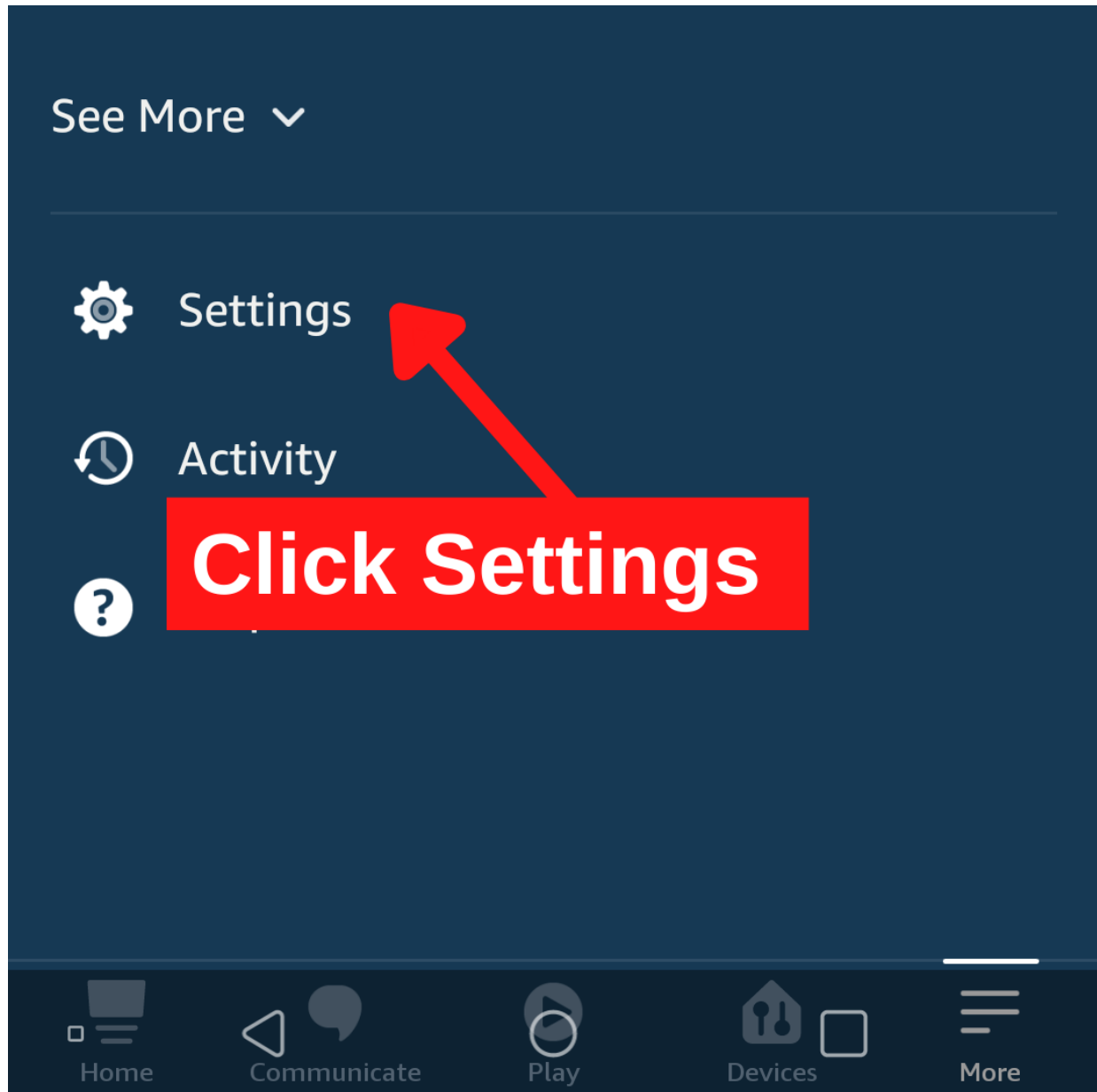

#### 4. Go Account Settings And Click Account Settings

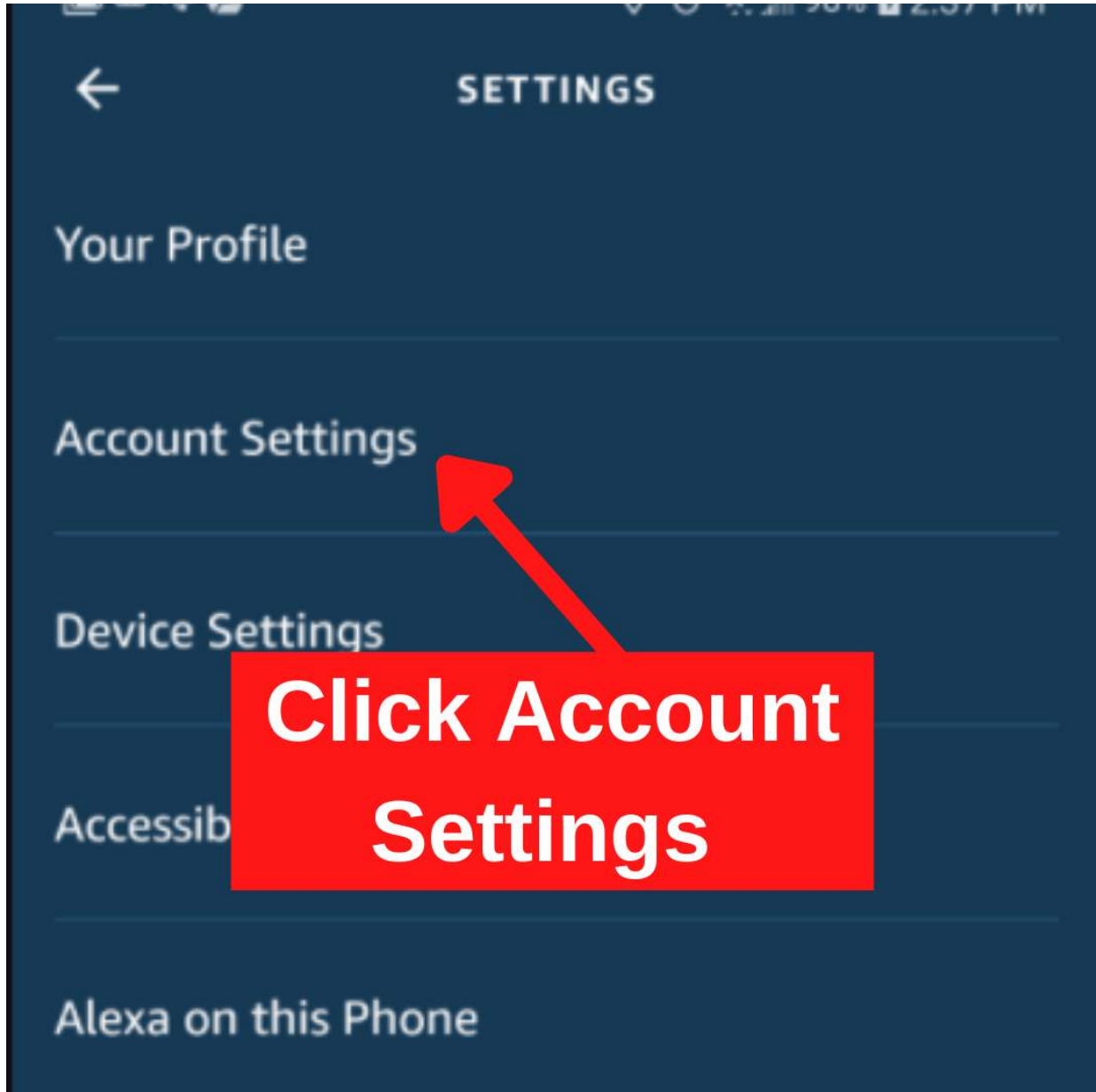

## 5. Go Amazon Sidewalk And Click Amazon Sidewalk

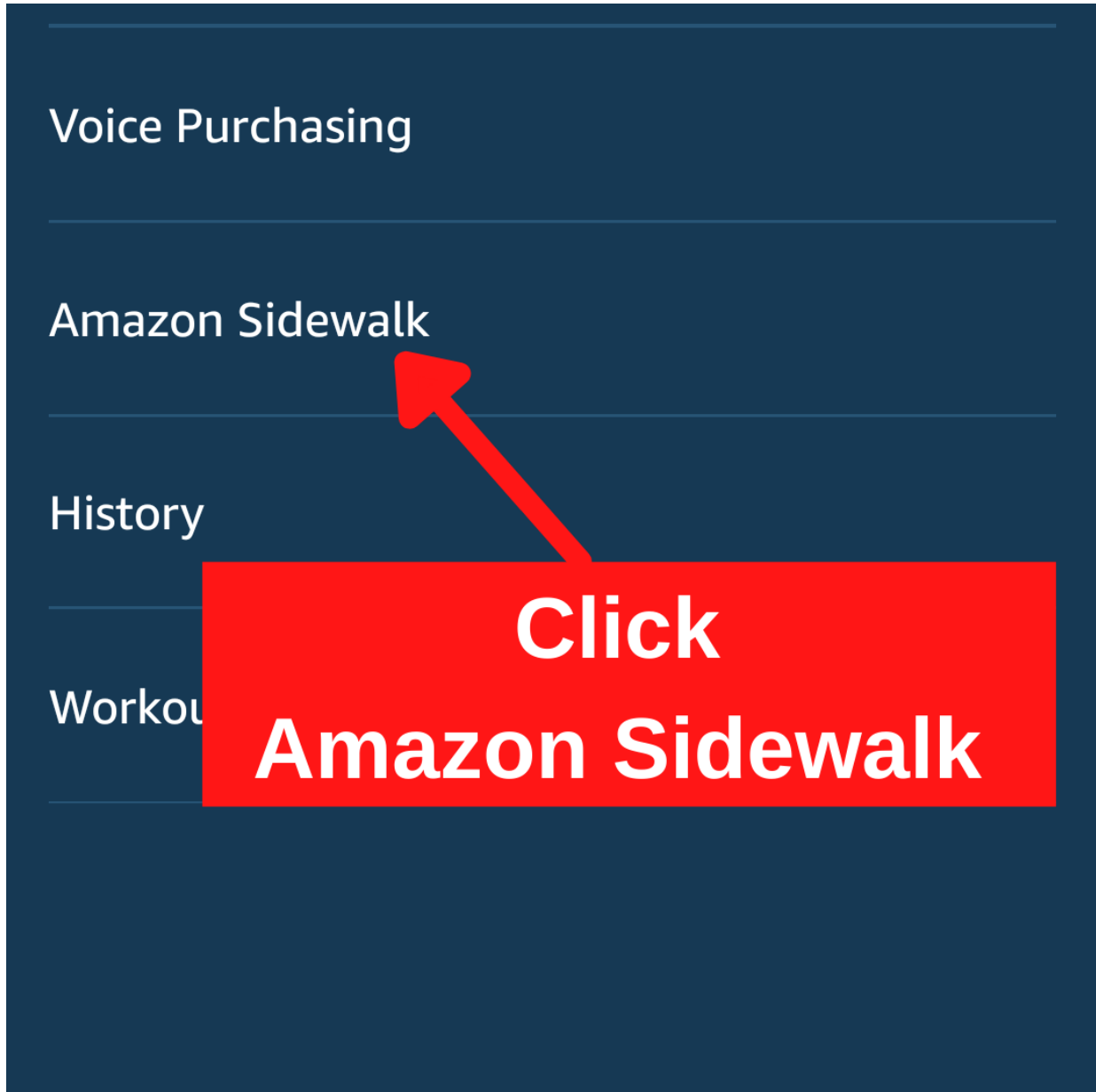

## 6. On The Amazon Sidewalk Screen Click Button To Move It To The Left

This will disable the Sidewalk option.

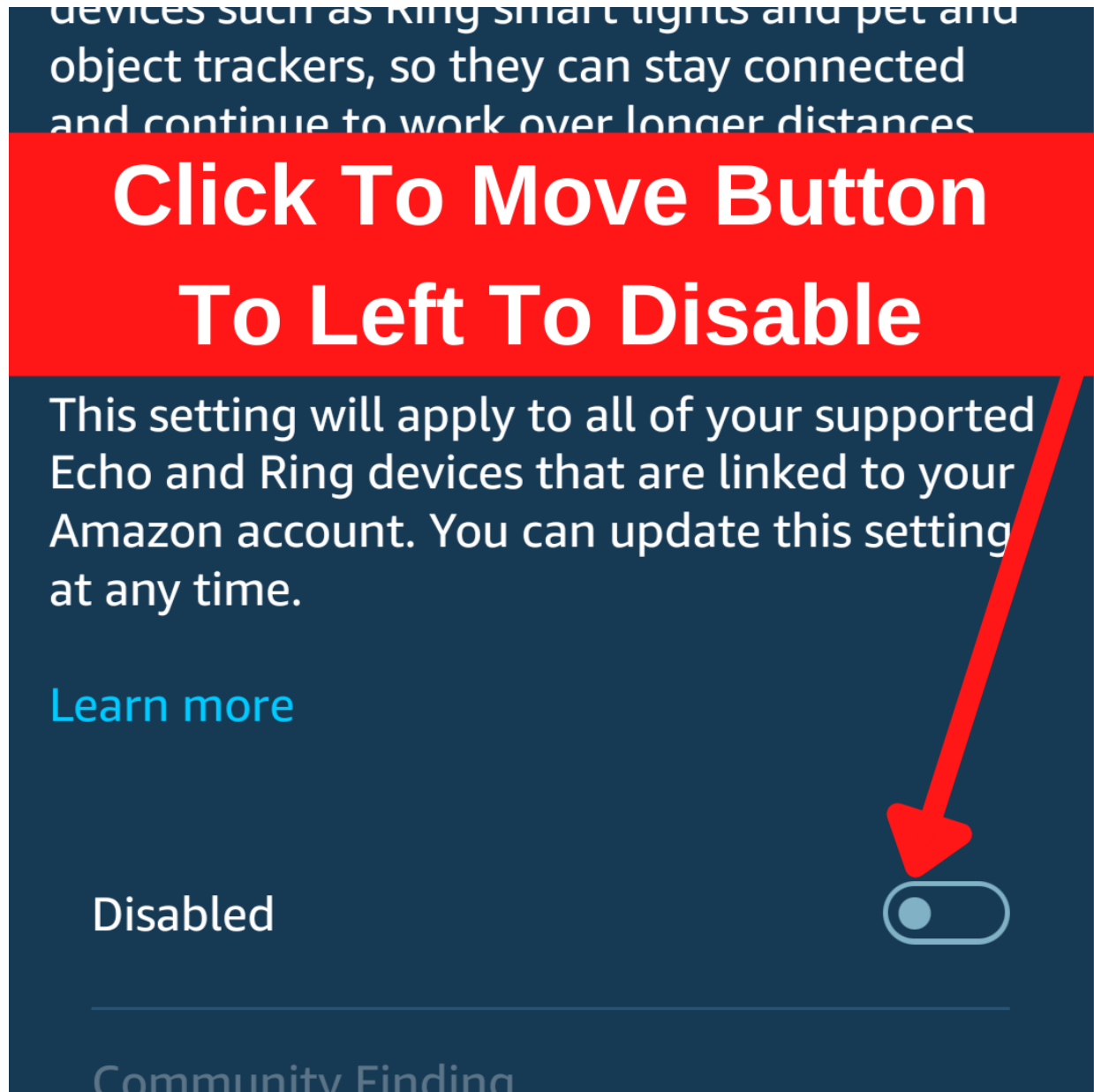



# Amazon Sidewalk

## How to Turn Off And On In 6 Steps

