

**St. John's Evangelical Lutheran Church
Columbarium Purchase Application
(Complete a separate application for each columbarium niche required)**

Purchaser(s):

Last Name		Last Name	
First Name		First Name	
Middle Name		Middle Name	
Maiden Name		Maiden Name	
Address:		Address:	
City:		City:	
State:	Zip:	State:	Zip:

Specified Next of Kin and Contingent Next of Kin:

Name:		Name:	
Address:		Address:	
City:		City:	
State:	Zip:	State:	Zip:
Phone:		Phone:	
Email:		Email:	

Columbarium Niche Size

Size	Dimensions	Selection
Small	H 5 ¾" x W 11" x D 15"	<input type="checkbox"/>
Large	H 12" x W 11" x D 15"	<input type="checkbox"/>

Eligibility

I (we) am (are) a Voting member of St. John's Lutheran Church.	<input type="checkbox"/>
I (we) am (are) not a Voting Member but was baptized and/or confirmed at St. John's Lutheran Church.	<input type="checkbox"/>
I (we) am (are) not a Voting Member but my spouse, parents, grandparents, children or siblings are interred at St. John's.	<input type="checkbox"/>

Prices

Size	Member	Other Eligible
Small	\$1,000	\$2,000
Large	\$2,000	\$4,000

My Selection

Use the selection layout map to choose and note your desired niche. Please choose three options or ask us to assign a space to you.

First Choice	Niche Number:
Second Choice	Niche Number:
Third Choice	Niche Number:

Assign Space to Me	Small <input type="checkbox"/>	Large <input type="checkbox"/>
--------------------	--------------------------------	--------------------------------

Payment

I am including my payment with the application	<input type="checkbox"/>
I would like to discuss a payment plan	<input type="checkbox"/>

Signatures

I (we) agree to abide by the Columbarium Rules, Regulations and Procedures of St. John's Church and request to purchase a space in the Columbarium, as noted above.

Applicant One	Date
Applicant Two	Date

Columbarium Sections 31 & 32 - Large Niches

Columbarium Section 31 (Right Side, Facing Church Street)

3101	3102	3103	3104	3105	3106	3107	3108
3109	3110	3111	3112	3113	3114	3115	3116
3117	3118	3119	3120	3121	3122	3123	3124
3125	3126	3127	3128	3129	3130	3131	3132
3133	3134	3135	3136	3137	3138	3139	3140

Left to Right Columns

Columbarium Section 32 (Right Side, Facing Oak Street)

3201	3202	3203	3204	3205	3206	3207	3208
3209	3210	3211	3212	3213	3214	3215	3216
3217	3218	3219	3220	3221	3222	3223	3224
3225	3226	3227	3228	3229	3230	3231	3232
3233	3234	3235	3236	3237	3238	3239	3240

Left to Right Columns

Top to Bottom Rows

Top to Bottom Rows

Columbarium Sections 33 & 34 - Small Niches

Columbarium Section 33 (Left Side, Facing Church Street)

3301	3302	3303	3304	3305	3306	3307	3308
3309	3310	3311	3312	3313	3314	3315	3316
3317	3318	3319	3320	3321	3322	3323	3324
3325	3326	3327	3328	3329	3330	3331	3332
3333	3334	3335	3336	3337	3338	3339	3340
3341	3342	3343	3344	3345	3346	3347	3348
3349	3350	3351	3352	3353	3354	3355	3356
3357	3358	3359	3360	3361	3362	3363	3364
3365	3366	3367	3368	3369	3370	3371	3372
3373	3374	3375	3376	3377	3378	3379	3380

Left to Right Columns

Columbarium Section 34 (Left Side, Facing Oak Street)

3401	3402	3403	3404	3405	3406	3407	3408
3409	3410	3411	3412	3413	3414	3415	3416
3417	3418	3419	3420	3421	3422	3423	3424
3425	3426	3427	3428	3429	3430	3431	3432
3433	3434	3435	3436	3437	3438	3439	3440
3441	3442	3443	3444	3445	3446	3447	3448
3449	3450	3451	3452	3453	3454	3455	3456
3457	3458	3459	3460	3461	3462	3463	3464
3465	3466	3467	3468	3469	3470	3471	3472
3473	3474	3475	3476	3477	3478	3479	3480

Left to Right Columns

Top to Bottom Rows

Top to Bottom Rows

Columbarium Sections 31 to 34

Oak Street

Oak Street

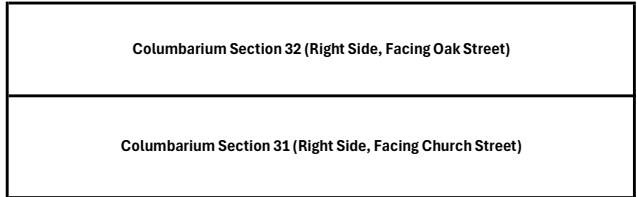
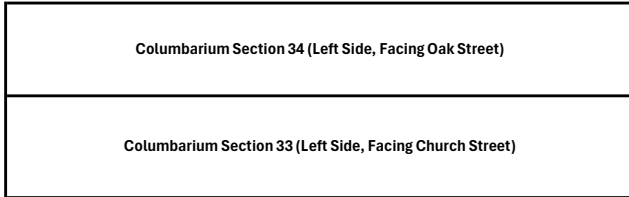

Broad Street

Cemetery Driveway

Church Street

Church Street



ST. JOHN'S

LUTHERAN CHURCH

Columbarium Rules, Regulations and Procedures

May 2026

The Columbarium of St. John's Evangelical Lutheran Church has two primary missions. One is to provide a final resting place for those eligible to purchase spaces in the cemetery. The second is to maintain and preserve the columbarium and surrounding cemetery as an attractive and dignified space in memory of all those who have already been buried, and as an extension of St. John's Evangelical Lutheran Church's Main Street facility.

GENERAL

The Columbarium is governed by the Cemetery Task Force (Cemetery Board), under the guidance of the Congregation Council of St. John's Evangelical Lutheran Church (St. John's Church).

The Cemetery Board adopted the following Columbarium Rules, Regulations and Procedures for the guidance of all.

- The purchaser of a Columbarium Niche is granted a Right of Interment Certificate (Certificate) by St. John's Church. The grantee of the Certificate is known as Certificate Holder.
- No property right of any kind is extended to a Certificate Holder. A Right of Interment is the right to place cremated human remains into the Columbarium, subject to these Rules, Regulations & Procedures, which may be amended by the Cemetery Board, from time to time without notice.
- A Certificate Holder does not have any property right in the columbarium or other physical property of the Cemetery.

- The Right of Interment shall belong to the Certificate Holder of record and the Interment Right thereunder extend to those other people entitled thereto as directed by the Certificate Holder, submitted in a written and signed request to the Cemetery Board designating a person who is eligible for interment.
- In the event of a dispute between joint holders of a Certificate as to any matter regarding the Interment Rights, the Cemetery Board shall be entitled to rely upon the most recent Certificate that was issued.
- In order to retain the religious and aesthetic unity of the Columbarium and surrounding grounds, the individual placing of flowers and other decorations is not permitted. The Cemetery Board has authority to remove all flowers, wreaths, flags and other decorative arrangements from the Columbarium area at any time.
- Following interment of cremated remains in a niche there will be provided, as part of the original fee, a standard memorial plaque, which will be placed over the niche. This memorial is the only covering permitted for the niche and will be inscribed in compliance with Columbarium lettering standards, established by the Cemetery Board.
- Inscriptions on the Columbarium niche covers shall consist of first, middle and last names per interred individual and the month day and year of birth and death. Inscriptions will be uniform in font size and spacing. The only punctuation used for names will be period. In the case of a double niche, top name will be that of the first person interred.

ELIGIBILITY TO PURCHASE

- To purchase cemetery space an individual must be a "Voting" member of St. John's Church as described in the Constitution, or have a provable relationship with St. John's Church, to include: having been a former member; having been baptized or confirmed at St. John's Church; and/or having an immediate family member interred at St. John's Church (this includes spouses, parents, siblings, children and grandparents).
- Voting members are confirmed members who during the current or preceding calendar year, shall have communed in the congregation and have made a contribution of record to this congregation. Confirmed members are baptized persons who have been confirmed by this congregation, those who have been received by adult baptism or by transfer as confirmed members from other Lutheran congregations, or baptized persons received by affirmation of faith.

PRICING

St. John's Church is committed to providing members with significantly lower interment cost options than otherwise commercially available. St. John's Church also agrees that eligible non-members should pay a purchase price closer to commercial options.

- Prices for "Voting" members of St. John's Church, is as follows:

Large Niche - \$2,000

Small Niche - \$1,000

- Prices for other eligible purchasers are as follows:

Large Niche - \$4,000

Small Niche - \$2,000

INTERMENT

- Arrangement for the interment of cremated remains must be made through the Cemetery Board, or designated Manager by contacting the St. John's Church office. Arrangements should be made sufficiently in advance of interment of ashes to permit the verification of records. No interment of cremated remains may take place without the permission of the Cemetery Board. St. John's Church and the Cemetery Board will not take possession of, or store, cremated remains prior to the interment.
- Only human cremated remains are to be interred in the columbarium. Remains must be placed in a sealed container.
- There are two niche sizes available in the Columbarium. Containers must fit within the niche so that the door locks properly. The dimensions of each size are as follows:
- Large Niche (12" high, 11 ½" wide, 15 ½" deep)
- Small Niche (5 ¾" high, 11" wide, 15 ½" deep)

SURRENDERING OR TRANSFERRING RIGHT OF INTERMENT PRIOR TO INTERMENT

- The Certificate Holder may sell or transfer their niche to another eligible purchaser. The Cemetery Board maintains the right of first refusal of purchase, in the event of a sale.
- Prior to interment, a Certificate may be surrendered.

- The Certificate Holder must advise the Cemetery Board of any changes of contact details, of both Certificate Holder and “next of kin.” Upon the death of a Certificate Holder, the “Next of Kin” will become the Certificate Holder.
- Transfers will be recognized only upon written consent of the Cemetery Board. Transfers may be refused without cause. Should a transfer be refused the Certificate is surrendered.
- Should the space appear to be abandoned and unused, and the Certificate Holder is not contactable, the Cemetery Board may consider the space as surrendered.
- A Certificate will be said to have lapsed, if the Cemetery Board cannot contact either the Certificate Holder or any listed next of kin of an unoccupied niche for a period of three (3) years. Such contact will be attempted by registered letters to the persons and addresses of record. The niche location for a lapsed Certificate will be made available for purchase to others. A lapsed Certificate is eligible for a surrender refund should the Certificate Holder or next of kin contact the Cemetery Board at a later date.
- All notices and other communications will be mailed to the Certificate Holder’s address of record. In order to change this address, the Certificate Holder or Next of Kin must send written notification to the Cemetery Board.

REMOVAL AFTER INTERMENT

- The removal of cremated remains shall be allowed only for satisfactory reasons and with the prior approval of the Cemetery Board.
- Removal of cremated remains shall have the written consent of the surviving spouse or the specified next of kin of the deceased, and any other applicable requirements of local or South Carolina Department of Environmental Control or other applicable laws or regulations. The handling and interment of cremated human remains in South Carolina, is governed by SC Code of Laws, Title 32, Chapter 8 (aka "Safe Cremation Act").
- If, in the discretion of the Cemetery Board, it becomes necessary or desirable to change the location of the Columbarium, or to discontinue use of all or part, the urns and cremated remains may be removed and placed in another suitable place. The expense of such removal shall be borne by St. John’s Church with Certificate Holders and their successors not being liable for additional costs.