



The Sea Pines Forest Preserve

"Our Natural Treasure"

Map Legend

HABITATS:

 FOREST	 FRESHWATER WETLAND
 WARNER W. PLAHS WILDFLOWER FIELD	 LAKE/POND

FACILITIES:

 LEISURE TRAIL	 VEHICULAR TRAIL
 WALKING TRAIL	 OBSERVATION DECK/DOCK
 WETLAND BOARDWALK	 PICNIC TABLES
 WATER/ RESTROOMS	 CSA ADMIN/ SECURITY

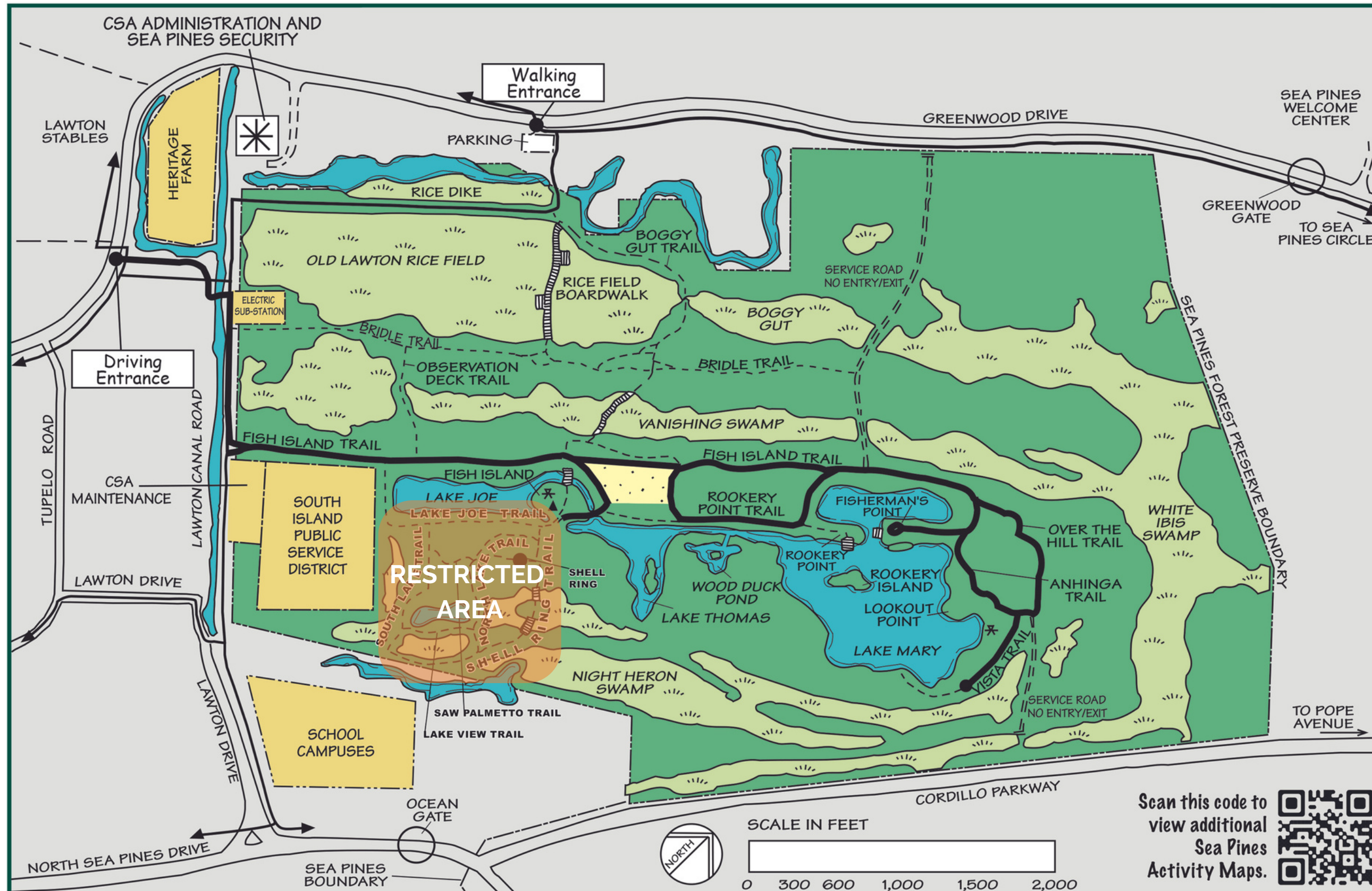

IN CASE OF EMERGENCY

For a fire or medical emergency dial 911

For all other emergencies call
Sea Pines Security @ 843-671-7170

The road / trail intersections and attractions
in the Forest Preserve are uniquely numbered.
If possible during an emergency,
describe your location by reporting
the number that is closest to you.

Scan this code to
view additional
Sea Pines
Activity Maps.

