

ST. LOUISE CARPOOL TRAFFIC REGULATIONS

Watch this video which shows how to drop-off children In the morning and pick-up In the afternoon: <https://bit.ly/36XsRwT>

GENERAL TRAFFIC REGULATIONS AT ALL TIMES

- ⇒ All vehicles travel one-way during the carpool times of 8:00-8:30 a.m. and 2:45-3:30 p.m. (1:45-2:30 on Mondays), by entering off 156th Avenue SE and exiting onto Main Street. (Note: once the school day begins at 8:30, the Main Street gates are closed.) During these specific times, ignore the directional arrows on the pavement, as school carpool traffic travels in opposite direction of the far south lane and far west lane arrows.
- ⇒ The maximum speed limit on the parish/school grounds is always 5 MPH.
- ⇒ Should it be necessary to park and leave your vehicle (such as for walking to a classroom or for volunteering in the school), please park in the following areas only:
 - In the basketball court lot north of the gym - if it isn't coned off; and not between 8:30-2:30; if you park in the basketball court, please make sure both you and your children cross to and from the school only at the designated yellow crosswalks.
 - South of the church immediately as you enter off 156th.
 - In the parking spaces alongside the soccer field - but not between 8:30-2:30.
 - On the soccer field near the BigToy - only in the afternoon and only for grade 5 & 6 families.
- ⇒ While school is in session, there should be no vehicles parked north of the orange cones and barricades, which are placed by the safety patrol from the original school's central wing to the gym immediately after the 8:30 bell. This coned-off area is kept clear for student recesses.
- ⇒ For the safety of the children, it is important that parents stress the same traffic regulations the school does. Please do not set bad examples by disobeying our driving or crosswalk regulations simply for the sake of saving a few seconds of waiting or a few extra steps of walking. A few seconds or a few steps are worth a lot in terms of the lessons taught to children and the safety it creates.

SCHOOL CARPOOL TRAFFIC PATTERN DIAGRAM

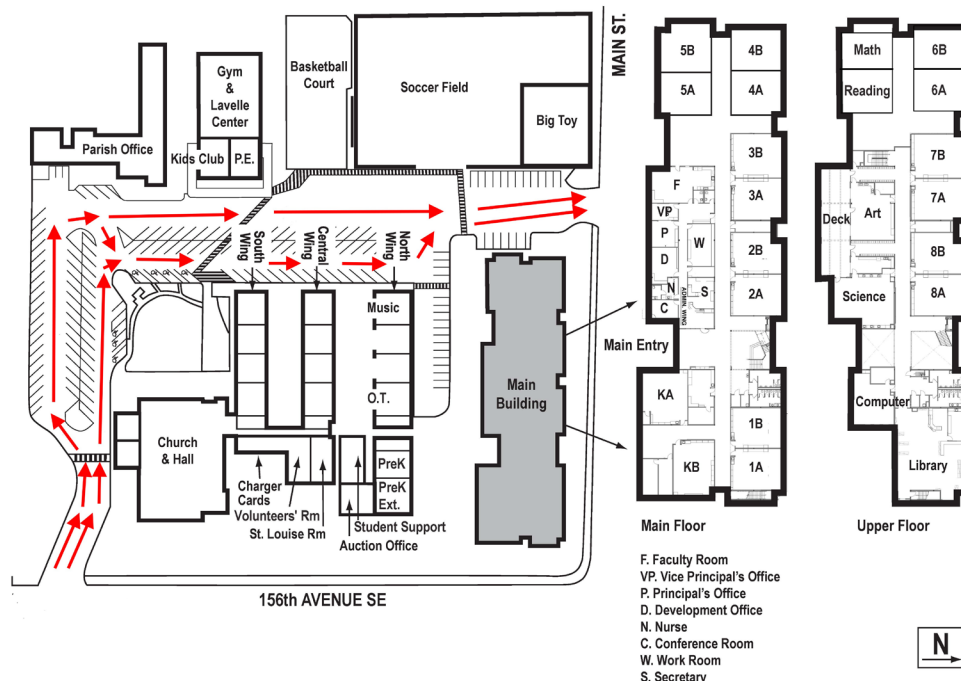

MORNING TRAFFIC REGULATIONS

1. Enter from 156th Ave. in **two** single file lines. If heading north on 156th between 8:00-8:30, turn left into the far left exit lane, driving over the far south lane's exit arrow, to help form two entrance lines.
2. Drive straight ahead, heading west toward the parish offices, and then turn right so the two lanes join to form one line heading north, parallel to the sidewalk along the original school's South, Central, and North Wings. Children are not to unload from a car on 156th Ave. or from a car in line south of the church, prior to making the turn to head north
3. The first vehicle in a new line of cars pulling forward will stop at the "fire hydrant island" directly across from the original school's North Wing, and all other cars behind this first vehicle will then stop in a single file line stretching from the North Wing down to the south lot where the two lanes first joined as one. Once you have pulled forward as far as possible and you are in this one single file line, you must unload all your children at one time. **DO NOT PULL UP AND UNLOAD A SECOND TIME JUST TO DROP A CHILD CLOSER NORTH.** This "double-stopping" causes backups.
4. If you will be leaving your vehicle and want to park, you may park in the south lot immediately upon entering off 156th, on the basketball court, or alongside the soccer field.
 - To access the basketball court or soccer field, drive north up the far west lane closest to the gym.
 - Please note that after the 8:30 entrance bell, the basketball court and soccer field are coned off for recess use, so cars may not remain parked in these areas after 8:30.
 - Family dogs are to remain secured in vehicles during the entire 30-minute carpool dropoff timeframe. As great as family dogs are, they attract children and can also be unpredictable in behavior.
5. Exit by driving forward in two lanes out the gates onto Main Street.

MORNING STUDENT SUPERVISION

1. When students are dropped-off between 8:00-8:20, they wait in their designated areas. There are four teachers and staff on supervision duty during this timeframe.
2. The entry bell rings at 8:20, and the tardy bell rings at 8:30. Parents are asked to please try and time their drop-off time to fall between 8:10 and 8:25.
3. Grade 8 students are allowed to enter the main building independently starting at 8:00 through the southwest corner door and stairs that lead directly to the 2nd floor. The 8th graders go directly to their lockers and then to their homerooms; they are not allowed to loiter in the hallway or restrooms.
4. Grade 7 students initially gather in the north courtyard of the original school building near the Music classroom. At the 8:20 bell, they leave their courtyard waiting area and enter the main building through the front doors and then up the central stairs.
5. Grade 6 students initially gather in the central courtyard of the original school building. At the 8:20 bell, they leave their courtyard waiting area and enter the main building through the southwest corner door and stairs that lead directly to the 2nd floor.

6. Grades 4 and 5 students initially gather south of the main building on the western part near the 5th grade classroom windows. At the 8:20 bell, they leave their waiting area and enter the main building through the far west door.
7. Grades 2 and 3 students initially gather south of the main building under the 2nd floor deck. Their teachers will come outside at the 8:20 bell to lead them inside.
8. Grades K and 1 students initially gather near the main building front doors. Their teachers will come outside at the 8:20 bell to lead them inside.
9. PreK students are walked by their parents to the courtyard/play area immediately outside the PreK classroom, waiting for their teacher to let them inside beginning at 8:15. PreK parents are asked to first bring their children to use the bathroom and wash their hands using the central hallway bathroom.

AFTERNOON TRAFFIC REGULATIONS

1. Enter from 156th Ave. in **two** single file lines. If heading north on 156th, turn left into the far left exit lane, over the exit arrow, to help form two entrance lines between 2:45-3:15 (1:45-2:15 on Mondays).
2. Drive straight ahead toward the parish offices in this far south lot until the two lines join to form one line heading north, parallel to the sidewalk along the South, Central, and North Wings. Wait at the beginning of this single file line for the volunteer on traffic duty to signal you to an open parking space in the central lot. Park diagonally in these central parking stalls in a north-western direction, facing the soccer field. If there is no vehicle ahead of you in the central parking stalls, pull forward to allow another vehicle to park behind you.
3. **YOU MUST REMAIN IN OR ALONGSIDE YOUR VEHICLE AT ALL TIMES, SO YOU ARE READY TO PULL FORWARD OR DEPART AT A MOMENT'S NOTICE.**
 - If you were planning on parking and leaving your vehicle, instead of parking in these central parking stalls, you will want to park in the far south lot, or on the basketball court, or alongside the soccer field.
 - Access the basketball court and soccer field by driving north up the far west lane closest to the gym.
 - Family dogs are to remain secured in vehicles during the entire 20-minute carpool pickup timeframe. As great as family dogs are, they attract children and can also be unpredictable in behavior.
4. No playing on the BigToy or soccer field is allowed until 2:18pm Mondays and 3:18pm Tuesdays-Fridays.
5. For the safety of the children, when parking in the central parking stalls, **do not back out of your stall but wait until no vehicles are parked ahead of you and then pull forward.** If you are holding up the vehicle parked behind you because your children are not yet loaded in your vehicle, you will need to pull out and park on the basketball court or exit, circle the block, and re-enter. To eliminate this possibility, please stress to your children the importance of watching for their car from the sidewalk waiting area and crossing as soon as you park.
6. Only students whose parents/carpool drivers are physically-present may be on the BigToy after school. They must walk to the BigToy with a parent while using a yellow, marked crosswalk. No children may play on the basketball court or soccer field after school.

AFTERNOON STUDENT SUPERVISION

1. Students in grade PreK-8 will wait in designated area on the sidewalk directly west of the original school's north, central, and south wings during afternoon carpool.
 - PA, 7th, and 8th graders will wait by the South Wing. The PB, 4th, 5th, and 6th graders will wait In the Central Wing, and the K-3rd graders will wait In the North Wing.
 - After cars are parked in the central parking stalls, students walk to their car using a crosswalk manned by one of the Safety Patrol crossing guards.
 - If their cars are parked on the basketball court or alongside the soccer field, students will wait for these drivers to come to them. Exit by driving forward in two lanes out the gates onto Main Street.
2. No students may play on the BigToy, soccer field, or basketball courts in the 18-minute timeframe immediately after school dismissal, when Safety Patrol students and staff are still on duty.
3. **There is no supervision on school grounds by school faculty after 3:18 (2:18 on Mondays). If not picked up in the carpool waiting area by this time, grade PK-6 students will be sent by the vice-principal or teacher on supervision duty to the school office. The secretary will help the students call their parents. If these students are not promptly picked up at the office by 3:30pm, they will be sent to Kids' Club to be supervised, and parents will be charged applicable Kids' Club fees. The fee is \$25.00/hour per child. Grade 7-8 students who have their own cell phones to contact parents may choose to remain unsupervised, waiting for parents.**