

S/Y BOOM









































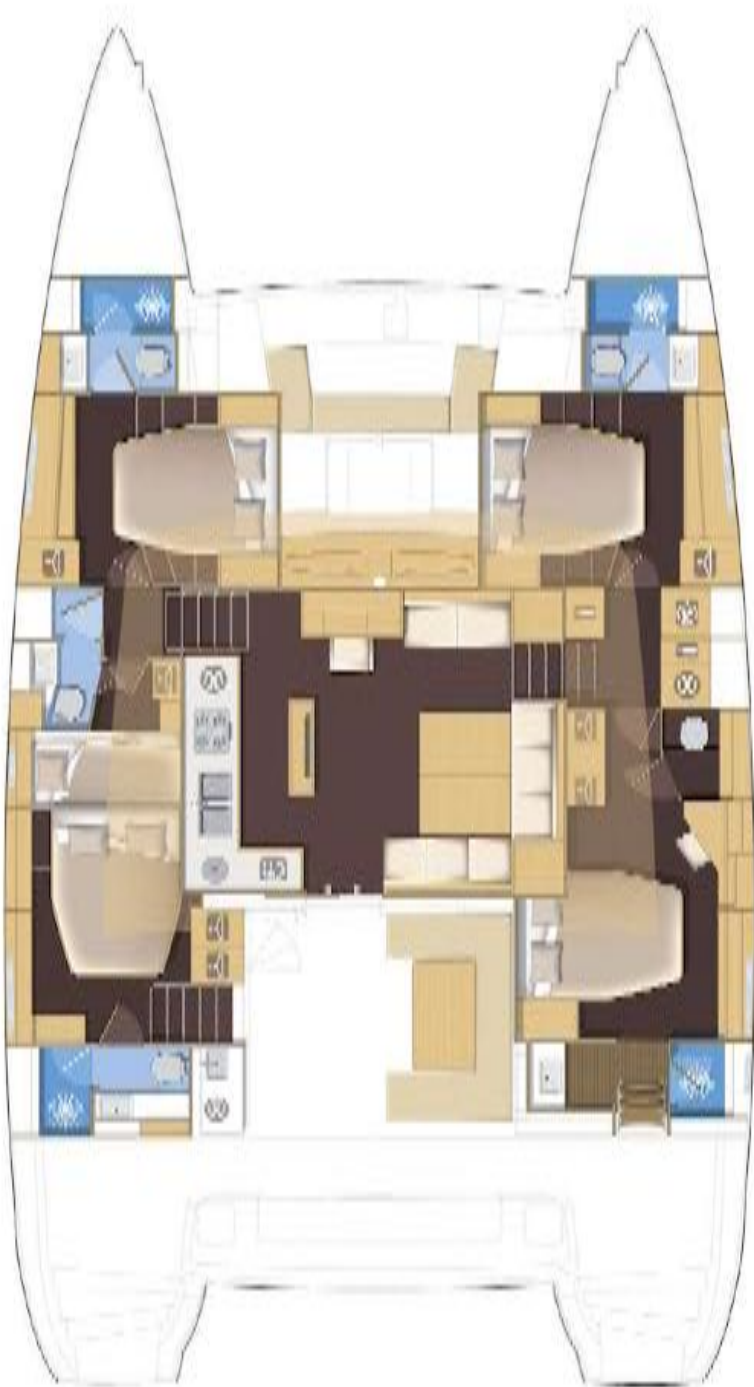

S/Y BOOM is a Lagoon 560 built in 2018 She leads in comfort, ergonomics and style, combining the world-renowned talents of the architectural firm VPLP and the design consultants Nauta. Designed for hospitable cruising.

The fly bridge is a veritable upper-deck saloon (access via closable stairway). Its helm station provides perfect visibility and includes a magnificent spot for sunbathing at the rear The cockpit is fully protected from the sun and sea spray and is on the same level as the galley cuisine (centre galley version), saloon and chart table. Includes large sliding glass door. Large and practical foredeck cockpit. Transom platforms specially designed for safe boarding. The cockpit is directly accessible from the owner's cabin (starboard) and guest cabin (port) owner's cabin includes office, separate washroom and direct access to the cockpit

Guest cabins include VIP accommodation with separate washrooms, the saloon is made up of a lounge area and an "L-shaped" galley separated by a stowage unit that can also accommodate a TV on a lift mechanism on the lounge side.

SPECIFICATIONS

- Length:** 16.96 metres (55' 8")
- Beam:** 9.45 metres (31')
- Draft:** 1.50 metres (4' 11")
- Number of crew:** 3
- Built:** 2018
- Builder:** Lagoon
- Naval architect:**
- Flag:** Greek
- Hull construction:** GRP
- Hull configuration:** Multi hull
- Air conditioning, WiFi connection on board

ACCOMMODATION

- Number of cabins:** 5
- Cabin configuration:** 1 cabin with bunk beds
- Bed configuration:** 4 Queen
- Number of guests:** 10

EQUIPMENT

- Engines:** 2 X 110HP (Yanmar 4JH4-110) with straight shaft
Onan Genset 17,5 Kva 220V / 50 Hz
- 2 Watermakers
- Cruising speed:** 10
- Fuel consumption:** 25 Litres/Hr

WATER SPORTS

- Tenders + toys:** TENDER HIGHFIELD 4,20 m + 60 hp
- 2 X SEABOB
- WATERSKI (children & adult)
- WAKEBOARD
- WATER TUBE
- SNORKELING EQUIPMENT
- 2 x KAYAK
- 2 X SUP
- FISHING GEAR