



S/Y KIMATA

























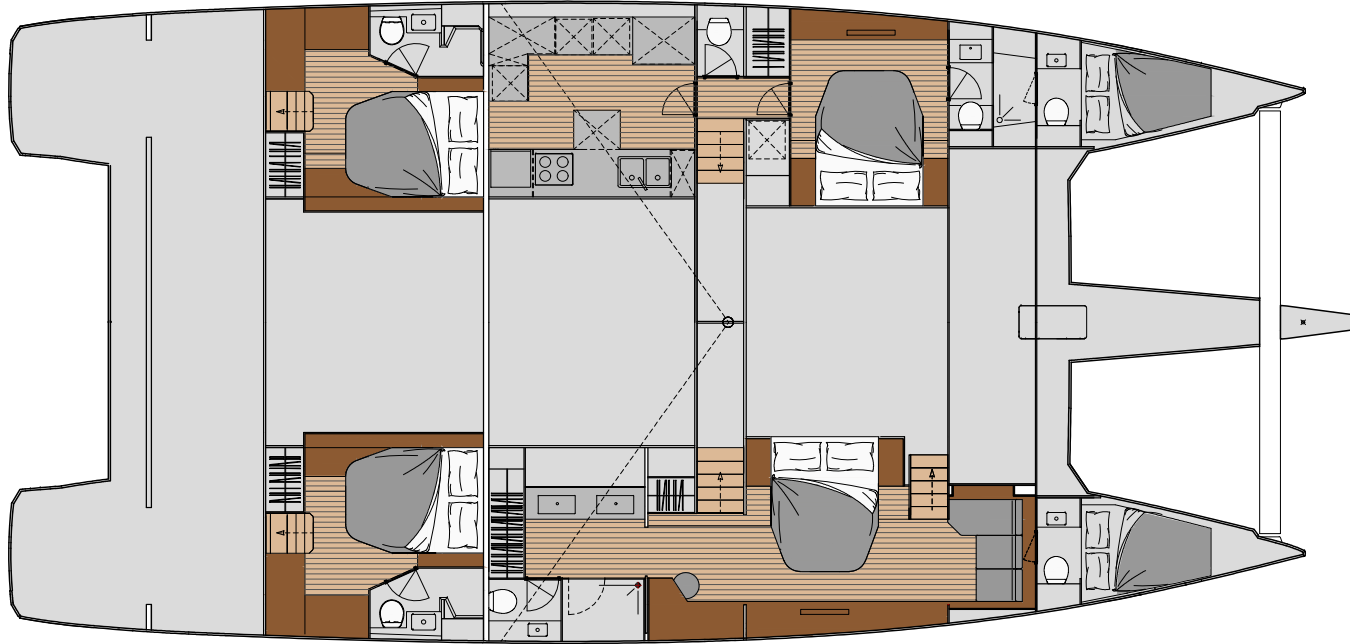

S/Y KIMATA is pure luxury in a catamaran her expansive flybridge with an authentic ocean terrace and a forward cockpit with jacuzzi; are just some of her hallmark features. Experience the exhilaration of sailing or simply relaxing on the decadent lounges or sunbathing beds. Her stunning interior is boldly modern and incredibly spacious to deliver the ultimate in comfort and luxury. She accommodate 8 guests in four cabins - one owner's suite and 3 queen bed cabins all with private bathrooms. The flybridge together with the forward deck offers plenty of space for sunbathing and relaxing and the aft cockpit a great area for socialising and alfresco dining. Our crew consisting of a captain, hostess and chef will look forward to pampering guests on board without leaving any wish unfulfilled.

SPECIFICATIONS

- Length: 20.46 metres (67' 2")
- Beam: 9.84 metres (32' 3")
- Draft: 1.70 metres (5' 7")
- Number of crew: 3
- Built: 2021
- Builder: Fountaine Pajot
- Naval architect:
- Flag: Greek
- Hull construction: GRP
- Hull configuration: Multi hull
- Air conditioning,
- Deck Jacuzzi,
- WiFi connection on board

EQUIPMENT

- Engines: 2 x 150 HP
- Fischer Panda 6 KVA Onan 17 KVA
- 2 X watermaker
- Washer / dryer
- Cruising speed: 10
- Fuel consumption: 20 Litres/Hr

ACCOMMODATION

- Number of cabins: 4
- Cabin configuration: One owner's cabin and 3 queen bed cabins
- Bed configuration: 1 King, 3 Queen
- Number of guests: 8

WATER SPORTS

- Tenders + toys: TENDER HIGHFIELD 4,20 with 60 HP
- 2 X Seabobs, 2 X SUP,
- 2 KAYAK, towables, snorkeling equipment, wakeboard
- fishing gear, waterski children and adult