



$\pi^2$









































































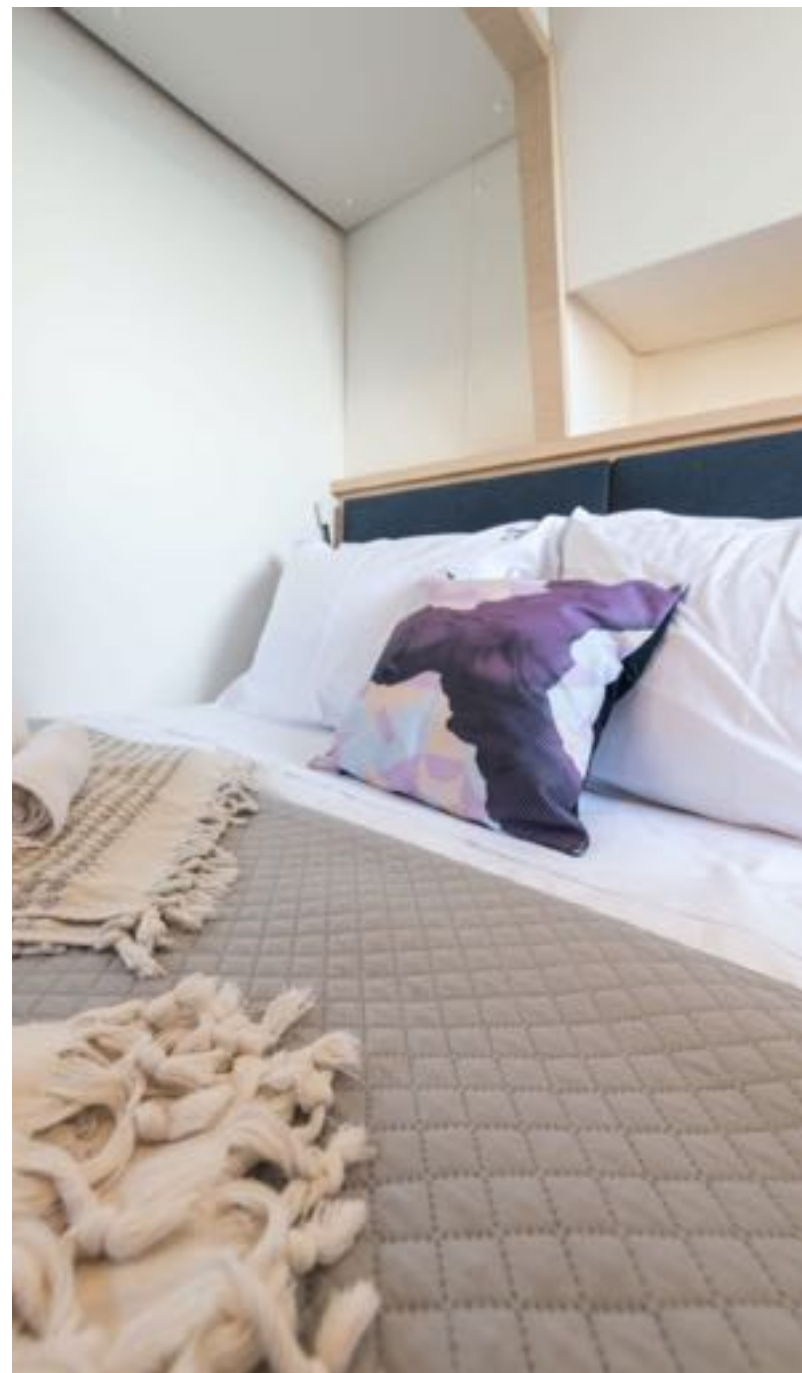

















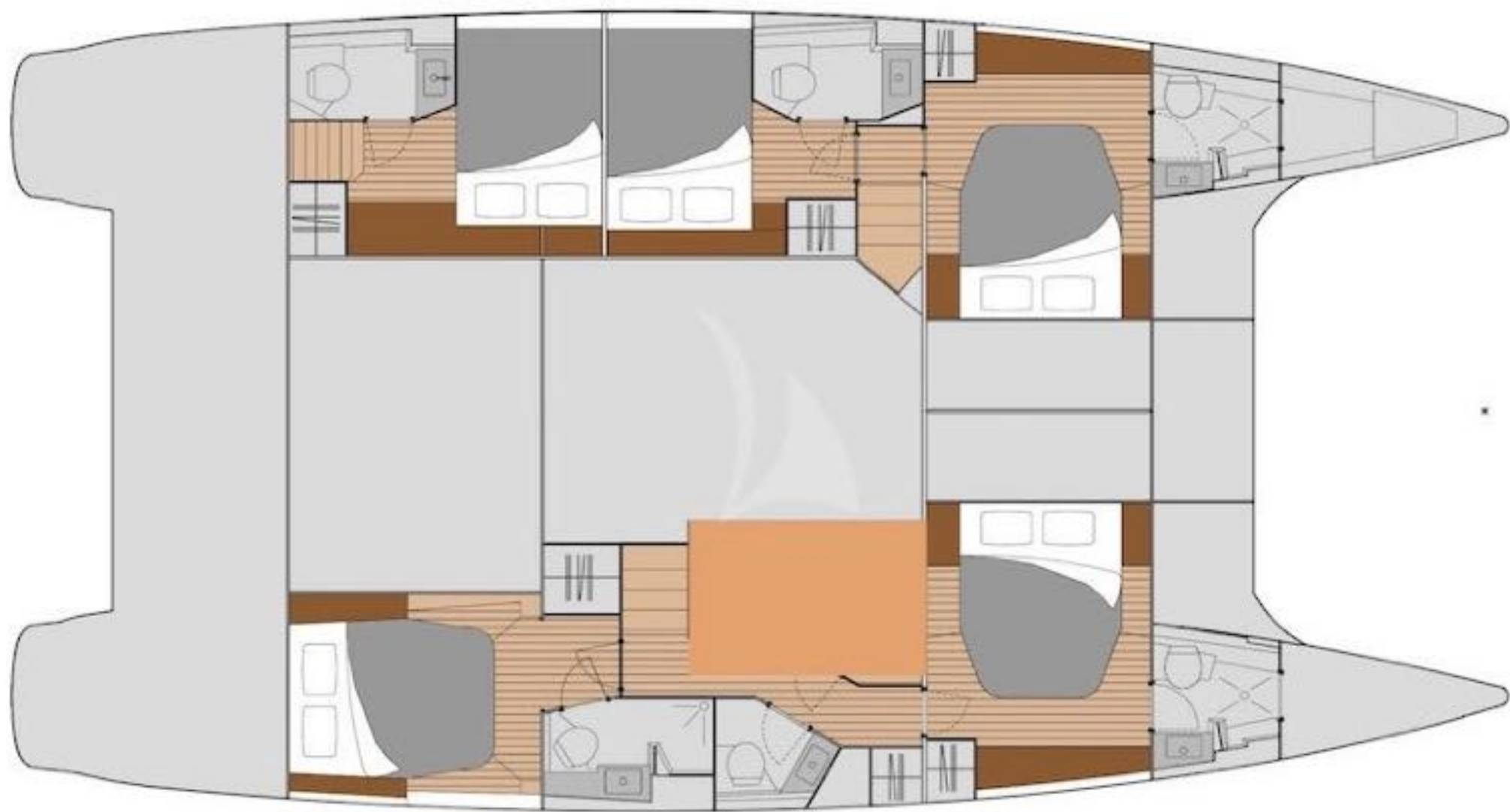

# Specifications

**Length:** 15.00 metres (49' 3")

**Beam:** 7.99 metres (26' 3")

**Draft:** 1.25 metres (4' 1")

**Number of crew:** 3

**Built:** 2019

**Builder:** Fountaine Pajot

**Flag:** Greek

**Hull construction:** GRP

**Hull configuration:** Multi hull

Air conditioning, WiFi connection on board

## ACCOMMODATION

**Number of cabins:** 5

**Bed configuration:** 5 Queen

**Number of guests:** 10

## EQUIPMENT

**Engines:** 2 VOLVO 75HP D2 engines

1 x Onan 11 Kva generator

**Cruising speed:** 10

**Fuel consumption:** 20 Litres/Hr

## WATER SPORTS

**Tenders + toys:** T/T Highfield 4,20 w/ 50 HP engine

2 X Paddle board

1 X Kayak

Snorkeling Equipment

Fishing gear