

110 FIDI WILLIAM STREET

BETWEEN WILLIAM STREET AND GOLD STREET ON JOHN STREET

Excellent Vented Retail Opportunity
ADJACENT TO ONE OF NYC'S BUSIEST SUBWAY STATIONS



110 FIDELITY WILLIAM STREET

*More than 27 Million
Annual Riders @
Fulton St Station*



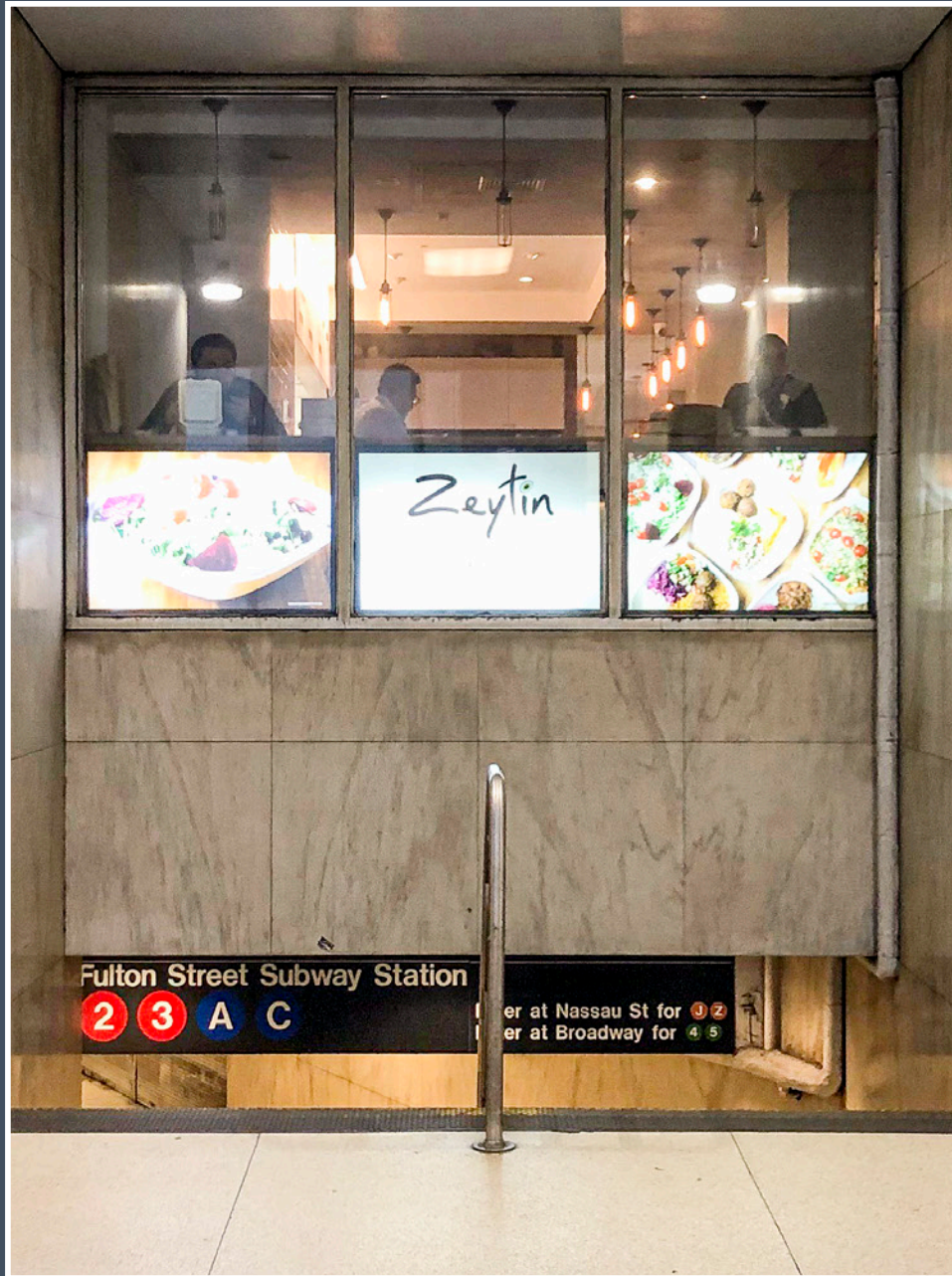

Ground Floor **2,414 SF**

Frontage **12 FT**

Ceiling Hts **11 FT**

Asking Rent
Upon Request

Possession
Immediate

Lease Type
Direct

- Excellent QSR/coffee Opportunity
- Adjacent to the Fulton Street Station
- Located at the base of a 950,000 SF office Building
- Blade signage available
- Existing kitchen and vent in place
- All uses considered

COMMENTS

FIDI 110 WILLIAM STREET

Ground Floor
2,414 SF

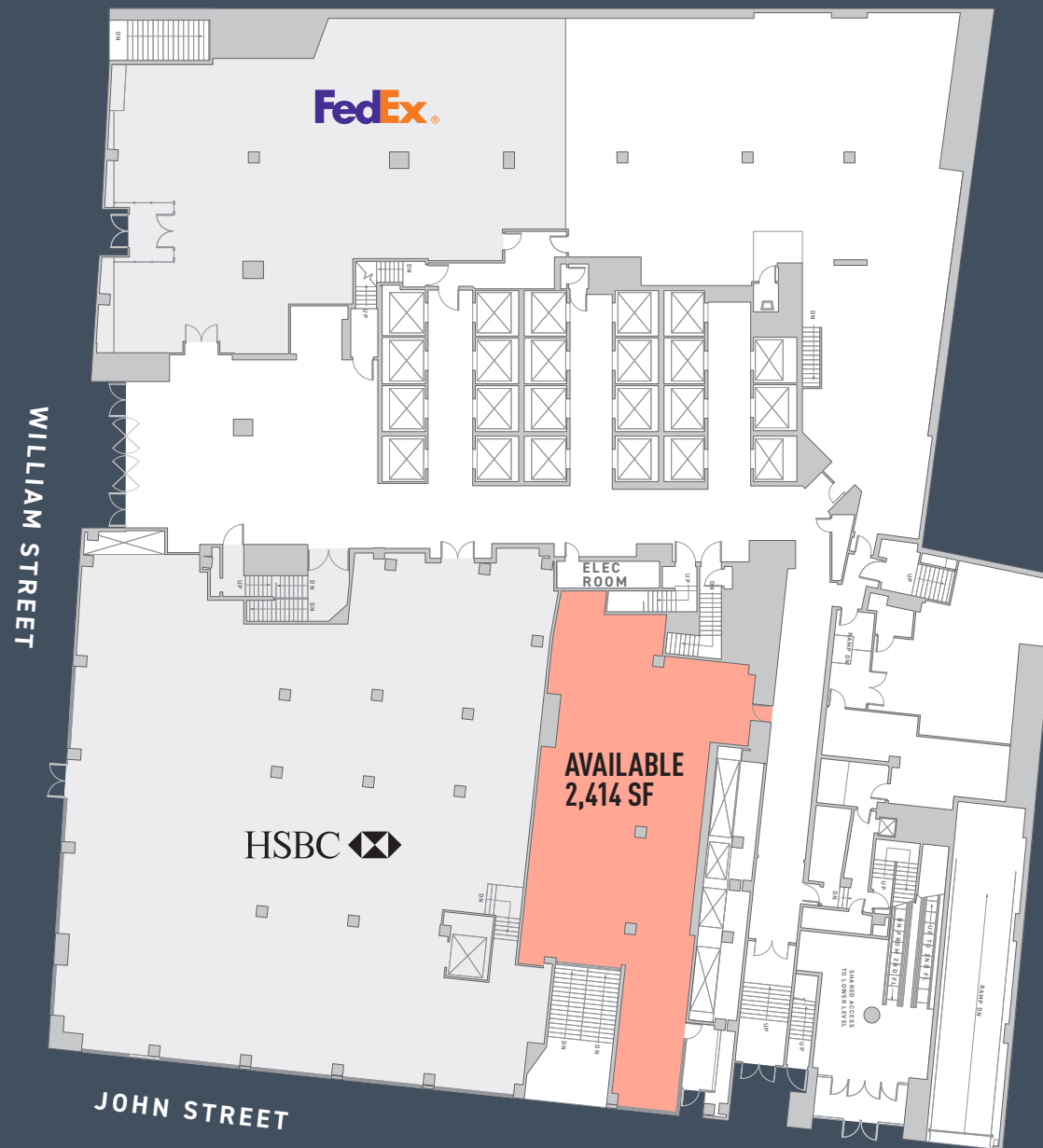

HSBC

Chipotle

Open Kitchen

BentOn Café

smashburger

Meltshop

Au Bon Pain

GRK Fresh Greek

The Ainsworth

150 Market

Bocadillo

Jubilee

Stout NYC

Crunch

Chicken BonChon



110 FIDI WILLIAM STREET

Please contact us for retail leasing inquiries:

Steven Soutendijk
Steven.Soutendijk@cushwake.com
212 713 6845

Molly Sandza
Molly.Sandza@cushwake.com
212 841 7955

Patrick O'Rourke
Patrick.Orourke@cushwake.com
212 660 7777

