

MELBOURNE - Centrepiece Melbourne Park

Centrepiece Melbourne Park is Melbourne's most surprising new Conference and Events Venue, located in the heart of Australia's premier sports and entertainment precinct. With its magnificent architectural design and breath-taking city views this is a world class venue.

Centrepiece offers a range of flexible spaces for events of any scale, from intimate dinners to large scale special events. The Grand Hall with its endless floorplan configurations can be used as a gala or awards dinner venue or to host your next conference.

Sustainable, flexible venue design with various breakout spaces. There is a state-of-the-art auditorium, with cutting-edge technology and audio-visual capabilities. Centrepiece offers a Paddock-to-plate philosophy, sourcing sustainable produce from the best that Victoria has to offer.

1 GRAND HALL

- 2,000 sqm of flexible event space
- Accommodates up to 1,480 guests in a banquet setting, 2,000 in theatre-style seating or 3,000 in a cocktail setting
- Adjoining the Grand Hall is a 750 sqm pre-function area and a large outdoor terrace overlooking the city of Melbourne Auditorium
- 250-seat state-of-the-art auditorium
- Advanced audio-visual capabilities
- Easy access to the outdoor terrace for pre-function refreshments

2 MEETING ROOMS & STUDIOS

- Small secretariat rooms for up to four people
- Larger multipurpose rooms that can host up to 100 people
- Abundant natural light opening onto balconies overlooking the precinct

3 OUTDOOR TERRACES

- Larger terrace (245sqm) adjacent to the Grand Hall
- Smaller terrace (120sqm) adjacent to the Auditorium
- Surrounded by green open space, with beautiful views of the city skyline
- Fully covered and heated

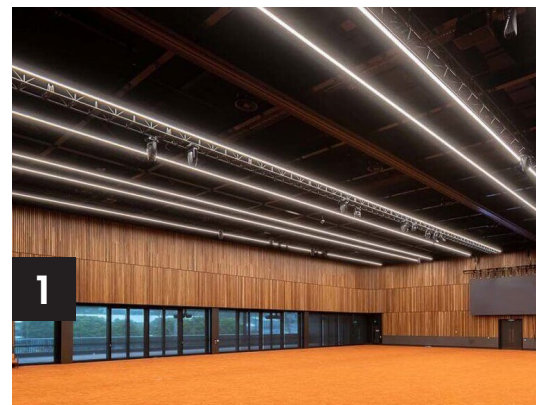

SYDNEY - New Ace Hotel

Iconic lifestyle hotel brand Ace Hotel opened its doors early this year, bringing its cultural and transformative design to Surry Hills, Sydney. The 100 year old Tyne Building one of Australia's first ceramic kilns (producing pottery as early as the 1820's) has been given a stylish makeover by Ace. A melting pot of old world with the future, this newly refurbished hotel and event space is minimalistic in its design and boasts an impressive art collection.

Home to three dedicated event spaces that are flexible and adaptable to suit your event needs. This is an amazing new venue to host your next event in Sydney! The event spaces are given fitting names to tie in with the history of the building.

BRICK - A large event space featuring high ceilings and extensive Surry Hills views. Room for up to 120 guests, Brick comfortably hosts large gatherings and can expand by 150 sq m if extra room is required.

CLAY - A sun-filled event space for everything from intimate events to team meetings and cocktail parties. Clay is intimate enough for a small guest list but can also be opened up and adjoined with Brick to accommodate larger groups.

TYNE - The largest event space features high ceilings and vast windows for soaking in the beautiful Sydney sun. Tyne is highly adaptable and fit for all occasions from large events to low-key lunches and get-togethers.

