

State Highway 16

44 Interchange



Anticipated Construction Impacts September to November 2025

In this stage, crews will:

- Widen SH-44 to the south
- Build the new eastbound off-ramp along SH-16

Traffic impacts include:

- Reducing SH-44 down to one lane heading east (toward Boise)
- Reducing SH-16 down to one lane in each direction between the Boise River Bridge and SH-44
- Reducing speed to 55 mph

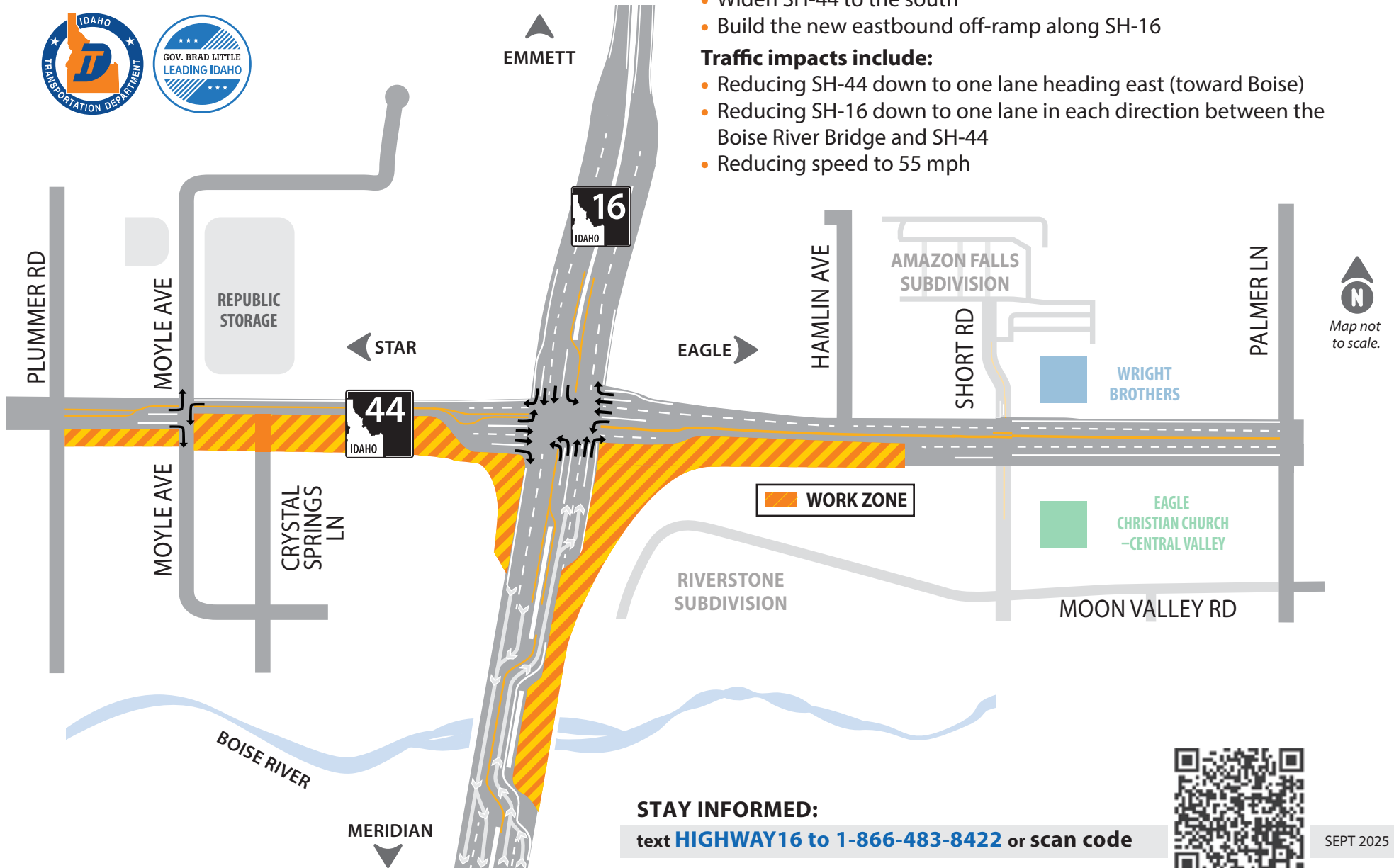

STAY INFORMED:

text **HIGHWAY16** to 1-866-483-8422 or scan code

