

FOR SUBLEASE

Immediately Available



10,259 Rentable Square Feet in LPC's Gold Leed & Energy Star Certified Vertical Campus



400 Corporate Pointe, Suite 600 | Los Angeles, CA 90230

BRAD WILSON Lic # 00881303

Tamarack Real Estate Services

[E] brad@tamarackres.com

[P] (818) 632-8418

[A] 15300 Ventura Blvd., Ste. 200 | Sherman Oaks, CA 91403

DOUGLAS A. CLAMAN Lic # 01871655

JAAD Partners LLC

[E] daclaman@jaadpartners.com

[P] (310) 251-6656

[A] 475 Washington Blvd. | Marina Del Rey, CA 90292

Property Description

400 Corporate Pointe, Suite 600 | Los Angeles, CA 90230



Size	10,259 Rentable Square Feet (Sublandlord may be willing to demise the suite)
Rate	Negotiable
Term	Sublease Term Through May 31, 2026
Features	<ul style="list-style-type: none">• Wrap-Around, Unobstructed Views in All Directions• Creative Build-Out Utilizing Open Ceilings, Interior Glass Walls, and Polished Concrete Floors• Friendly Dog Breeds Permitted (6 max at the same time < 100 lbs.)• Spacious Landscaped Grounds with Outside Eating Areas, Outdoor Wi-Fi and USB Plugs• Immediately Adjacent to the 405 and 90 Freeways, and close to LAX, Playa Vista, Downtown Culver City, and Marina del Rey• Numerous Nearby Amenities Including Restaurants & Retail at HH Center and Fox Hills Mall• Bonus Storage Area: Building Adjacent Garage – Level P2
Parking	Up to 31 Car Unreserved Parking in Building Adjacent Garage at Project Prevailing Rates / Additional Stalls Available

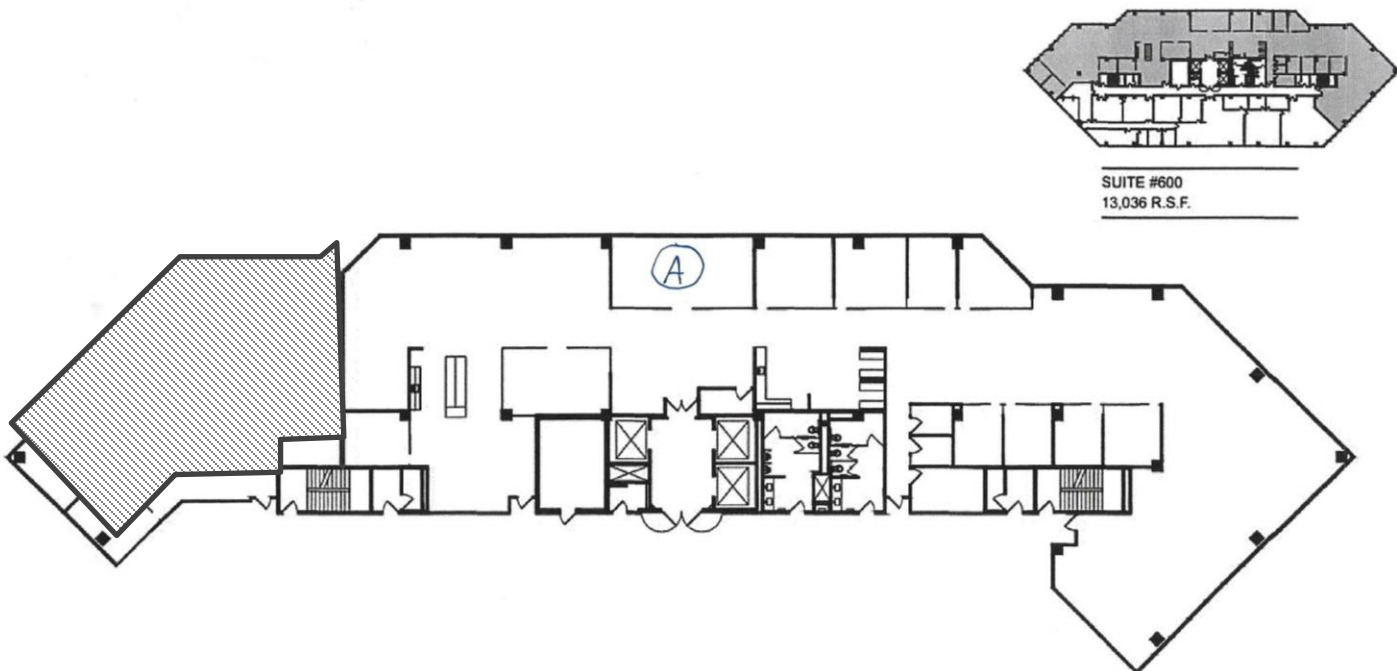

Disclaimer: All information contained herein is from sources deemed reliable; however, no representation or warranty is made to the accuracy thereof.

Floor Plan

400 Corporate Pointe, Suite 600 | Los Angeles, CA 90230



North View



South View



Photos

400 Corporate Pointe, Suite 600 | Los Angeles, CA 90230

