

CATHEDRAL CHURCH OF NATIVITY

Bethlehem, Pennsylvania

Project Update

Campus Planning & Site Design

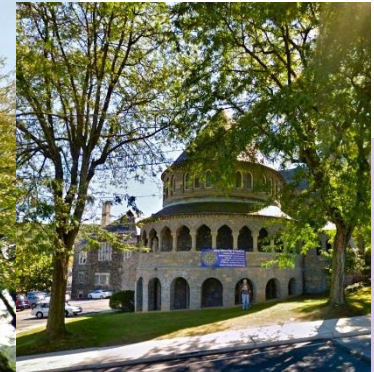
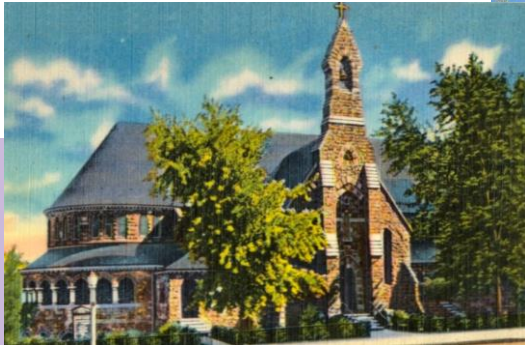
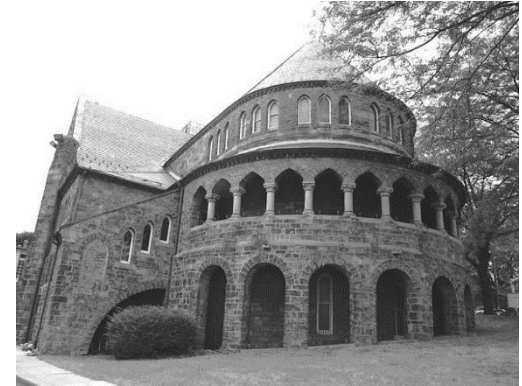

The Project Team

STEERING COMMITTEE MEMBERS

Richard Sause

Harry Johnston

Meg Seltzer

Werner Reinartz

Karen Boksan

Tom Edwards

The Very Reverend Anthony Pompa

Dick Guyer

Mary Mulder

Joe Hafich

Annalisa Kelly-Cavotta

and

architerra, pc.

David Horn

Project Mission Statement

“Our Nativity Cathedral Campus Plan will be a success if our campus is a welcoming and inviting place, where people feel included, safe, inspired, and at peace, and which has physical resources aligned with our mission and values, as well as the needs of our community.”



Campus Master Plan Goals

- Celebrate Aesthetics
- Enhance the Parking Experience
- Improve Image and Communication
- Create Better External Spatial Development to Meet Needs
- Foster Connectivity with Neighborhood
- Support Partnership with New Bethany
- Enhance the Outdoor Experience for All Age Groups
- Enhance the Thrift Shop and Identity/Opportunity

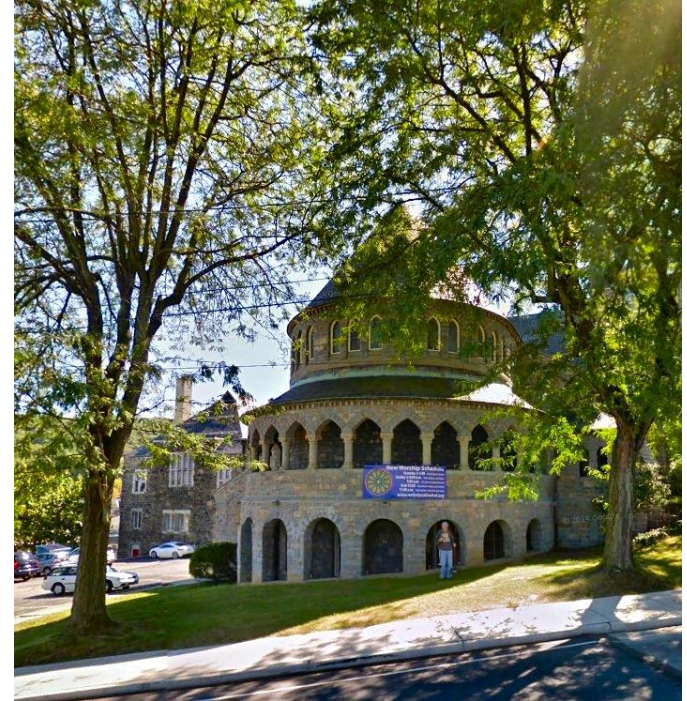

Nativity's Existing Campus

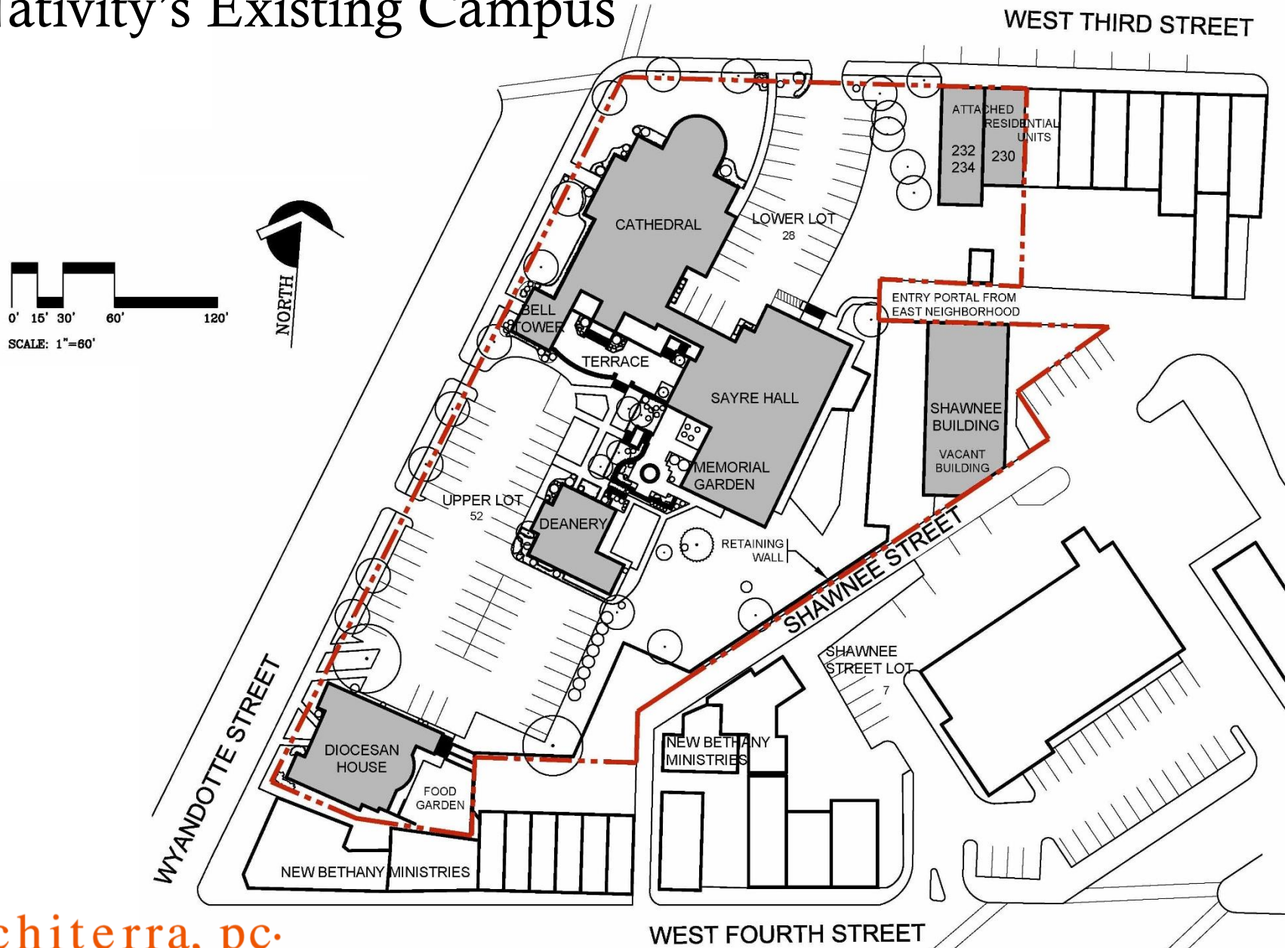

Progress to Date

Beginning in April 2018, The Campus Master Plan has Accomplished the Following:

- Developed a Campus Base Plan
- Performed Site Assessment of Circulation, Lighting, Program Accommodation, Vegetation, and Signage
- Researched Municipal Regulations
- Developed Conceptual Designs for Upper Lot, Lower Lot, Garden Area, and East Lot(s)
- Created New Step Design for Cathedral Entry
- Illustrated Numerous Parking Scenarios
- Presented Major Identification Signage Ideas
- Have Recently Initiated Refinement and Connectivity of the Components Through Working with the Steering Committee

Performed Site Assessment of Circulation, Lighting, Program Accommodation, Vegetation, and Signage

EXISTING SIGN PHOTOS - THRESHOLD SIGNAGE



EXISTING SIGN PHOTOS - DIRECTIONAL SIGNAGE



EXISTING SIGN PHOTOS - TEMPORARY SIGNAGE



Performed Site Assessment of Circulation, Lighting, Program Accommodation, Vegetation, and Signage

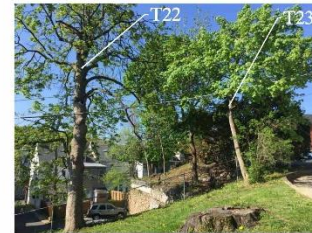
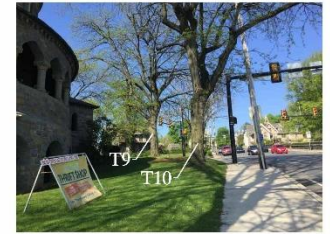
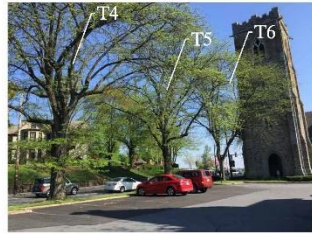
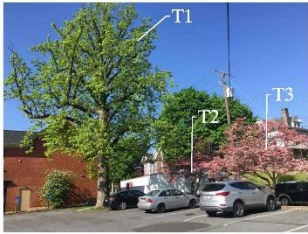

Researched Municipal Regulations

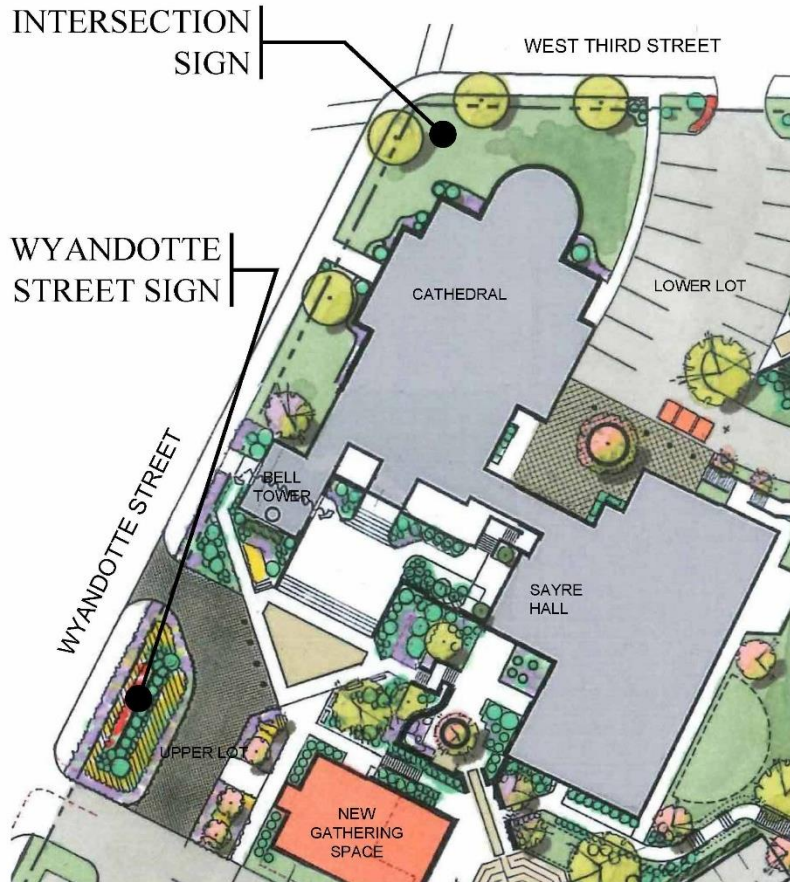

architerra, pc.

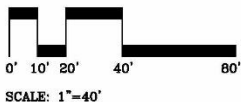

GENERAL SUMMARY

QUANTITY OF SIGNS

- ONE FREESTANDING SIGN PER STREET FRONTAGE
- THIS PROPERTY FRONTS UPON THE FOLLOWING STREETS:

WYANDOTTE STREET
SOUTH HASTINGS STREET
WEST 4TH STREET
WEST 3RD STREET

SIGN AREA

- AREA SHALL NOT EXCEED 50 SQUARE FEET
- IF A LOT IS ALLOWED 2 FREESTANDING SIGNS, THE APPLICANT MAY COMBINE THE ALLOWED SIGN AREA ONTO A SINGLE FREESTANDING SIGN
- INTERPRETATION ON FOUR STREET FRONTAGES (IE. 200 SF)

SIGN HEIGHT

- NO PORTION OF ANY SIGN SHALL BE MORE THAN 30 FEET ABOVE THE GROUND

SIGN LOCATION

- SIGNS SHALL NOT PROJECT INTO THE STREET RIGHT-OF-WAY OR CLEAR SIGHT TRIANGLE
- NO SIGN SETBACK SHALL BE REQUIRED IN THE CENTRAL BUSINESS DISTRICT (WE ARE IN CBD.)
- CLEAR SIGHT TRIANGLES AT CORNER LOTS IN THE CENTRAL BUSINESS DISTRICT ARE MEASURED 8 FEET FROM THE INTERSECTION OF THE RIGHT-OF-WAY

SIGN LIGHTING

- SIGNS MAY BE ILLUMINATED BY DIRECT LIGHTING BUT SHALL HAVE SUCH LIGHTING SHIELDED SO NO DIRECT LIGHT WILL SHINE ON ABUTTING PROPERTIES OR IN THE NORMAL LINE OF VISION OF THE PUBLIC USING THE STREETS AND SIDEWALKS

CITY OF BETHLEHEM ZONING ORDINANCE : SPECIFICS

AREA OF SIGNS

- THE AREA OF A SIGN SHALL BE CONSTRUED TO INCLUDE ALL LETTERING, WORDING, AND ACCOMPANYING DESIGNS AND SYMBOLS, TOGETHER WITH THE BACKGROUND, WHETHER OPEN OR CLOSED, ON WHICH THEY ARE DISPLAYED, BUT NOT INCLUDING ANY SUPPORTING FRAMEWORK AND BRACING WHICH ARE INCIDENTAL TO THE DISPLAY ITSELF.
- WHERE THE SIGN CONSISTS OF INDIVIDUAL LETTERS OR SYMBOLS ATTACHED TO OR PAINTED ON A SURFACE, BUILDING, WALL, AWNING, OR WINDOW, THE AREA SHALL BE CONSIDERED TO BE THAT OF THE SMALLEST RECTANGLE WHICH ENCOMPASSES ALL OF THE LETTERS AND SYMBOLS.
- IN COMPUTING SQUARE FOOT AREA OF A DOUBLE-FACE SIGN, ONLY ONE SIDE SHALL BE CONSIDERED PROVIDED BOTH FACES ARE IDENTICAL. IF THE INTERIOR ANGLE FORMED BY THE TWO FACES OF THE DOUBLE-FACED SIGN IS GREATER THAN 45 DEGREES, THEN BOTH SIDES OF SUCH SIGN SHALL BE CONSIDERED IN CALCULATING THE SIGN AREA.

SOUTH BETHLEHEM HISTORIC CONSERVATION COMMISSION : SPECIFICS

SIGN REVIEW

- THE SOUTH BETHLEHEM HISTORIC CONSERVATION COMMISSION (SBHCC) REVIEWS ALL CERTIFICATE OF APPROPRIATENESS (COA) APPLICATIONS FOR PROPOSED EXTERIOR SIGNS. THE APPLICANT MUST OBTAIN A COA AS WELL AS ALL NECESSARY PERMITS PRIOR TO PROCEEDING WITH ANY WORK.
- THE SBHCC WILL NOT RECOMMEND APPROVAL FOR PRE-MANUFACTURED, STOCK, EXTRUDED ALUMINUM SIGN BOXES WITH INTERNAL FLOURESCENT LIGHTS AND TRANSLUCENT SIGN FACES.

Developed Conceptual Designs for Upper Terrace

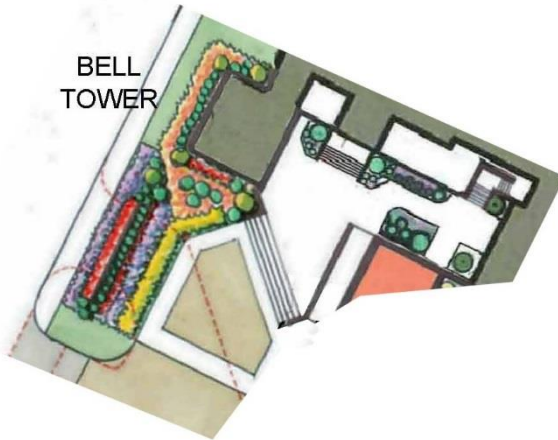
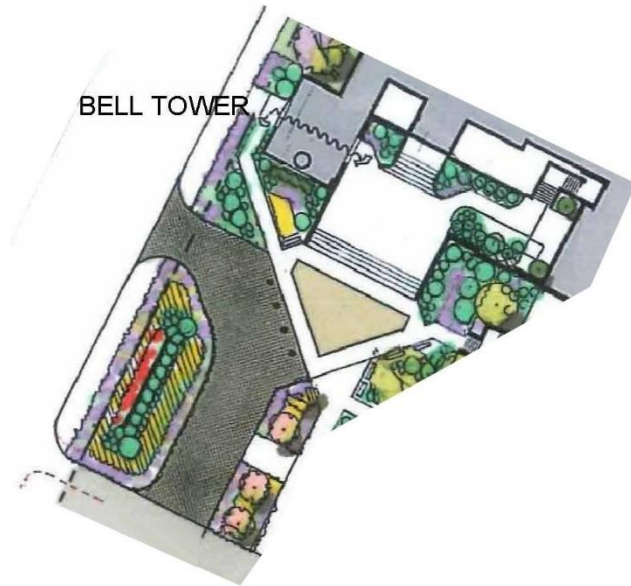

Developed Conceptual Designs for Lower Lot

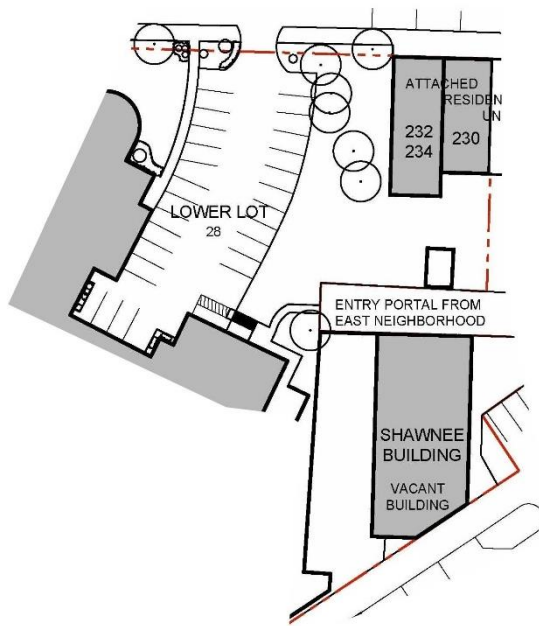

Developed Conceptual Designs for Garden Area



Created New Step Design for Cathedral Entry

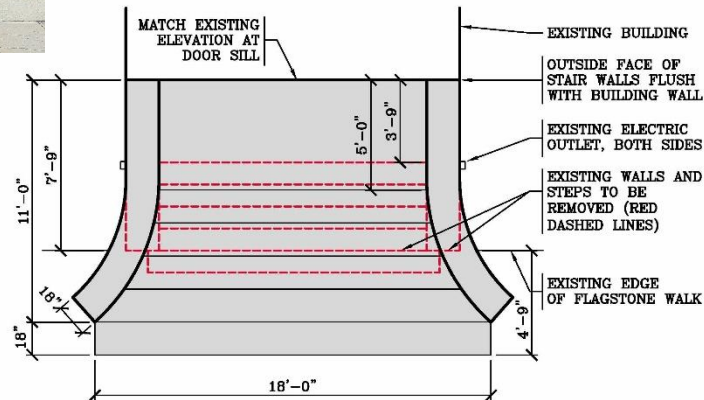
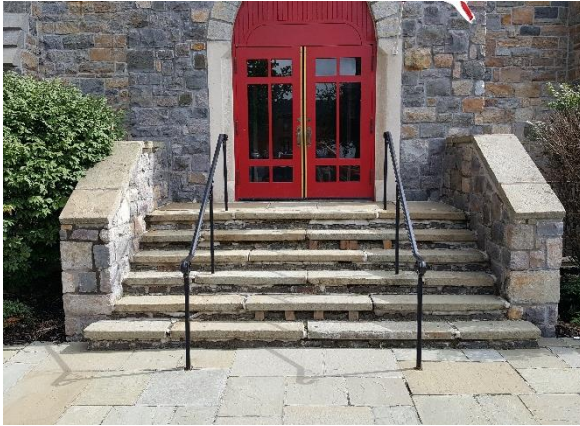

PLAN VIEW

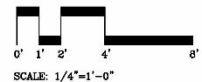

STAIRWAY NOTES:

1. MASONRY TO MATCH EXISTING STONE VENEER, WALL COPING, STEP TREADS, AND MORTAR COLOR.
2. CONTRACTOR TO PROVIDE HANDRAIL SHOP DRAWINGS FOR OWNER REVIEW AND APPROVAL.

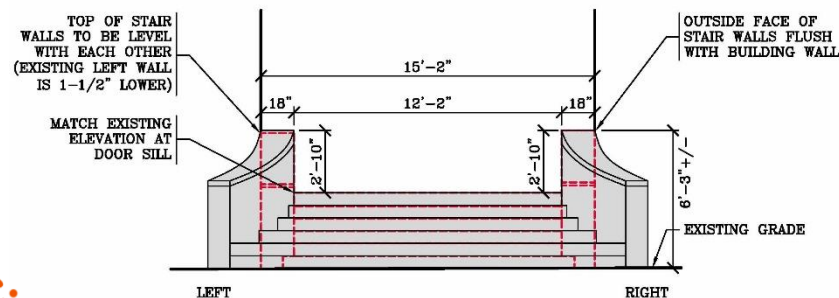

FRONT ELEVATION

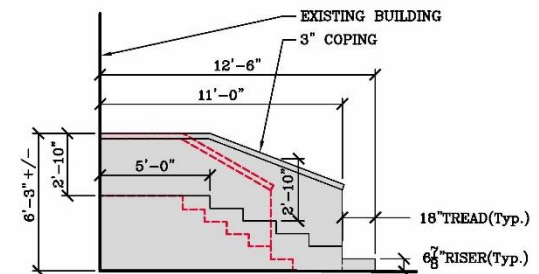

CROSS-SECTION

Illustrated Numerous Parking Scenarios

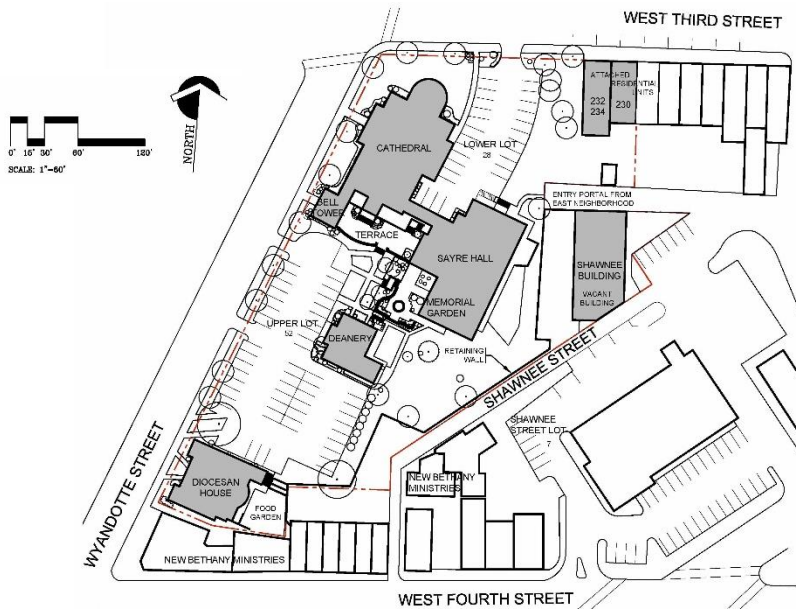

Presented Major Identification Signage Ideas

CATHEDRAL CHURCH OF THE NATIVITY SIGN CONCEPT - A

9 AUGUST 2018

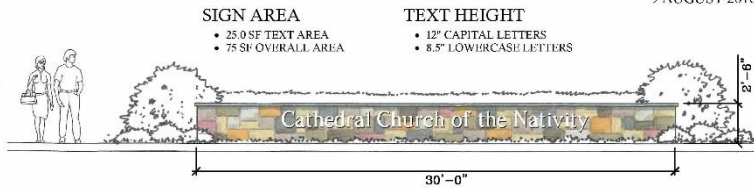

SIGN AREA

- 26.5 SF TEXT AREA
- 75 SF OVERALL AREA

TEXT HEIGHT

- 12" CAPITAL LETTERS

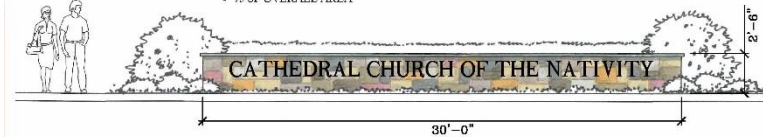

SIGN AREA

- 23 SF TEXT AREA
- 65 SF OVERALL AREA
- 50 SF COLORED AREA

TEXT HEIGHT

- 11.5" CAPITAL LETTERS
- 8" LOWERCASE LETTERS

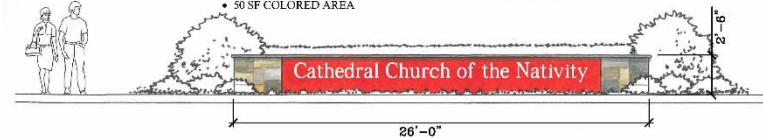

SIGN CONCEPT A - ELEVATIONS

3/16" = 1'-0" SCALE

CATHEDRAL CHURCH OF THE NATIVITY SIGN CONCEPT - B

9 AUGUST 2018

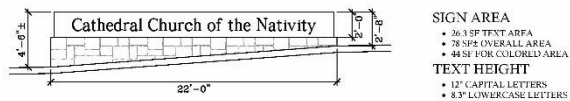

SIGN CONCEPT B - ELEVATION

3/16" = 1'-0" SCALE

CATHEDRAL CHURCH OF THE NATIVITY SIGN CONCEPT - C

9 AUGUST 2018

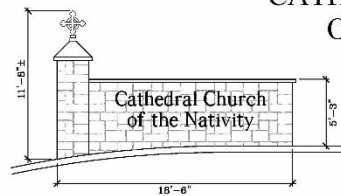

SIGN CONCEPT C - ELEVATION

3/16" = 1'-0" SCALE

CATHEDRAL CHURCH OF THE NATIVITY SIGN CONCEPT - H

9 AUGUST 2018

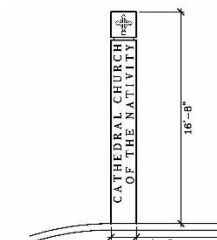

SIGN CONCEPT H - ELEVATION

3/16" = 1'-0" SCALE

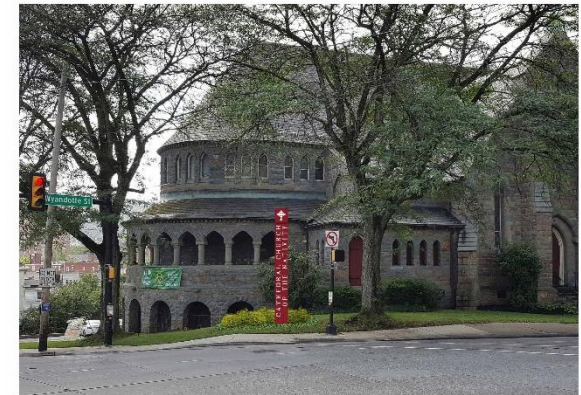
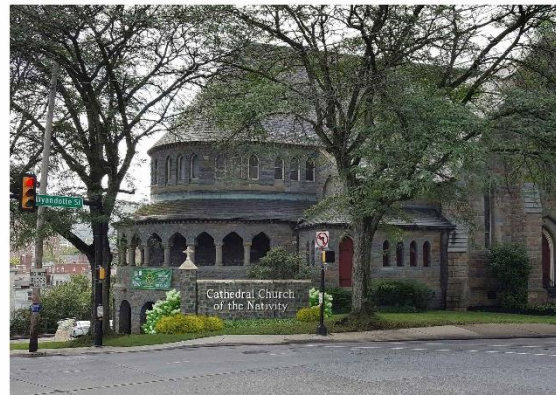
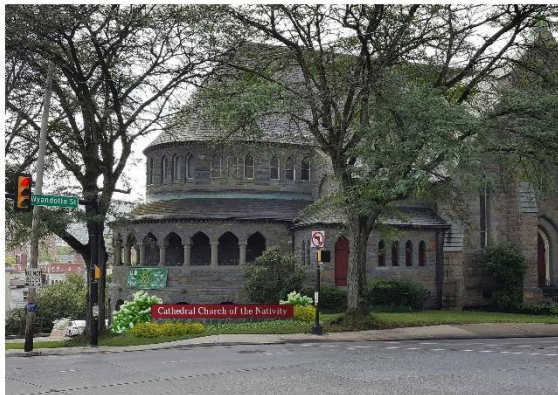

Progress to Date

Beginning in April 2018, The Campus Master Plan has Accomplished the Following:

- Developed a Campus Base Plan
- Performed Site Assessment of Circulation, Lighting, Program Accommodation, Vegetation, and Signage
- Researched Municipal Regulations
- Developed Conceptual Designs for Upper Lot, Lower Lot, Garden Area, and East Lot(s)
- Created New Step Design for Cathedral Entry
- Illustrated Numerous Parking Scenarios
- Presented Major Identification Signage Ideas
- Have Recently Initiated Refinement and Connectivity of the Components Through Working with the Steering Committee

Work Which Remains

- Refinement of Design Options with Implementation Estimates of Cost
- Development of Campus Signage Strategy with Implementation Estimates of Cost
- Creation of Master Plan Phasing
- Finalization of Fundraising Graphics
- Compilation of Master Plan Report

Completion This Year