

2019-20 South Metro Regional Tournament  
Fort Logan at Northgate School - March 7, 2020



# WELCOME

## Good luck to all teams competing in the tournament!

Thank you to all of the Team Managers, teachers, school sponsors, Appraisers, volunteers, and parents for your hard work to make this tournament possible.

The top 3 Elementary Level teams, the top 3 Middle Level teams, and all the Secondary Level teams will advance to the Destination Imagination Colorado Affiliate Tournament on April 4.

## Tournament Notes & Reminders

- Teams should report to their Challenge Prep Area 20 minutes before their scheduled Presentation time. Engineering teams should report to Structure Check-In at least 1 hour before their scheduled Presentation time.
- Spectators will NOT be allowed to enter the Presentation Area once a team's Presentation has begun.
- Parents, spectators, and Team Managers: remember to respect the rules of Interference. Do not interfere with the team's solution.
- The Awards Party will begin at 4:00pm
- All teams should report to the gym for the Closing Ceremony at 5:00pm.

---

## Acknowledgments

To all the staff members and district personnel at Fort Logan Northgate School, a huge thank you!!! Your facilities are beautiful and your hospitality has been overwhelming.

---

## Release/Disclaimer

By my participation in an event conducted by an Affiliate, Region, or other gathering related to the Destination Imagination program, the participant or participant's parents or participant's guardian understands and hereby voluntarily agrees to release, waive, forever discharge, hold harmless, defend, and indemnify Destination Imagination, Inc. and its agents, officers, boards, volunteers, and employees from any and all liability and all claims, actions, or losses for bodily injury, property damage, wrongful death, loss of services, or otherwise which may arise out of the participant's participation in activities related to the Destination Imagination event, including travel to and from the event.

# GENERAL SCHEDULE

7:00 a.m.	Appraiser Check-In	Volunteer Room
8:30 a.m. - 3:00 p.m.	DI Store (Concessions -Shirt/Pin Sales)	Cafeteria
<b>9:00 a.m - 4:00 p.m.</b>	<b>Performances - Spectators Welcome!</b>	<b>See Performance Locations Below</b>
9:00 a.m. - 2:20 p.m.	Technical - The Big Fix All Levels	Lower Level - Band Room
9:00 a.m. - 3:40 p.m.	Scientific - First Encounter All Levels	Lower Level Gym
9:00 a.m. - 11:00 a.m.	Service Learning - It's About Time All Levels	Upper Level East Wing
9:00 a.m. - 11:20 a.m.	Improv - To the Rescue - Elementary	Main Level West Wing
9:00 a.m. - 2:40 p.m.	Improv - To the Rescue Middle & Secondary	Lower Level Dance Room
10:00 a.m. - 4:00 p.m.	Rising Stars - Blast Off	Main Level East Wing
<b>10:00 a.m - 4:20 p.m</b>	<b>Instant Challenge</b>	<b>Upper Level - West Wing</b>
12:40 p.m. - 4:00 p.m.	Engineering - In the Cards All Levels	Upper Level East Wing
1:00 p.m. - 3:00 p.m.	Fine Arts - Picture This! All Levels	Main Level West Wing
<b>4:00 p.m.</b>	<b>Dance Party</b>	<b>Lower Level Gym</b>
<b>5:00 p.m.</b>	<b>Awards Ceremony</b>	<b>Lower Level Gym</b>

See maps at the end of this program

## Reminders:

- Teams should report to their Challenge Prep Area 20 minutes before their scheduled Presentation time. (Engineering teams should report to Structure Check-In 1 hour before their scheduled Presentation time.) Refer to the floor plan in the back of this program for directions.
- Teams and Team Managers only In Instant Challenge. Parents and supporters should wait for their team In the cafeteria.



## Technical Challenge – All Levels

- Design and build an invention.
- Create and present a story about how a problem is solved with the use of the invention.
- Integrate an invention artifact to highlight the development process.
- Design and build scenery that shows the impact of solving the problem.
- Create and present two Team Choice Elements that show off the team's interests, skills, areas of strength, and talents.

Performance Time	Instant Challenge Time	Team Number	School	Team Name
9:00	10:20	106-25818	American Academy	Double Trouble Rebels
9:20	10:40	106-70204	Copper Mesa Elementary	TheTopHattedTurboTootingTacocats
9:40	11:00	106-82550	Redstone Elementary	Team Rocket
			Break	
10:20	11:40	106-68138	Stone Mountain Elementary	I Don't Have One
10:40	12:00	106-56346	Skyview Academy	Inventineers
11:00	12:20	106-00393	Summit Elementary School	The Pumpkin Busters
			Lunch	
12:20	1:40	106-90530	Euclid & Powell Middle Schools	7 Cool Jumping Tornadoes
12:40	2:00	106-58212	Fort Logan Northgate	AA Team
1:00	2:20	106-28943	Whitestone Academy	Veto Burrito
			Break	
1:40	3:00	106-47318	Littleton High/Euclid Middle School	We Are The TREES
2:00	3:20	106-99939	South Park	Those Kids
2:20	3:40	106-11153	Northridge Elementary	Team Choice Elephants

# Scientific Challenge – All Levels



- Research a real species and a real habitat.
- Create and present a story about the first encounter between the species and the habitat.
- Show how the species and the habitat change as a result of the encounter.
- Present the story in theater in the round.
- Create and present two Team Choice Elements that show off the team's interests, skills, areas of strength, and talents.

## Location: Lower Level - Gym

Performance Time	Instant Challenge Time	Team Number	School	Team Name
9:00	10:00	106-55183	St. Mary's Academy	SMA Cool Kids
9:20	10:20	106-19981	Wilder Elementary	The Hot Tamale Chickens
9:40	10:40	106-06543	Skyview Academy	Exploding Avocados
10:00	11:00	106-02169	St. Mary's Academy	The Fantastic Five
			Break	
10:40	11:40	106-29600	St. Mary's Academy	The Idea Invaders
11:00	12:00	106-98853	Runyon Elementary	Wait, what does that say??
11:20	12:20	106-55602	Whitestone Academy	Flying Jorunna Parva
11:40	12:40	106-36102	St. Mary's Academy	Creative Dominators
			Lunch	
12:40	1:40	106-50553	American Academy	The Waves
1:00	2:00	106-80171	South Park	Megascops Choliba
			Break	
1:40	2:20	106-82491	Goddard Middle School	Ivory Everest
2:00	2:40	106-52487	Mountain Ridge Middle School	Michael with a B(ee)

**Continued on Next Page**

2:20	3:00	106-57687	Pine Lane Elementary	Blue Fuzzy Chainsaws
3:00	3:40	106-04322	South Park	And We'll Be Right Back!
3:20	4:00	106-45380	Kent Denver School	We're D.I.'ing Over Here
3:40	4:20	106-48781	Sand Creek Elementary	The Rainforest Raiders

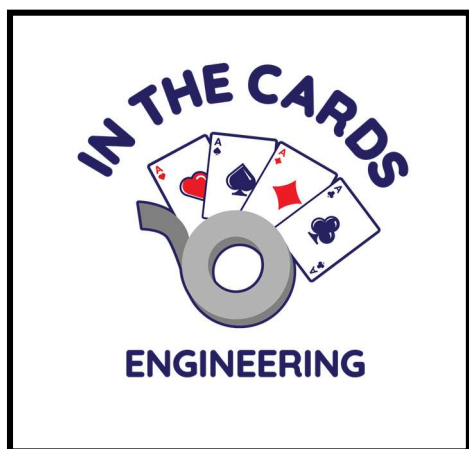

## Engineering Challenge

- Design and build a bridge that will be assembled during the Presentation.
- Move weight across the bridge to test its strength.
- Create and present a story about an unexpected connection and its outcome.
- Design and create a set piece that transitions between settings.
- Create and present two Team Choice Elements that show off the team's interests, skills, areas of strength, and talents.

## Location: Upper Level – East Wing

Weigh-In Time	Performance Time	Instant Challenge Time	Team Number	School	Team Name
11:40	12:40	1:40	106-43970	Stone Mountain Elementary	Team Apple Pie
12:00	1:00	2:00	106-97413	Aspen Academy	I Forgot Their Name
12:20	1:20	2;20	106-23664	American Academy	4 Aces
12:40	1:40	2:40	106-83766	Bear Canyon Elementary	The Weirder People
			Break		
1:20	2:20	10:00	106-82193	Bear Canyon Elementary	The Team With a Name
1:40	2:40	10:20	106-99187	Fort Logan Northgate	Da Boiz
2:00	3:00	10:40	106-93399	Stone Mountain Elementary	2 Double AA's Required
2:20	3:20	11:20	106-64876	Fort Logan Northgate	Project Ace
2:40	3:40	11:40	106-13757	Platte River Academy	Flying Goats
3:00	4:00	12:00	106-57335	Goddard Middle School	Marshmallow Bears 2.0



## Fine Arts Challenge

- Create and present a story that features an unseen character and its impact on a team-selected photograph.
- Theatrically recreate the photograph during the Presentation.
- Create and present a visual effect that includes a photographic technique.
- Show how the visual effect changes the perspective of one or more characters.
- Create and present two Team Choice Elements that show off the team's interests, skills, areas of strength, and talents.

### Location: Main Level – West Wing

Performance Time	Instant Challenge Time	Team Number	School	Team Name
1:00	2:20	106-42187	Roxborough Intermediate	The 3 for 3 B. C. B. meal
1:20	2:40	106-96394	Stone Mountain Elementary	Nacho Cheese Balls
Break				
2:00	3:00	106-44996	Kent Denver School	The DI-namite Squad
2:20	3:20	106-99245	Ranch View Middle School	Neil A
Break				
3:00	12:40	106-13051	Highlands Ranch/Skyview/STEM	Decodables



**Reminder!**  
**Teams and Team Managers Only**  
**in Instant Challenge**  
**Parents and Supporters should wait**  
**for their teams in the Cafeteria.**





## Improv Challenge Elementary Level

- Research superpowers and how they are portrayed in comic books, literature, film, and other media.
- Create and present an improvisational skit about a villain who uses a superpower to cause an unexpected situation.
- Include a hero who uses an underwhelming power to try to overcome the unexpected situation.
- Enhance the skit with sounds effects.

### Location: Main Level - West Wing

Performance Time	Instant Challenge Time	Team Number	School	Team
9:00	10:00	106-24550	Runyon Elementary	Flying Penguins
9:20	10:20	106-77115	St. Mary's Academy	DooDooDooDooDooDoo
9:40	10:40	106-63676	Mark Twain Elementary	ROCKY FISH
10:00				
10:20	11:20	106-58321	Wilder Elementary	Hold Up
10:40	11:40	106-36235	Northridge Elementary	The Yummy Bananas
11:00	12:00	106-70106	Runyon Elementary	The Golden Nighttime Ninjas
11:20	12:20	106-70590	Cougar Run Elementary	The Improvisors

**Dance Party begins at 4:00 pm in the Gym.**  
**Awards Ceremony begins at 5pm or when scores are completed.**





## Improv Challenge Middle & Secondary Levels

- Research superpowers and how they are portrayed in comic books, literature, film, and other media.
- Create and present an improvisational skit about a villain who uses a superpower to cause an unexpected situation.
- Include a hero who uses an underwhelming power to try to overcome the unexpected situation.
- Enhance the skit with sounds effects.

### Location: Lower Level – Dance Room

Performance Time	Instant Challenge Time	Team Number	School	Team Name
10:00	11:20	106-19595	Goddard / Mackintosh	Parachuting Smarty Turkeys in a
10:20	11:40	106-67350	Platte River Academy	Pink Panthers
10:40	12:00	106-17744	Fort Logan Northgate	Netflix
Break				
11:20	1:20	106-36888	Euclid/ Powell Middle School Team	Flaming Hot Cacti
11:40	1:40	106-17345	Mountain Ridge Middle School	Light Switch
12:00	2:20	106-80382	Ben Franklin Academy	Fantastic Fajitas...We're Spicy!
12:20	2:00	106-54517	Ranch View Middle School	It's A Tie
12:40	11:20	106-19595	Goddard / Mackintosh	Parachuting Smarty Turkeys in a
Lunch				
1:40	11:00	106-25758	Ben Franklin Academy	SSSSTT-SuperSillyous Serendipito
2:00	11:20	106-13724	Miami Yoder High School	Flaming Hot Flamingoes
2:20	11:40	106-52014	Miami Yoder High School	The McMafia
2:40	12:00	106-41870	ThunderRidge High School	Conundumb and Dumbers

## Service Learning Challenge



- Identify, design, carry out, and evaluate a project that addresses a need in a real community.
- Create and present a story that shows at least one character in a race against time.
- Integrate information about the project into the story.
- Design and build a device that represents time and highlights milestones from the project.
- Create and present two Team Choice Elements that show off the team's interests, skills, areas of strength, and talents.

### Location: Upper Level - East Wing

Performance Time	Instant Challenge Time	Team Number	School	Team Name
9:00	10:00	106-12369	Wilder Elementary	Blue Thunder Wolves
9:20				
9:40	1:00	106-11951	Bear Canyon Elementary	The Six Chix
10:00	1:20	106-12787	Mountain Ridge Middle School	The Deloreans
10:20	1:40	106-90376	Goddard Middle School	DI 4 Food
10:40				
11:00	12:20	106-32270	Englewood & Thomas Jefferson High Schools	There Was An Attempt

# Rising Stars Challenge



- Create and present a play about characters who travel from one planet to another.
- Include something surprising that happens during the trip.
- Design and create a puppet to use in the play.
- Launch team-created rockets during the play.
- Create costumes, props, and scenery to help tell the story.

## Location: Main Level – East Wing

Performance Time	Team Number	School	Team Name
10:00	106-80939	Wilder Elementary	Planageers
10:20	106-27549	Redstone Elementary	Team Rocket
10:40	106-00020	St. Mary's Academy	Heroic Explorers
Break			
11:20	106-46989	St. Mary's Academy	MNCJ
11:40	106-96795	Skyview Academy	Cheetah Superstars
12:00			
1:00	106-89428	Runyon Elementary	The Super Stars
1:20	106-23098	St. Mary's Academy	The Universe Cupcakes
1:40	106-73937	St. Mary's Academy	JAZing Koalas
Break			
2:20	106-60657	Skyview Academy	Team Cupcake
2:40	106-66058	Good Shepherd Catholic School	DI Dinosaurs
3:40	106-26867	Runyon Elementary	Space Animals
4:00	106-62212	Stone Mountain Elementary	Space Tigers

**Rising Stars Instant Challenge Takes Place Immediately After Team Performance**

Street Parking



Main Level

Upper Level

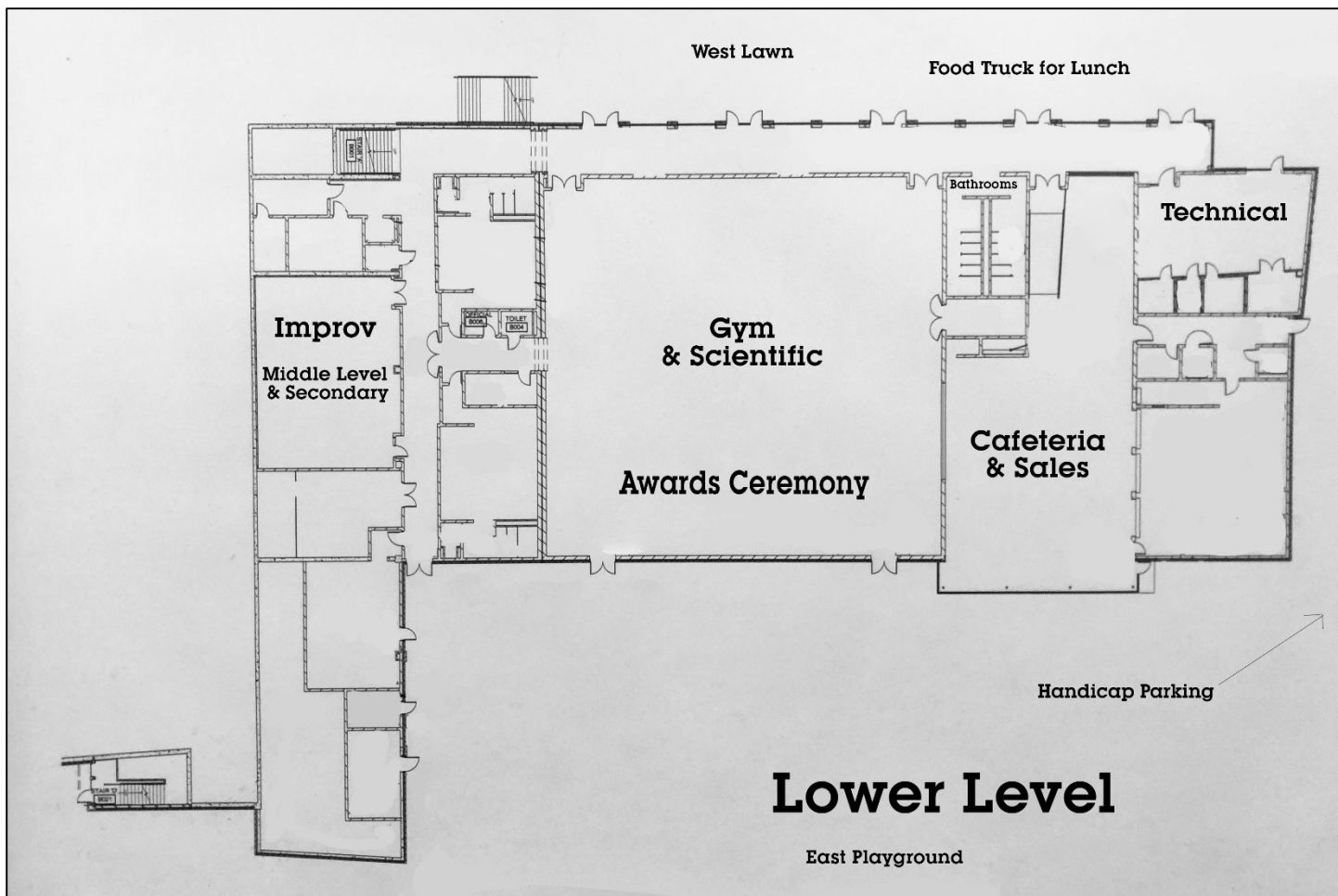

**Reminder!**  
**Teams and Team Managers Only**  
**in Instant Challenge**  
**Parents and Supporters should wait**  
**for their teams in the Cafeteria.**

# DI Store

**South Metro T-Shirts      \$17**

**Pins:**

**Ice Cream Truck      \$ 6**

**Orange Creamsicle      \$ 5**

**Triple Cone      \$ 5**

**Ice Cream Soda      \$ 5**

**Hot Fudge Sundae      \$ 5**

**Snow Cone      \$ 5**

**Zebra Pin      \$ 5**

**Drinks/Snacks/Candy      \$ 1**

**Dance Party Light Ups      \$ 3 - \$10**

**Light ups sold only at Dance Party**

**Cash, checks and credit cards accepted.**