

FOR LEASE

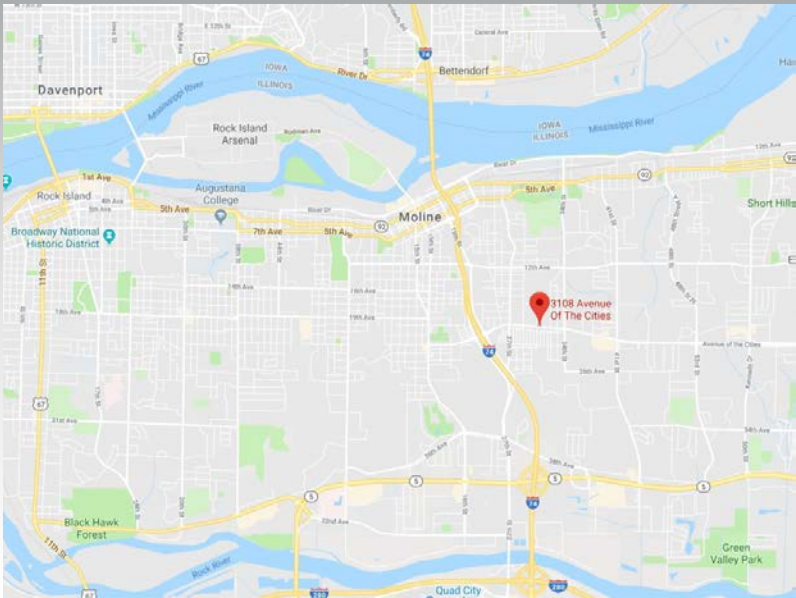

1,000 SF Office/Retail Space
3108 Avenue of the Cities, Moline, IL 61265

TheHawkeyeGroup.com



Property Features

- **Lease Price: \$1,000/Mo Modified Gross**
- **Space Size: 1,000 SF**
- Ideal office or retail space with 2 display windows, exceptional traffic, and visibility
- Space includes 3 offices plus reception area/waiting room and could be reconfigured for different use types
- Façade improvements scheduled for Spring 2019
- Quick access to the I-74 corridor

David Sountris | 309.236.2171
dsountris@TheHawkeyeGroup.com



HAWKEYE
COMMERCIAL REAL ESTATE

1850 E. 53rd Street, Suite #1 • Davenport, Iowa 52807 • Office: 563.344.4295 • www.TheHawkeyeGroup.com

NO WARRANTY OR REPRESENTATION, EXPRESS OR IMPLIED, IS MADE AS TO THE ACCURACY OF THE INFORMATION CONTAINED HEREIN, AND THE SAME IS SUBMITTED SUBJECT TO ERRORS, OMISSIONS, CHANGE OF PRICE, RENTAL OR OTHER CONDITIONS, PRIOR SALE, LEASE OR FINANCING, OR WITHDRAWAL WITHOUT NOTICE, AND OF ANY SPECIAL LISTING CONDITIONS IMPOSED BY OUR PRINCIPALS. NO WARRANTIES OR REPRESENTATIONS ARE MADE AS TO THE CONDITION OF THE PROPERTY OR ANY HAZARDS CONTAINED THEREIN ARE ANY TO BE IMPLIED. BROKERS ARE LICENSED IN IOWA & ILLINOIS

Revised 9/19/2019

1,000 SF Office/Retail Space

3108 Avenue of the Cities, Moline, IL 61265

TheHawkeyeGroup.com

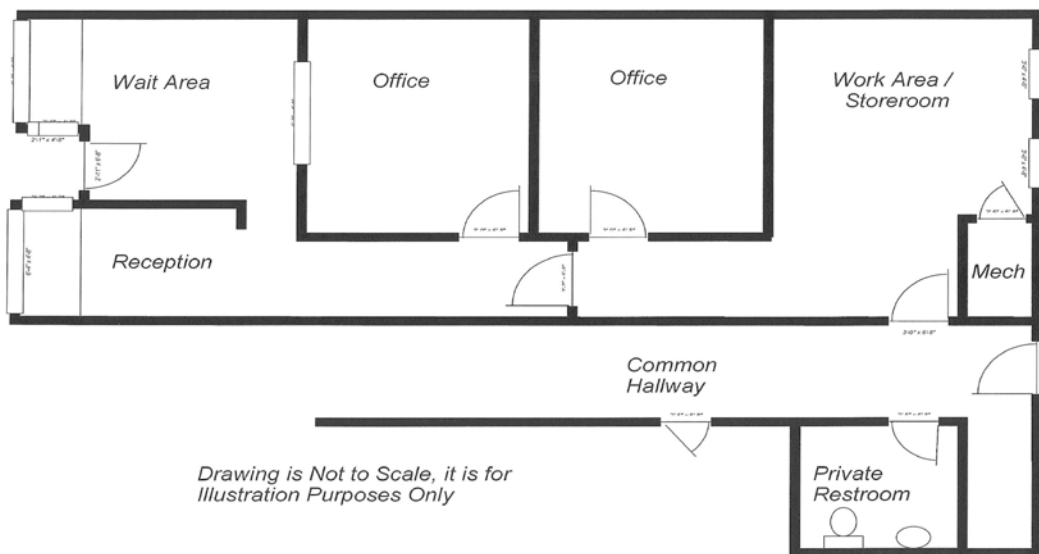

David Sountris | 309.236.2171
dsountris@TheHawkeyeGroup.com



1850 E. 53rd Street, Suite #1 • Davenport, Iowa 52807 • Office: 563.344.4295 • www.TheHawkeyeGroup.com

NO WARRANTY OR REPRESENTATION, EXPRESS OR IMPLIED, IS MADE AS TO THE ACCURACY OF THE INFORMATION CONTAINED HEREIN, AND THE SAME IS SUBMITTED SUBJECT TO ERRORS, OMISSIONS, CHANGE OF PRICE, RENTAL OR OTHER CONDITIONS, PRIOR SALE, LEASE OR FINANCING, OR WITHDRAWAL WITHOUT NOTICE, AND OF ANY SPECIAL LISTING CONDITIONS IMPOSED BY OUR PRINCIPALS. NO WARRANTIES OR REPRESENTATIONS ARE MADE AS TO THE CONDITION OF THE PROPERTY OR ANY HAZARDS CONTAINED THEREIN ARE ANY TO BE IMPLIED. BROKERS ARE LICENSED IN IOWA & ILLINOIS