

GENERAL NOTES:

THIS WORK CONSISTS OF THE MAINTENANCE OF TRAFFIC AND THE PROTECTION OF THE TRAVELING PUBLIC APPROACHING THE CONSTRUCTION AREA AND WITHIN THE LIMITS OF CONSTRUCTION.

THE DETOUR WILL BE REQUIRED FOR AN UNDETERMINED AMOUNT OF TIME.

CONTACT PENNDOT PRESS OFFICE 15 DAYS BEFORE START OF DETOUR AT 610-871-4555.

CONTACT LOCAL SCHOOL DISTRICT, AND EMERGENCY OFFICIALS (POLICE, FIRE, AMBULANCE) 15 DAYS BEFORE START OF DETOUR.

PLACE ADVANCE NOTICE "SIGN 98" TWO WEEKS PRIOR TO BRIDGE CLOSURE.

FURNISH, ERECT, PLACE AND MAINTAIN TRAFFIC CONTROL SIGNS AND DEVICES AND MAINTAIN TRAFFIC DURING HOURS OF CONSTRUCTION AND AT ALL OTHER TIMES IN ACCORDANCE WITH THIS PLAN AND THE LATEST EDITION OF THESE PUBLICATIONS:

1. THE SPECIAL PROVISIONS OF THE CONTRACT
2. PENNDOT PUB. 212, OFFICIAL TRAFFIC CONTROL DEVICES (SUBCHAPTER E)
3. PENNDOT PUB. 111, TRAFFIC CONTROL-PAVEMENT MARKING AND SIGNING STANDARDS
4. PENNDOT PUB. 213, TEMPORARY TRAFFIC CONTROL GUIDELINES
5. PENNDOT PUB. 35, APPROVED CONSTRUCTION MATERIALS (BULLETIN 15)
6. PENNDOT PUB. 408, SPECIFICATIONS
7. PENNDOT PUB. 46, TRAFFIC ENGINEERING MANUAL
8. PENNDOT PUB. 236, HANDBOOK OF APPROVED SIGNS
9. MANUAL ON UNIFORM TRAFFIC CONTROL DEVICES (MUTCD)

MAINTAIN ACCESS TO ALL DRIVEWAYS (COMMERCIAL AND RESIDENTIAL) AT ALL TIMES THROUGHOUT THE DURATION OF THE PROJECT.

SIGN SPACING SHALL BE IN ACCORDANCE WITH PENNDOT PUB. 213, PATA FIGURE 216, DETOUR OF A NUMBERED TRAFFIC ROUTE. ALL DISTANCES MAY BE ADJUSTED TO MEET FIELD CONDITIONS. THE ADJUSTMENTS ARE TO BE REVIEWED WITH THE BERKS COUNTY BRIDGE ENGINEER PRIOR TO THE RELOCATION OF THE SIGNS OR BARRICADES.

COVER OR REMOVE ALL SIGNS NOT IN USE OR IN CONFLICT WITH THE PROPOSED TRAFFIC CONTROL PLAN.

IMMEDIATELY UPON COMPLETION OF THE WORK, REMOVE ALL TRAFFIC CONTROL DEVICES. THE DEPARTMENT WILL REMOVE ANY TRAFFIC CONTROL DEVICES ERECTED BY DEPARTMENT FORCES.

ALL SIGNS ARE TO BE REFLECTORIZED OR ILLUMINATED DURING HOURS OF DARKNESS.

SIGN PLACEMENT AND CONDITION SHOULD BE EVALUATED AND CORRECTED AFTER EVERY STORM EVENT, IN THE EVENT OF A KNOCKDOWN.

DISTRICT	COUNTY	ROUTE	SECTION	SHEET
6-0	MONTGOMERY	7046	145	1 OF 1
LOWER SALFORD TOWNSHIP				
REVISION NUMBER	REVISIONS	DATE	BY	

SIGN TABULATION
INCLUDED IN ITEM NO. 0901-0001

SIGN GROUP NUMBER	SERIES	QUANTITY	SIZE	MESSAGE
1	R11-2-1	2	48"x30"	BRIDGE CLOSED
2	M4-8A	2	24"x18"	END DETOUR
	SPECIAL 1	2	24"x18"	ROBERTS ROAD
3	M4-9S	5	30"x24"	DETOUR, STRAIGHT
	SPECIAL 1	5	24"x18"	ROBERTS ROAD
4	M4-9SR	2	30"x24"	RIGHT ADVANCE DETOUR
	SPECIAL 1	2	24"x18"	ROBERTS ROAD
5	M4-9R	2	30"x24"	DETOUR, RIGHT
	SPECIAL 1	2	24"x18"	ROBERTS ROAD
6	M4-9SL	2	30"x24"	LEFT ADVANCE DETOUR
	SPECIAL 1	2	24"x18"	ROBERTS ROAD
7	M4-9L	2	30"x24"	DETOUR, LEFT
	SPECIAL 1	2	24"x18"	ROBERTS ROAD
13	W20-2/W30-1-3	2	36"x36"	ADVANCE DETOUR, 1500 FT.
	SPECIAL 1	2	24"x18"	ROBERTS ROAD
14	W20-2/W30-1-2	2	36"x36"	ADVANCE DETOUR, 1000 FT.
	SPECIAL 1	2	24"x18"	ROBERTS ROAD
15	W20-3/W30-1-2	1	36"x36"	ROAD CLOSED, 1000 FT.
	SPECIAL 1	1	24"x18"	ROBERTS ROAD
16	W20-3/W30-1-1	1	36"x36"	ROAD CLOSED, 500 FT.
	SPECIAL 1	1	24"x18"	ROBERTS ROAD
97	R11-3A/W30-1-5	1	60"x30"	ROAD CLOSED, 1 MILE AHEAD, LOCAL TRAFFIC ONLY
99	W23-101	2	60"x30"	ROBERTS ROAD CLOSED, OVER SKIPPACK CREEK, FOLLOW DETOUR
B	M4-10L	1	48"x18"	DETOUR ARROW LEFT

MINIMUM MATERIAL REQUIRED
(FOR INFORMATION ONLY)

DESCRIPTION	QUANTITY	UNITS
POST MOUNTED SIGNS	335.5	S.F.
TYPE B LIGHTS	24	EACH
TYPE III BARRICADES	15	EACH

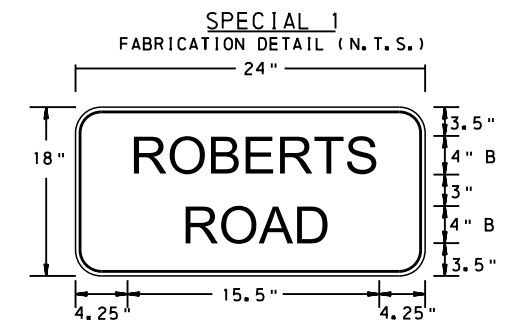

BACKGROUND - ORANGE (REFLECTIVE)
LEGEND - BLACK (NON-REFLECTIVE)

4" CAP B SERIES	4" CAP B SERIES
R - 4.25	R - 7.45
O - 2.3	O - 2.3
B - 2.6	O - 2.4
E - 2.4	A - 2.7
R - 2.1	D - 1.7
T - 2.3	7.45
S - 2.1	
	L = 24.0
	L = 24.0

RECOMMENDED: _____
DISTRICT TRAFFIC ENGINEER

LEGEND

- STATE HIGHWAY
- TOWNSHIP ROAD
- MUNICIPAL BOUNDARY
- STREAM
- VEHICULAR DETOUR
- RAILROAD
- BRIDGE LOCATION
- SIGN
- SIGN GROUP NUMBER
- TYPE B FLASHER
- TYPE 3 BARRICADE

LOCATION MAP

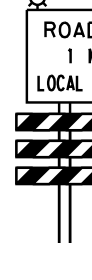
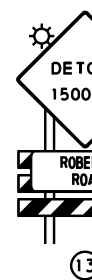
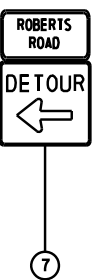
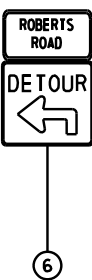
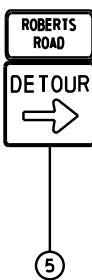
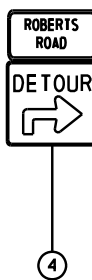
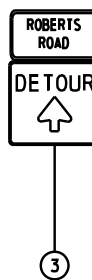
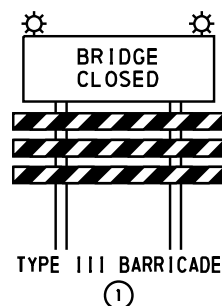

TRAFFIC CONTROL PLAN