

Creating a Parent Account in NutriSlice Ordering

Open the NutriSlice.com webpage or the app. When parents are creating their account, they will click  and select "Log In." Choose to "Create an Account."

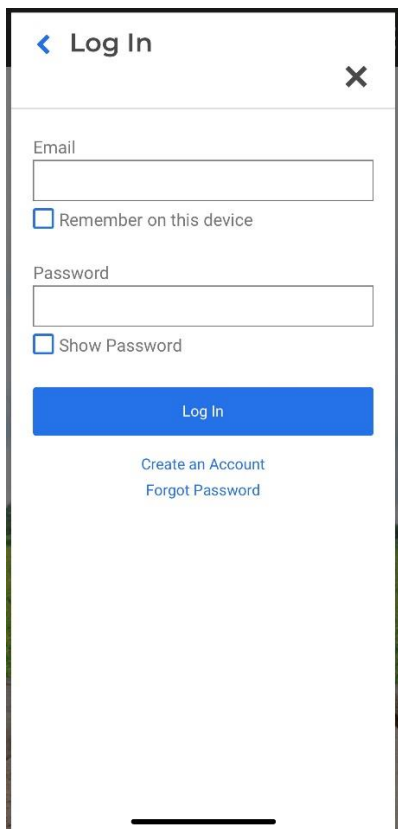

Click on "Parent" and then "Next"

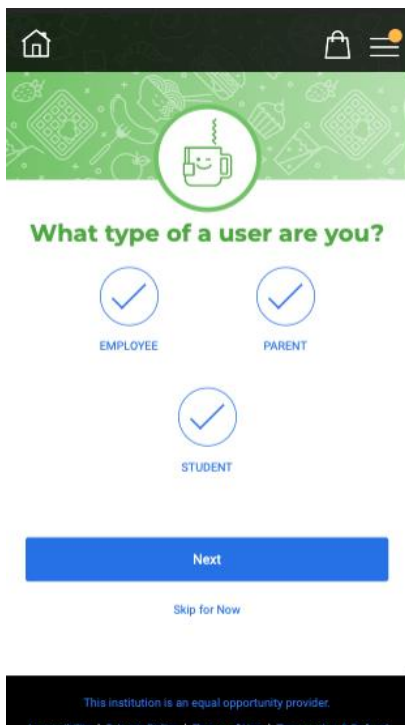

Once the "Parent" account type is selected, you will be presented with the fields you configured for Students. You can add multiple students.

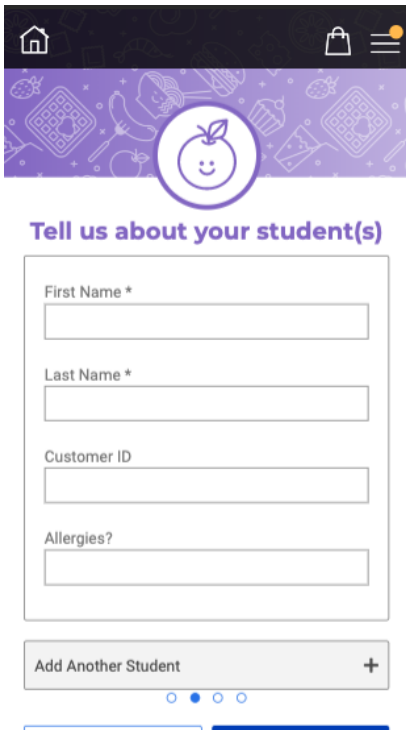

The screenshot shows a mobile application interface with a purple header. At the top, there are icons for home, a shopping bag, and a menu. Below the header is a decorative banner with a purple background and white icons of various food items. In the center of the banner is a circular icon of a smiling orange. Below the banner, the text "Tell us about your student(s)" is displayed in a bold, purple font. The form contains four input fields: "First Name *" (with an asterisk), "Last Name *" (with an asterisk), "Customer ID", and "Allergies?". Below these fields is a button labeled "Add Another Student" with a plus sign icon. At the bottom of the form, there are four small circles, with the second one from the left being filled with blue, indicating the current step in a sequence.

The next page will show the fields for the parent's information.



The screenshot shows a mobile application interface with a teal header. At the top, there are icons for home, a shopping bag, and a menu. Below the header is a decorative banner with a teal background and white icons of various food items. In the center of the banner is a circular icon of a smiling bowl of ramen. Below the banner, the text "Tell us about yourself" is displayed in a bold, teal font. The form contains three input fields: "First Name *" (with an asterisk), "Last Name *" (with an asterisk), and "Phone Number *" (with an asterisk). Below these fields are four small circles, with the third one from the left being filled with blue, indicating the current step in a sequence. At the bottom of the form, there are two buttons: "Previous" and "Next". Below the buttons, the text "Skip for Now" is displayed.

Finally, you will be prompted to enter your email address and set a password.



You're almost done!

Email Address

Password

Password must be a minimum of 10 mixed-case characters, including 1 number or special character.

Confirm Password

This site is protected by reCAPTCHA and the Google Privacy Policy and Terms of Service apply.



Previous

Finish

Skip for Now