



Copley Center

200 E Golf Rd
Schaumburg, IL 60173



Jose Gonzalez
Executive Vice President
+1 312 228 2155
jose.o.gonzalez@jll.com

Courtney Rouleau
Vice President
+1 312 228 3431
courtney.rouleau@jll.com



Property overview & demographics

- Second generation restaurant end cap space available
- Copley Center benefits from its outstanding visibility and strong traffic counts with approximately 28,200 cpd on Golf Road, and 33,000 on Roselle Road

- Schaumburg features the largest retail corridor in the state of Illinois outside of the city of Chicago and is anchored by the super-regional Woodfield Mall. This retail corridor includes approximately 6.8 million square feet of retail GLA with representation by virtually every major national and regional retailer

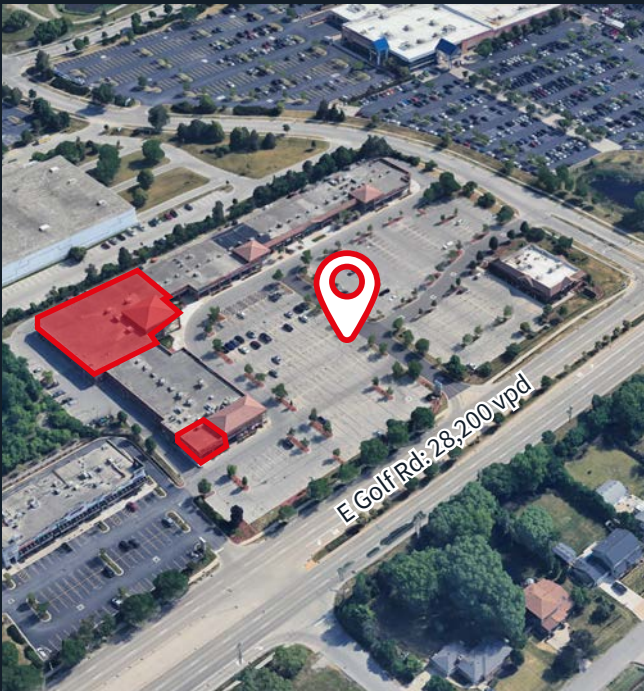

Address	200 E Golf Rd Schaumburg, IL 60173
Size	2,556 – 20,598 SF
Asking price	Upon request
Status	Available
Possession	Currently occupied <i>Do not disturb tenant</i>

Co-tenants/area retailers



	1 mile	3 miles	5 miles
Population	13,468	97,026	250,576
Daytime population	17,964	131,128	297,358
Avg household income	\$93,363	\$123,204	\$126,673
Households	5,428	37,849	97,316

Site plan

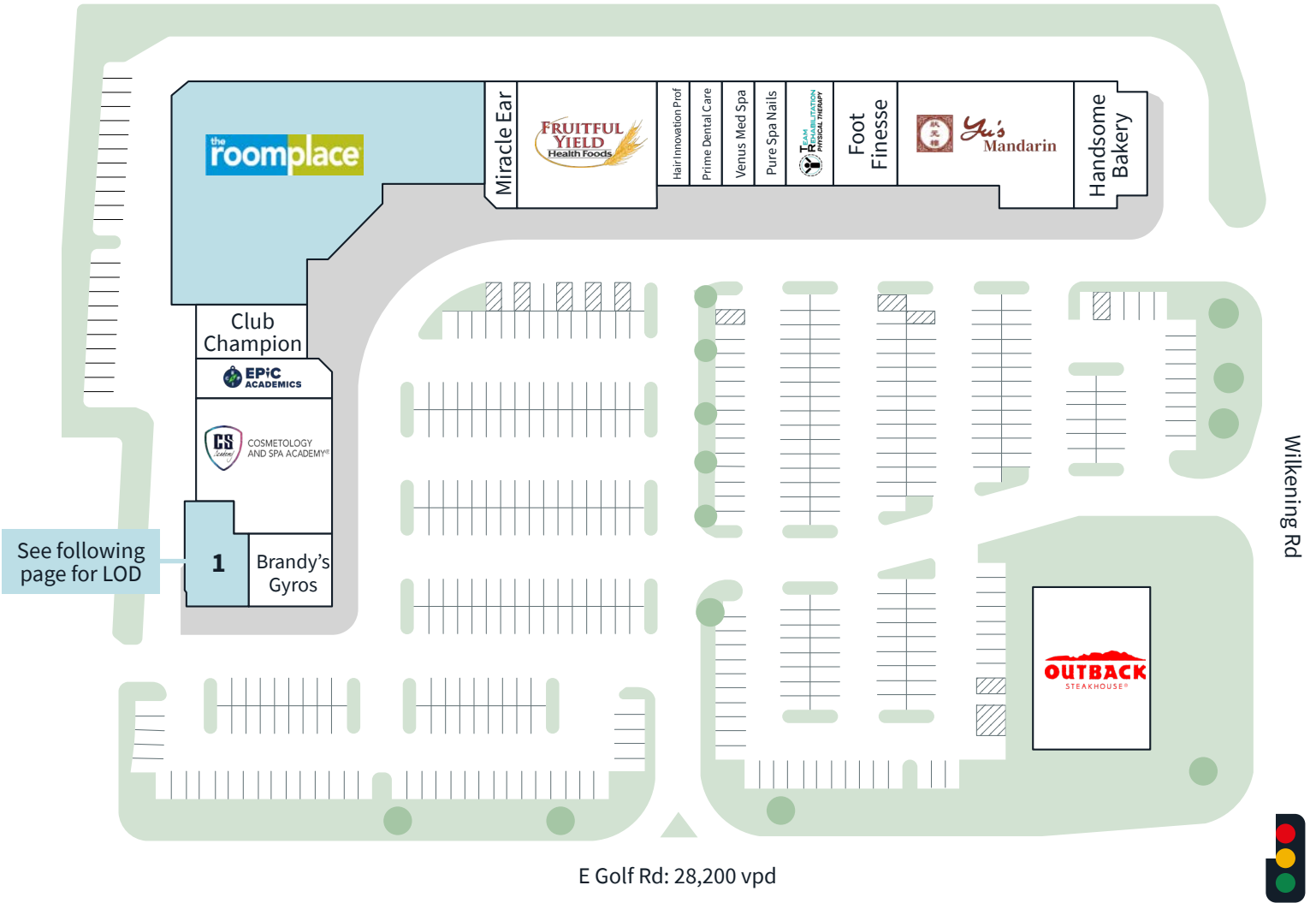

Unit	Tenant	SF
1	Second Generation Restaurant Available	2,556
1B	Brandy's Gyros	2,562
6	Cosmetology Spa Institute	5,938
6C	Epic Academics	2,095
7	Club Champion	2,480
9	The Room Place (tenant in bankruptcy)	20,598
12	Miracle Ear	1,420
13	Fruitful Yield	7,257

Unit	Tenant	SF
18	Hair Innovation Prof	2,418
19	Prime Dental Care	1,123
21	Pure Nail Spa	1,123
22	Venus Med Spa	1,156
23	Team Rehab PT	2,380
25	Foot Finesse	2,380
27	Yu's Mandarin	7,927
34	Handsome Bakery	2,663
Total GLA		69,076



Space plan

2,556 SF available – do not disturb tenant

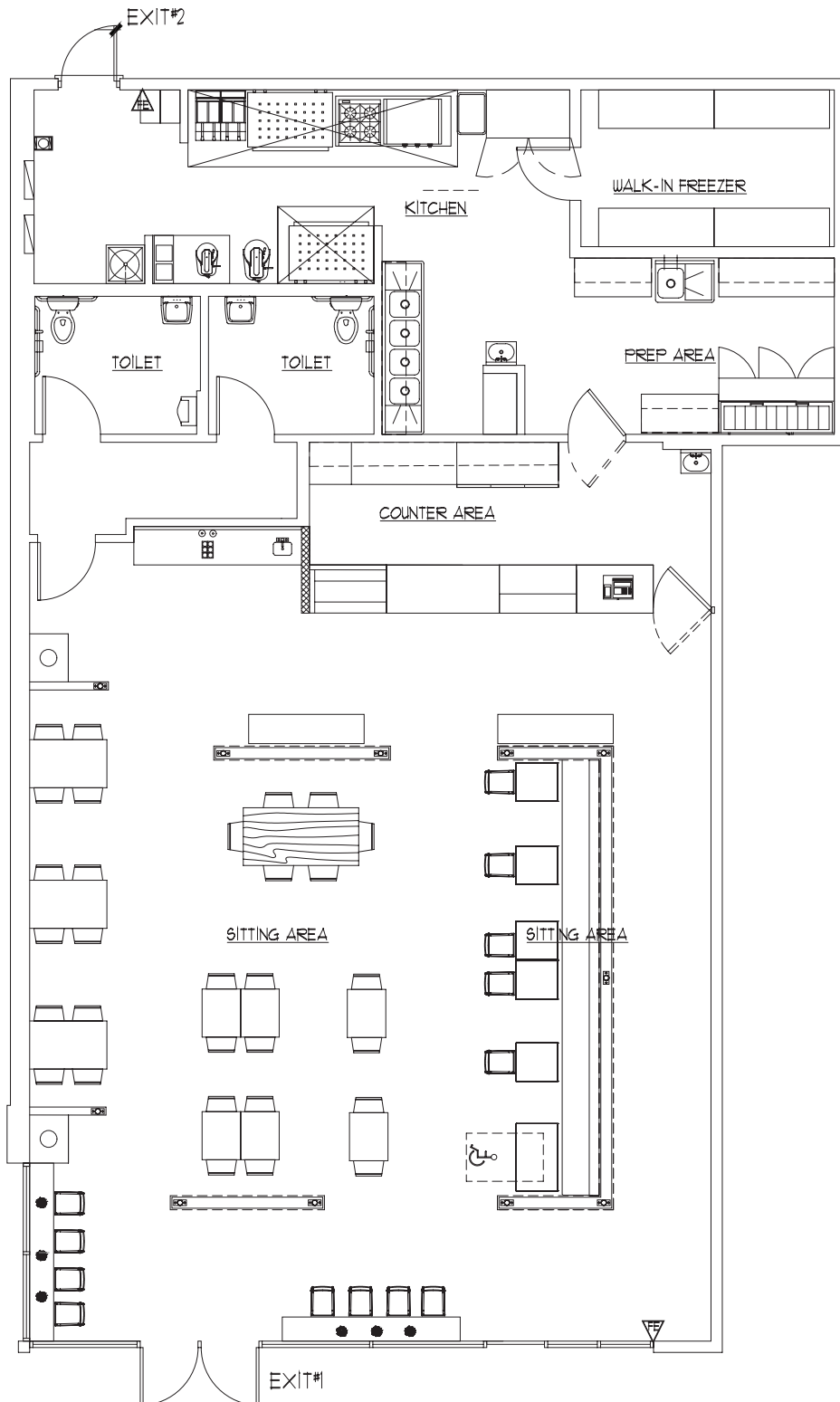

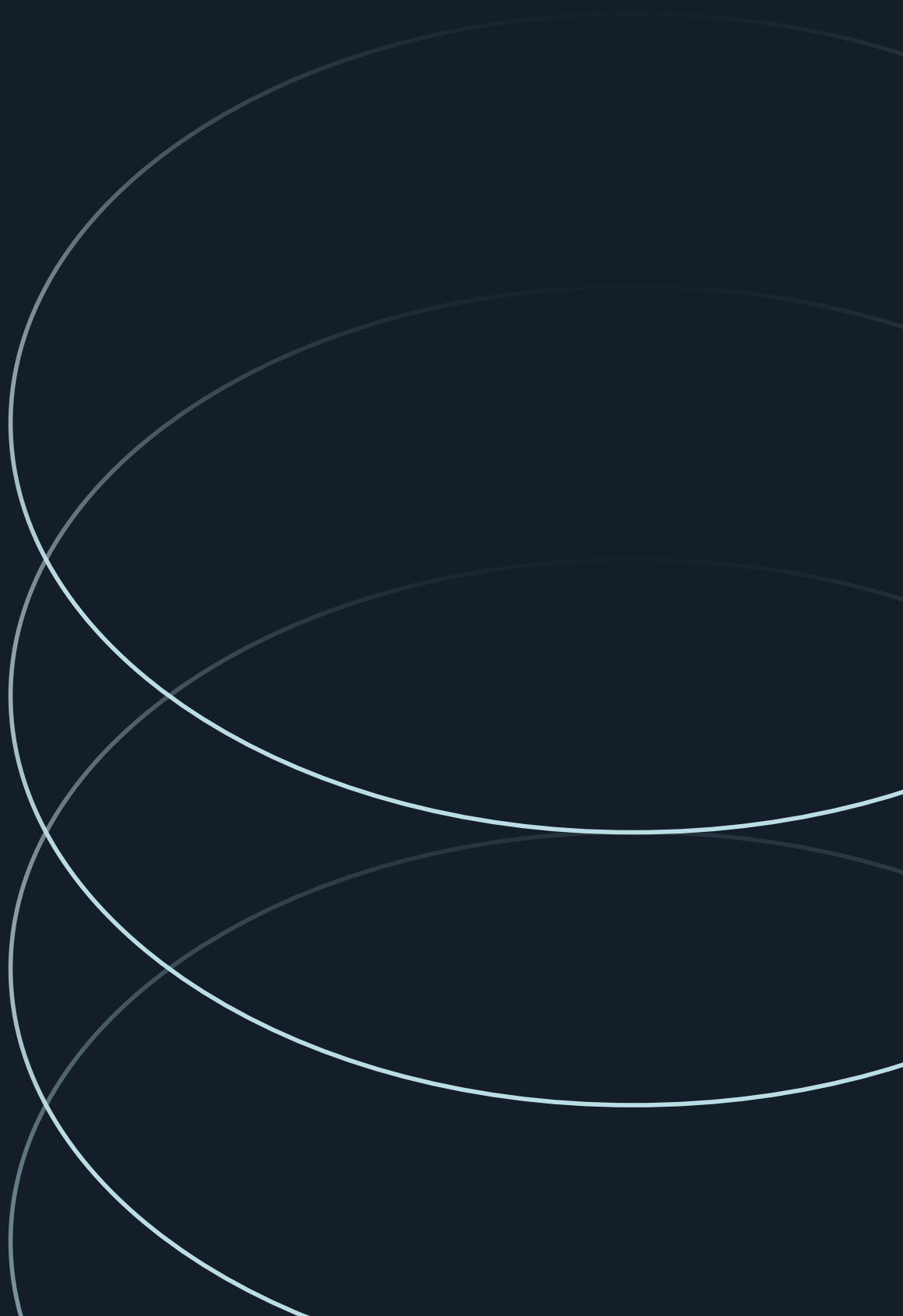

Jose Gonzalez

Executive Vice President

+1 312 228 2155

jose.o.gonzalez@jll.com

Courtney Rouleau

Vice President

+1 312 228 3431

courtney.rouleau@jll.com