

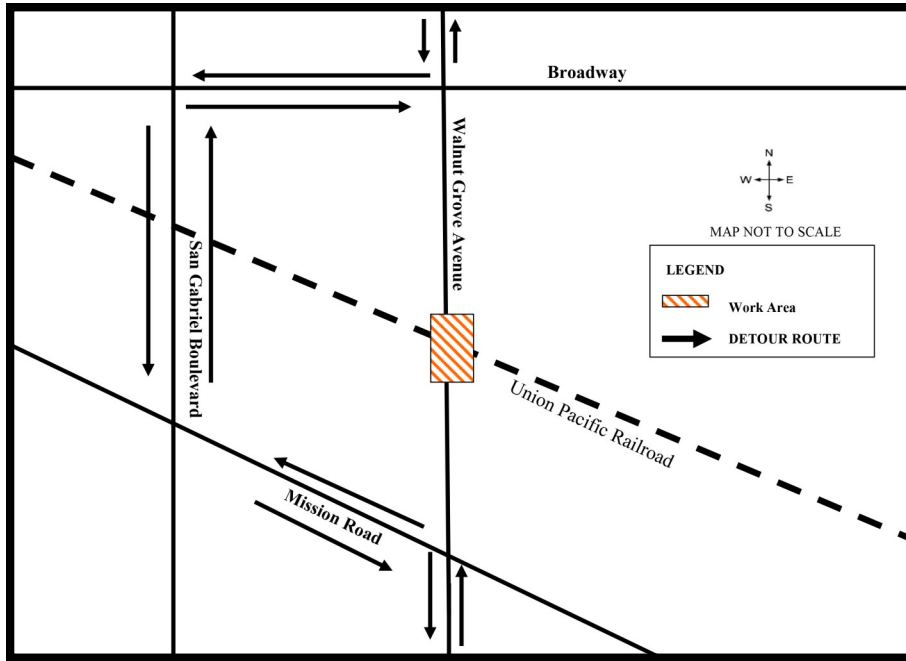

UPDATED DETOUR**CONSTRUCTION ALERT** WALNUT GROVE AVENUE RAILROAD CROSSING TO BE CLOSED FOR CONSTRUCTION



WHAT

Alameda Corridor-East Construction Authority (ACE) contractor will close the Walnut Grove Avenue railroad crossing to lower the roadway, relocate and rewire railroad signals, install new mainline track and road panels, and perform related paving work.

WHAT TO EXPECT/WHEN

Northbound and southbound traffic lanes will be closed to vehicular traffic at the railroad crossing on Walnut Grove Avenue beginning Monday, February 27, 2017 through Friday, March 24, 2017. Pedestrian access will not be permitted from approximately March 6th to March 10th. Motorists and pedestrians should use San Gabriel Boulevard as a detour (see map above) and are urged to exercise caution while in the vicinity of the construction area. Most work will occur between 7 a.m. and 4 p.m. Noise, dust and vibration will be monitored for compliance with applicable limits.

RECOMMENDED DETOUR ROUTE

From northbound Walnut Grove Avenue: Turn left onto Mission Road and proceed west toward San Gabriel Boulevard. Turn right onto San Gabriel Boulevard, proceed north, and turn right on Broadway. Turn left onto Walnut Grove Avenue and proceed north. **From southbound Walnut Grove Avenue:** Turn right onto Broadway and proceed west toward San Gabriel Boulevard. Turn left onto San Gabriel Boulevard, proceed south, and turn left on Mission Road. Turn right onto Walnut Grove Avenue and proceed south.

Para información o preguntas, por favor llame al teléfono directo o visite el sitio web en:

如有疑問或需要索取工程最新資料，請致電輔助熱線或參閱工程網頁

**For the most up-to-date information or questions, please call or visit:
(888) ACE-1426 (Available 24/7) or www.theaceproject.org**

In case of an emergency, please contact 9-1-1

Thank you for your patience and cooperation...At ACE, it's Safety First!

*Note: Construction is a dynamic process and information is subject to change without notice.
Work activity is subject to weather conditions.*