

21-613 HANOVER NORTH ROLLINS

Weekly Site Photos
Week Ending
6/2/2023



Existing Site Plan

Building Layout

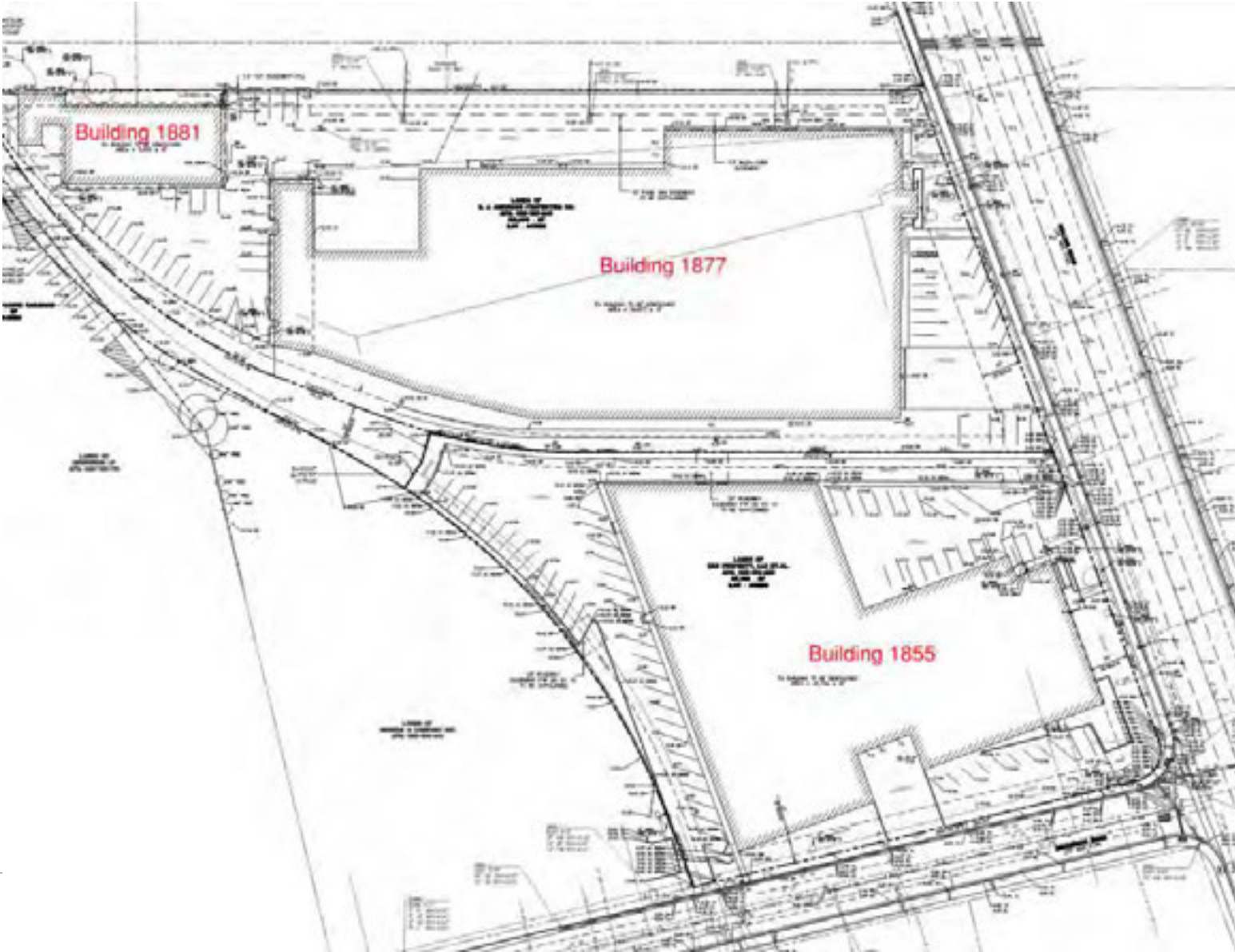

21-613 Hanover North Rollins
Weekly Site Photos
Week Ending
6/2/2023

Drone Photo 1

Elevation from Rollins Road

21-613 Hanover North Rollins
Weekly Site Photos
Week Ending
6/2/2023



Drone Photo 2

Elevation from Broderick Road

21-613 Hanover North Rollins
Weekly Site Photos
Week Ending
6/1/2023



Fencing

Fencing complete around perimeter of site



21-613 Hanover North Rollins
Weekly Site Photos
Week Ending
6/2/2023



Abatement

Abatement mobilized with work ongoing

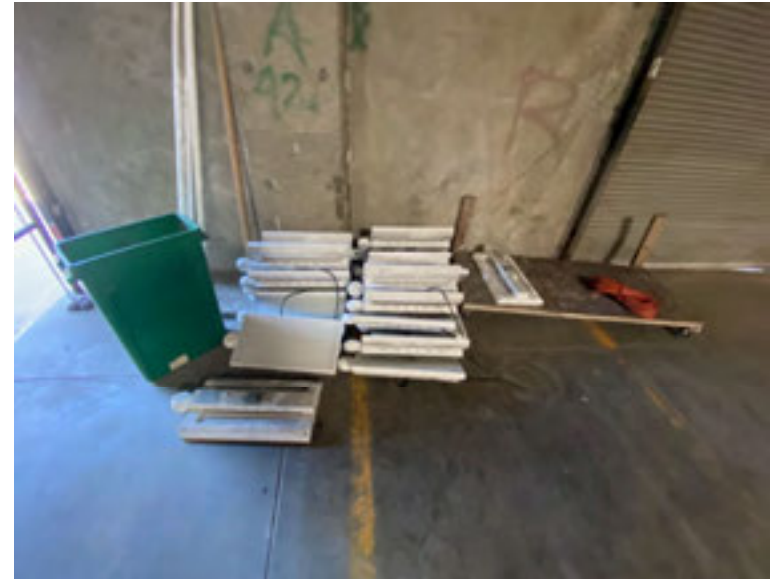

21-613 Hanover North Rollins
Weekly Site Photos
Week Ending
6/1/2023

Water Disconnect

City disconnected all water services

21-613 Hanover North Rollins
Weekly Site Photos
Week Ending
6/1/2023



Demo Permit

Received to begin Demo

21-613 Hanover North Rollins
Weekly Site Photos
Week Ending
6/1/2023

301 PRIMROSE ROAD, BURLINGAME, CA 94010

BURLINGAME

CITY OF BURLINGAME

BUILDING PERMIT

PERMIT NO. 022-0624

DATE 05/31/2023

NUMBER	1855	STREET	ROLLINS RD	APN	025166230
APPLICANT	HANOVER CO. - BILL VENNARUCCI			PHONE	
STREET ADDRESS					
CITY		STATE	TX	ZIP	
NAME OF OWNER	HANIMPUV NORTH ROLLINS BURLINGAME CA LLC			PHONE	
CONTRACTOR	HANOVER R S CONSTRUCTION LLC			PHONE	(713)267-2100
ADDRESS	1790 S POST OAK LANE				
CITY	HOUSTON	STATE	TX	ZIP	77056
ARCHITECT	BOE ARCHITECTURE			LICENSE	C80E
ADDRESS	950 HOWARD ST	CITY	SAN FRANCISCO	STATE	CA ZIP 94103
ENGINEER	BKF ENGINEERS			LICENSE	C80E
ADDRESS	255 SHORELINE DR SUITE 200	CITY	REDWOOD CITY	STATE	CA ZIP 94065

WORK DESCRIPTION: (7855-1881) EARLY DEMOLITION (see conditions attached)

PLEASE BE ADVISED THAT YOU ARE RESPONSIBLE FOR THE FOLLOWING:

Schedule Inspections: A minimum 24 hours advance notice is required.

Inspections are done Monday thru Friday 9 a.m. to noon and 1 p.m. to 4 p.m. please remember this may not guarantee you next day inspection. Inspections are on a first call basis and there are a given number of inspections allocated for each day.

Work not completed at the time of inspection will be assessed a reinspection fee.

Ensure that the job site is maintained in a safe condition and that all OSHA regulations are adhered to.

Maintain all erosion control methods as required by Public Works City Code Chapter 15.14 (Grading). Requires Stormwater Pollution Prevention Program (Control methods).

Ensure that your adult representative is at the job site to provide assistance and answer any questions regarding the project for all inspections.

Maintain all construction documents (approved plans, permit card) in a legible condition and ensure that they are at the job site for inspection.

Provide any and all equipment (ladders, lights, etc.) necessary to complete the inspection.

Installation instructions must be on site for rough mechanical and final inspections.

PRIOR TO FINAL INSPECTION:

1. Illuminated street address at front of building" visibility and legibility per BMC 18.08.015

2. When the permit valuation of a Group R1 Occupancy exceeds \$1,000, smoke detectors and carbon monoxide detectors shall be installed.

PERMIT VALUATION

PERMIT FEES

BUILDING

ELECTRICAL

PLUMBING

MECHANICAL

MICROFILM

SE/SMG

OTHER

TOTAL

\$625,000.00

\$12,215.87

\$0.00

\$0.00

\$0.00

\$320.81

\$175.00

\$341,852.75

\$354,564.43

NOTE:

THIS PERMIT DOES NOT INCLUDE ANY CONSTRUCTION WITHIN THE PUBLIC RIGHT OF WAY. ANY CONSTRUCTION IN THIS AREA REQUIRES A SEPARATE PUBLIC WORKS PERMIT.

EXPIRATION DATE

ISSUED DATE

PERMIT NUMBER

022-0624

12/02/2024

05/31/2023

INSPECTION REQUEST

buildinginspections@burlingame.org

or (415) 518-7260

8

HANOVER