

Watran **USA**



LED DRIVERS

CONTROL DEVICE



www.lightingandpowertech.com

LPTGroup

CONTROL DEVICE

Aluminum case

IP67



DALI dimming signal control device.

- Operating Voltage:DC12V-DC24V
- Signal input:DALI signal Signal Output:PWM signal
- All-digital circuit design, performance is more excellent.
- Protocol:IEC62386.
- Standard DALI logarithmic dimming curve, smooth dimming.

IP67

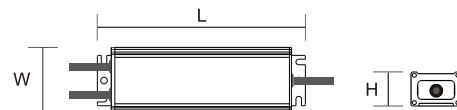

Model	Conversion Mode	Input	Output Current	Tol	Efficiency	LxWxH(mm)	Certification	Net Weight	Product Code
HQLST240/D12/D-P/D2	PWM	12~24VDC	20A Max.	±5%	≥90%	109x39.4x31.4	-	255g	-



DALI signal converter

- Input Voltage:100-277VAC
- Signal input:DALI dimming signal;signal output:0-10V/PWM;
- IP67 waterproof design, separately installation structure .
- All-digital circuit design.

IP67

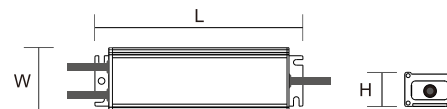

Model	Conversion Mode	Input	Output Current	Tol	Efficiency	LxWxH(mm)	Certification	Net Weight	Product Code
HQLST/123/D-P/D2	0-10V	100~277VAC	40mA Max.	±5%	≥90%	109x39.4x31.4	CCC	255g	2760299018
	PWM		20mA Max.	±5%					



Emergency Driver

- Emergency use for outage, time can be switched.
- Built-in circuit for the protection of the battery charging and discharging.
- Constant current driver or emergency battery can be turned on and off by external button.
- Emergency time period can be switched by external button.

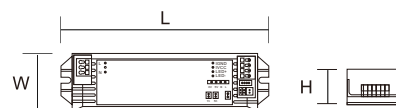

Power	Model	Input	Output Voltage (Emergency)	Output Current (Emergency)	Tol	LxWxH(mm)	Certification	Product Code
18W	HQLST/48/Y/A7	48VAC	24~36V	480mA	±5%	151x40x28	-	-
18W	HQLST/122/Y/A7	100~240VAC	24~36V	480mA	±5%	151x40x28	-	-

Product load connection mode

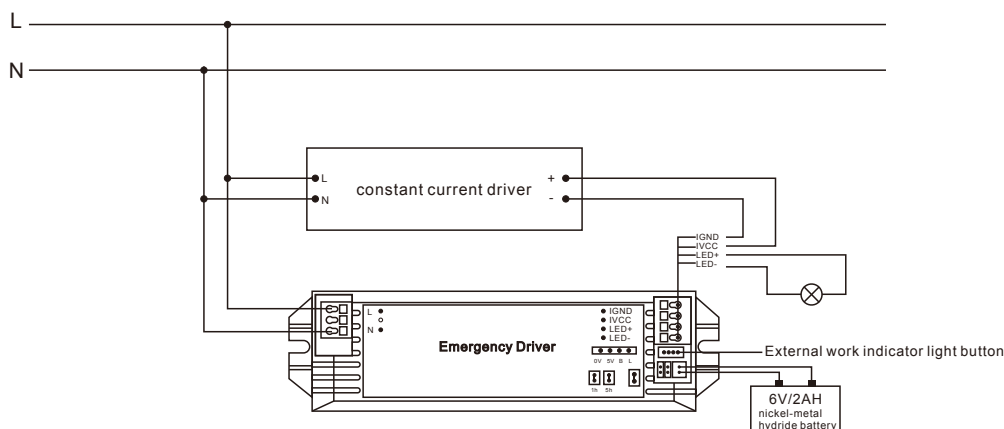

SURGE PROTECTION DEVICE

10KV(Surge protection of 10KV)

IP67

Product Feature

- International AC input voltage range : 100~277V
- Protection Grade:IP67, ageing-resistant wire.
- Separately installed structure. Apply to indoor or outdoor.
- L-FG,N-FG, L-N Protection function.
- Natural air cooling.
- Apply to protection of LED driver.

Electrical Parameter

Input Voltage Range	100~277VAC	Starting Time	<25ns
Max surge Voltage (Uoc)	10KV	Withstand Voltage	1500VAC 1min
Voltage protective(Up)	L-N:1.6KV; L-N-FG:2.5KV	Working Temp(Ta)	-40°C~+85°C
Standard discharge current(In)	5KA	Safety Standards	EN61643-11
Max surge current(I _{max})	10KA	Size	89x39.4x31.4mm
short circuit current(I _{max})	5KA	Net Weight	165g
Max discharge current(I _{max})	10KA		

Wiring Diagram

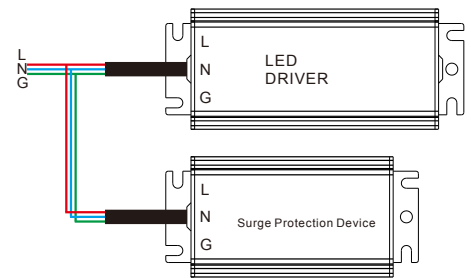

Model: HQ-SPD10KV10KA

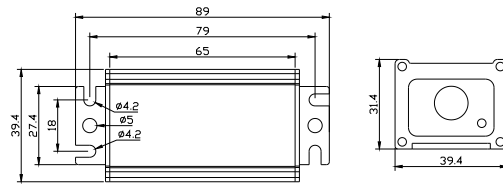

Model: HQ-SPD10KV10KA/D5

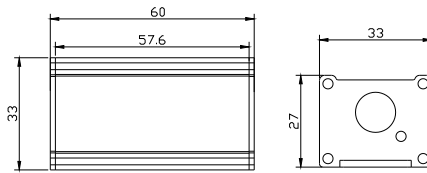

Model: HQ-SPD10KV10KA/B7

