

LED STRIP LIGHT

DIMENSIONS :

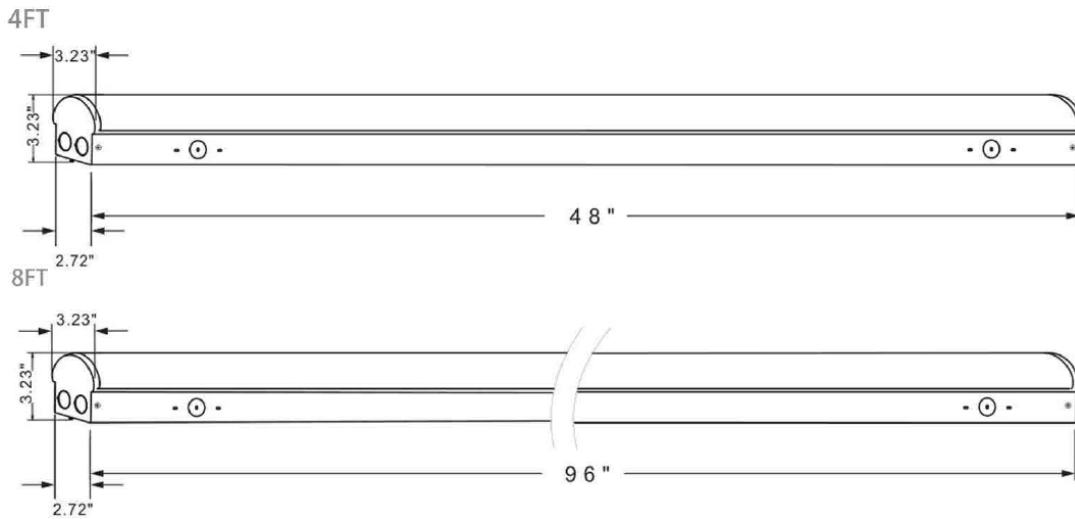

PACKING INFO:

| Part No. | Qty./Ctn | Ctn size | N.W. (lbs/Ctn) | G.W. (lbs/Ctn) | Qty./Pallet | Qty./40HQ | |
|----------------|----------|------------------|-------------------|-------------------|-------------|------------|---------|
| | | | | | | In pallets | In Ctns |
| | 4pcs | 50.6*7.5*7.7inch | 19.4lbs | 24.2lbs | 180pcs | 4320pcs | 6048pcs |
| Code: 90285-40 | 4pcs | 50.6*7.5*7.7inch | 19.4lbs | 24.2lbs | 180pcs | 4320pcs | 6048pcs |
| | 4pcs | 98.8*7.5*7.7inch | 33.3lbs | 41.5lbs | 180pcs | 2160pcs | 2740pcs |
| Code: 90285-64 | 4pcs | 98.8*7.5*7.7inch | 33.3lbs | 41.5lbs | 180pcs | 2160pcs | 2740pcs |

PERFORMANCE DATA:

| Size | Part No. | Power | luminous Flux | Input Voltage | PF | Ra | Beam Angle | Warranty | Certificate |
|------|----------------|-------|---------------|---------------|------|-----|------------|----------|-------------|
| 4FT | | 24W | 3120LM | AC100-277V | >0.9 | >80 | 110 | 5 Years | cUL&Premium |
| 4FT | Code: 90285-40 | 40W | 5200LM | AC100-277V | >0.9 | >80 | 110 | 5 Years | cUL&Premium |
| 8FT | | 40W | 5200LM | AC100-277V | >0.9 | >80 | 110 | 5 Years | cUL&Premium |
| 8FT | Code: 90285-64 | 64W | 8320LM | AC100-277V | >0.9 | >80 | 110 | 5 Years | cUL&Premium |

DIMMING CONNECTION:

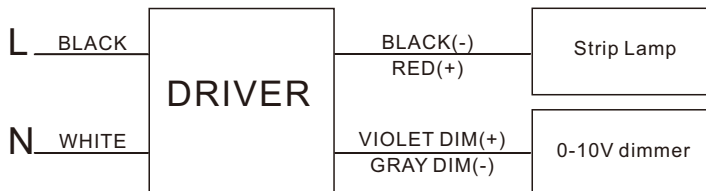

ORDERING EXAMPLE:

| | St | 4FT | 24 | XXK |
|----------------|--------------------------|--------------------------------|---|---|
| Company | Product | Size | Power | ColorTemp |
| | St Led Strip Light | 4FT(4 feet) 8FT(8 feet) | 24 (24 W) 40 (40 W) 64 (64 W) | 40K (4000K) 50K (5000K) ± 500K |

LED STRIP LIGHT

DIMENSIONS:

A:

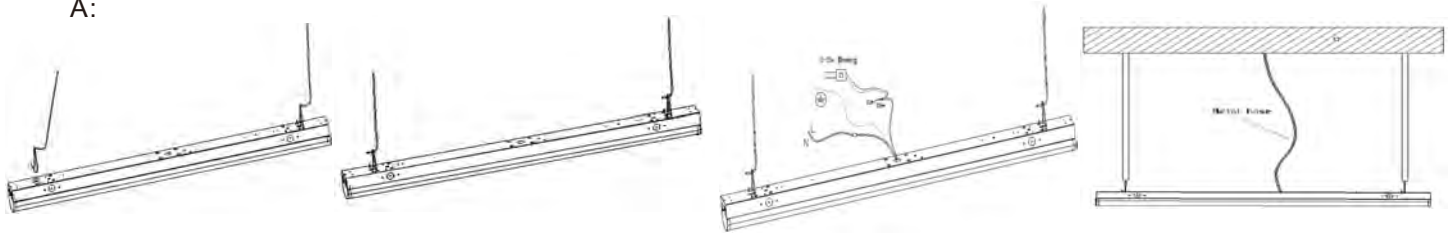

1. Tie hook with chain and then insert it into installation hole.
2. Fix chain to installation location, adjust the height of chain until fixture is balanced.
3. Connect AC wire and dimming wire.
4. Wrap wire with metal material.

B:

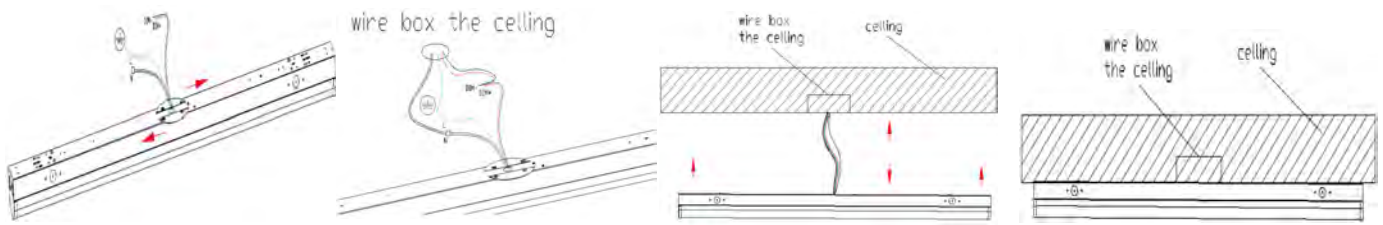

1. Lock the mounting plate.
2. Connect AC wire and dimming wire
3. Lift up the fixture and put wires into box.
4. Lock the fixture by nail.

C: T-Bar clip mounting

Fix fixture to T-bar ceiling grid with T-bar clips which are provided by customer
Refer to the left drawing; fix-bar clips on Position "C".

D: Connect in series

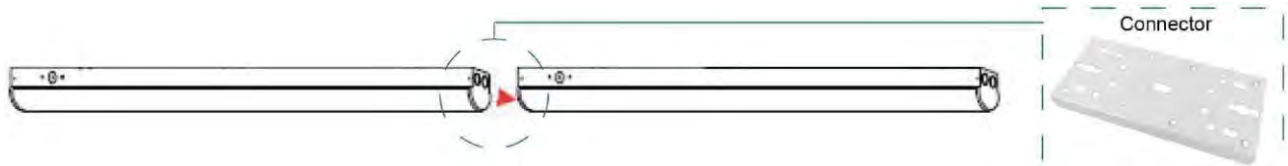

APPLICATIONS:

