

24W
40W/64W

CODE: 90285-40

LED STRIP LIGHT

FEATURES:

- ❖ Quick Installation;
- ❖ Instant on;
- ❖ 5 years warranty;
- ❖ Excellent efficacy 130lm/w or 160lm/w;
- ❖ DLC Premium listed as LED Strip light & Linear lowbay;



MODEL #	
PROJECT:	
NOTES:	
DATE:	
PREPARED BY:	

Additional Information:

- Power: 24W/40W/64W
- Input: AC 100-277V
- CCT : 4000K/5000K
- Efficacy: 130 LM/W
- Light Source: LED SMD
- Inner/outer emergency driver



TECHNICAL SPEC.

Housing	Riveted Sheet Metal c/w standard top and end KO
Finish	White
Lens	Frosted PC
Mounting	Surface, hanging and continuous row mounted May be mounted to TBar ceilings Application
	Commercial, industrial and area lighting, warehouses, offices, hallways etc.

ELECTRICAL SPEC.

Power Factor	>0.90
Ambient temp.	-20°C to 40°C
Input Voltages	100-277vAC Standard
CRI	>80

OPTICAL & PERFORMANCE SPEC.

Suitability	For damp locations
Beam Angle	120°
L70	>50,000hours

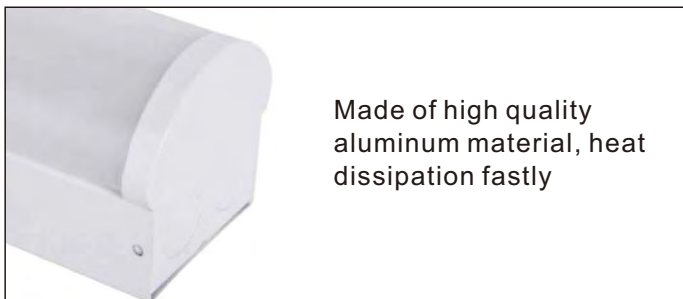

Made of high quality aluminum material, heat dissipation fastly

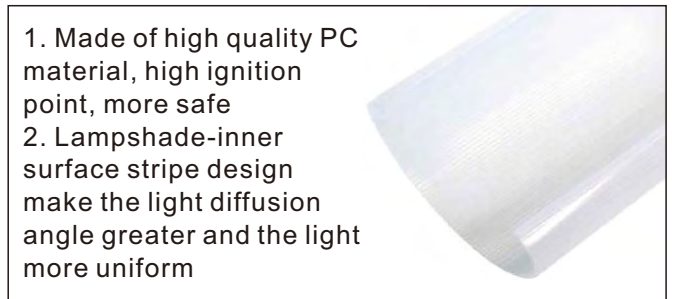

1. Made of high quality PC material, high ignition point, more safe
2. Lampshade-inner surface stripe design make the light diffusion angle greater and the light more uniform



LED STRIP LIGHT

DIMENSIONS :

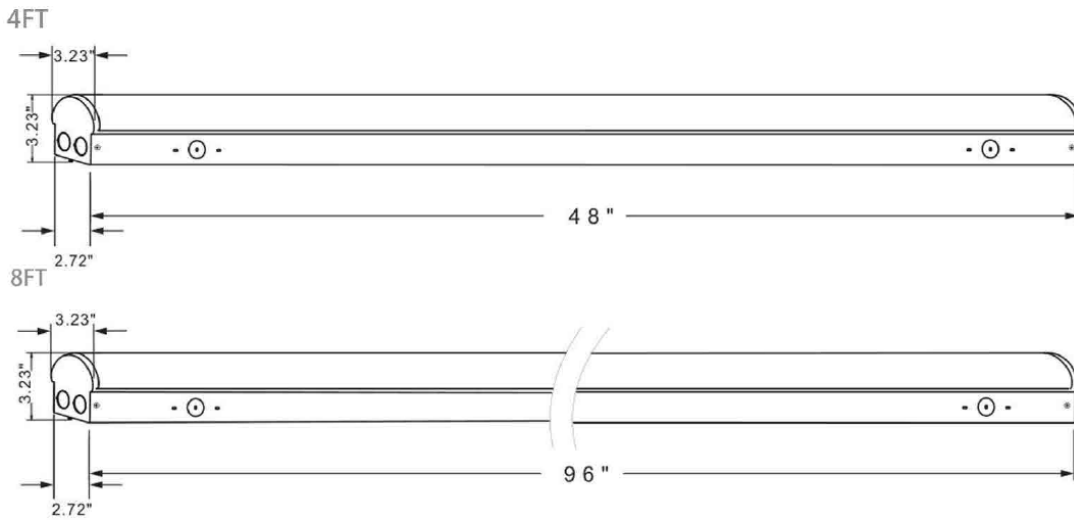

PACKING INFO:

Part No.	Qty./Ctn	Ctn size	N.W. (lbs/Ctn)	G.W. (lbs/Ctn)	Qty./Pallet	Qty./40HQ	
						In pallets	In Ctns
	4pcs	50.6*7.5*7.7inch	19.4lbs	24.2lbs	180pcs	4320pcs	6048pcs
Code: 90285-40	4pcs	50.6*7.5*7.7inch	19.4lbs	24.2lbs	180pcs	4320pcs	6048pcs
	4pcs	98.8*7.5*7.7inch	33.3lbs	41.5lbs	180pcs	2160pcs	2740pcs
	4pcs	98.8*7.5*7.7inch	33.3lbs	41.5lbs	180pcs	2160pcs	2740pcs

PERFORMANCE DATA:

Size	Part No.	Power	luminous Flux	Input Voltage	PF	Ra	Beam Angle	Warranty	Certificate
4FT		24W	3120LM	AC100-277V	>0.9	>80	110	5 Years	cUL&Premium
4FT	Code: 90285-40	40W	5200LM	AC100-277V	>0.9	>80	110	5 Years	cUL&Premium
8FT		40W	5200LM	AC100-277V	>0.9	>80	110	5 Years	cUL&Premium
8FT		64W	8320LM	AC100-277V	>0.9	>80	110	5 Years	cUL&Premium

DIMMING CONNECTION:

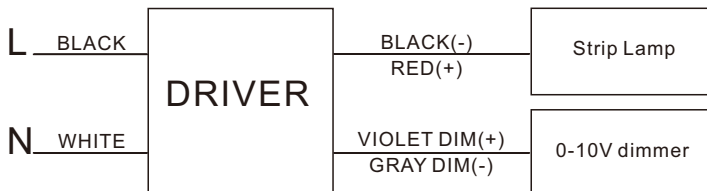

ORDERING EXAMPLE:

	St	4FT	24	XXK
Company	Product	Size	Power	ColorTemp
	St Led Strip Light	4FT(4 feet) 8FT(8 feet)	24 (24 W) 40 (40 W) 64 (64 W)	40K (4000K) 50K (5000K) ± 500K

LED STRIP LIGHT

DIMENSIONS:

A:

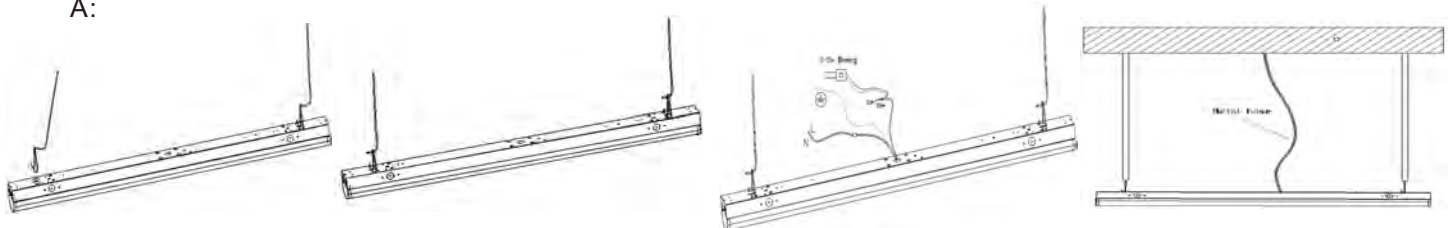

1. Tie hook with chain and then insert it into installation hole.
2. Fix chain to installation location, adjust the height of chain until fixture is balanced.
3. Connect AC wire and dimming wire.
4. Wrap wire with metal material.

B:

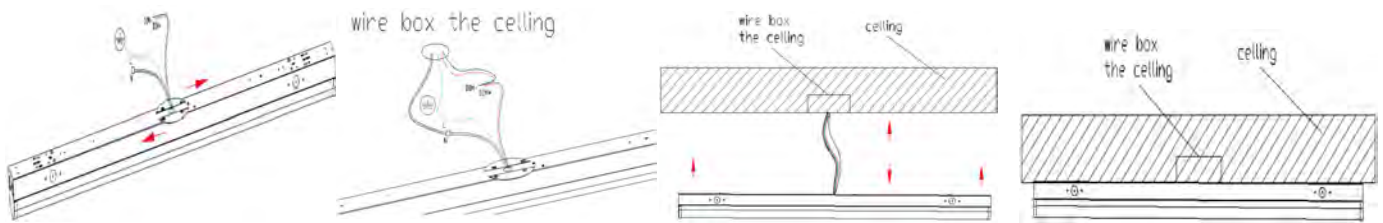

1. Lock the mounting plate.
2. Connect AC wire and dimming wire
3. Lift up the fixture and put wires into box.
4. Lock the fixture by nail.

C: T-Bar clip mounting

Fix fixture to T-bar ceiling grid with T-bar clips which are provided by customer
Refer to the left drawing; fix-bar clips on Position "C".

D: Connect in series

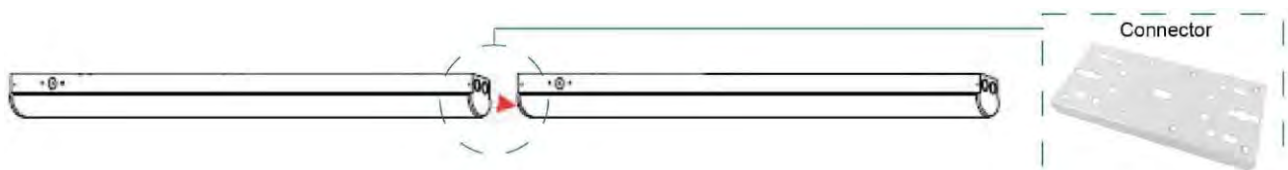

APPLICATIONS:

