

# **SYNERGY 5**

## **Conveyorized Automatic Stretch Wrap System**

### **CONTROLS**

State-of-the-art touch screen controls for reliable operation. Diagnostic indicators for troubleshooting

### **DUAL POWER HYDRO STRETCH™**

Delivers unlimited film stretch and maximum load security. Your loads will be wrapped at the lowest possible cost per load

### **FILM CUT AND SEAL**

The film is cut with an anti-friction coated hot bar. The whale tail secures the film to the load

### **HEAVY DUTY CONVEYORS**

Highlight-built heavy duty conveyors for fast, smooth conveying and high production rates

## **HIGHLIGHTS**

- » Dual Power Hydro-Stretch™ provides infinite control of film stretch on the load and at the pallet/load interface, increasing load security and film savings
- » Heavy Duty conveyor provides fully automatic and hands free operation, as well as increased production capabilities
- » Allen-Bradley components ensure reliability and durability, as well as complete control over every aspect of your stretch wrapping needs





## CONTROL PANEL FEATURES

- 10 Independently Programmable Wrap Recipes
- Top and Bottom Counters
- Emergency Stop Push/Pull
- Start/Ready
- Cycle Interrupt or Pause
- Conveyor Forward/Reverse Selector
- Film Elevator Spiral Speed Dial
- Film Elevator Up/Down Selector
- Conveyors Jog Pushbutton
- Clamp Open/Close
- Film Cut Arm Extend/Retract
- Conveyor Jog
- Manual/Auto Selector

## SYSTEM SPECIFICATIONS

Dual Power Hydro-Stretch™	Fully Adjustable up to 500% Stretch	Operating Controls	Allen-Bradley SLC-502 PLC
Turntable	84" Diameter, 12 RPM	Conveyor Dimensions	60" Length, 52" Effective Width
Wrap Height	Up to 72"	Conveyor Speed	Up to 30 ft/min
Film Capacity	10-20" Roll Width, 10" Diameter	Pneumatic Requirements	80 psi, 3 cfm
Rollers	3 3/4" Roller Centers, 2 1/2 Diameter	Electrical Requirements	240/480 Volt, 3 Phase, 15 Amp

**Contact:** Pathfinder Systems  
695 Ottawa Beach Rd  
Holland, MI 49424  
616-395-8447

## PREMIUM FEATURES

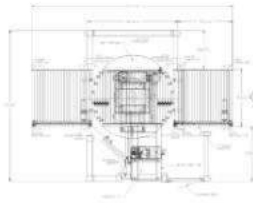

### Heavy Duty

All-steel construction and *over-engineered* design make the Synergy 5 durable and reliable for decades of use.



### Dual Power Hydro-Stretch™

A feature exclusive to Highlight Industries, provides two independent levels of pre-stretch: one for the bottom of the load, the other for the rest of the load. Dual Power Hydro-Stretch™ allows you to set the two levels separately for differences in your pallet and load profile, and bring the film to its optimum level.



### Fully Automatic Controls

Automatic controls increase productivity and efficiency. Programmable settings allow for consistent wrapping from load to load. Independently programmable wrap recipes ensure each load is wrapped precisely.



### Conveyor System

Highlight-built heavy duty conveyors are perfectly integrated for precise and reliable function.

**PATHFINDER**  
Sales@PathfinderSystem.com | 616-395-8447