

## PROJECT NEWSLETTER • SPRING 2018

### DESIGN OF INTERCHANGE NEARING COMPLETION

The Maryland Department of Transportation State Highway Administration (MDOT SHA) is finishing design work on the MD 175 (Jessup Road/Annapolis Road) over MD 295 (Baltimore-Washington Parkway) Interchange Project in Anne Arundel County. This segment of the MD 175 Corridor near Fort George G. Meade is one of many to be constructed. Once built, the project will improve roadway capacity and connectivity, improve the safety of motorists and pedestrians along MD 175, and improve traffic operations along MD 295. The project will also support existing and planned development in the area.

### PROJECT OVERVIEW AND PURPOSE

To increase the capacity of MD 175 over MD 295, MD 175 will be widened from a four-lane undivided roadway to a six-lane divided roadway. Following a 2012 engineering study, MDOT SHA selected a partial cloverleaf intersection at this location. The existing northeast and southwest loop ramps of the interchange will now be eliminated, and left-turns will be added at signalized intersections with MD 175 in the southeast and northwest quadrants of the interchange. A median will be constructed to separate eastbound and westbound traffic.

### PROJECT DELIVERY

The project will be delivered in phases. Property acquisitions are nearly complete, and utility relocations have begun. Utility poles east of MD 295 are expected to be relocated this Spring. Gas main work is expected at the Parkway this Summer, and roadway construction is expected to start in the Fall. Once major utilities have been moved, construction on the north side of the new bridge over MD 295 will begin.

### PROJECT BACKGROUND

The area around Fort Meade is one of the fastest-growing areas of Anne Arundel County, and home to one of the largest employers in Maryland. Numerous other developments (including Arundel Mills Mall) and growth in the Baltimore-Washington International Business District have contributed to increased traffic volumes in the area. MDOT SHA determined that the MD 175 Corridor from west of the MD 295 Interchange to MD 170 (Telegraph Road/Piney Orchard Pkwy) in northwestern Anne Arundel County lacked sufficient capacity to accommodate future transportation needs in and around Fort Meade.

In addition to improving capacity, traffic operations, connectivity, and safety along MD 175, the project will help revitalize the North Odenton commercial district. MDOT SHA began design work on the MD 175 at MD 295 Interchange Project in late 2011.



Visit <http://www.md511.org/> for reliable, current traffic and weather information, as well as links to other transportation services. Maryland 511 helps motorists reach their destination in the most efficient manner when traveling in Maryland.

### LEGEND

- - Traffic Signal
- - Newly Installed Ramp

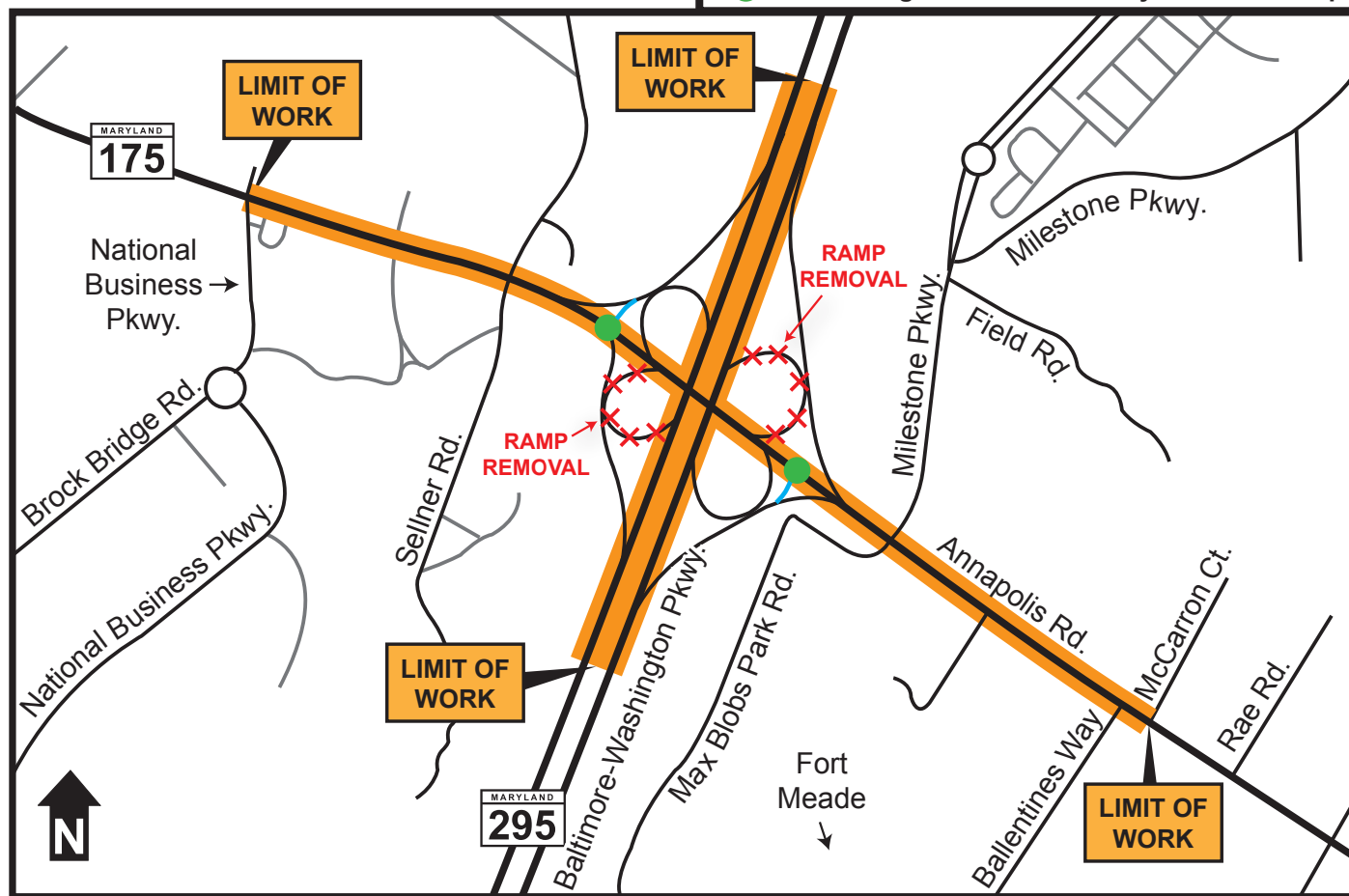

STATE HIGHWAY ADMINISTRATION  
OFFICE OF HIGHWAY DEVELOPMENT  
707 NORTH CALVERT. STREET  
MAIL STOP C-102  
BALTIMORE, MD 21202

**MD 175 over MD 295  
Interchange Project**



**FIND US ON THE WEB**

For project details please visit MDOT SHA's website at [www.roads.maryland.gov](http://www.roads.maryland.gov) and click on Projects and Studies, MDOT SHA Projects Page. Type **MD 175** in the lower search box, select **MD 175, Annapolis Road MD 295 TO MD 170** from the dropdown menu, then click on the **Additional Project Information** link in the callout box.

**FOR MORE INFORMATION**

For additional information on the MD 175/295 Interchange project, please contact:

**Mr. Christopher Weber, MDOT SHA Project Manager**  
Maryland Department of Transportation  
State Highway Administration  
Office of Highway Development  
707 North Calvert. St., Mail Stop C-102  
Baltimore, MD 21202  
Phone: 410-545-8834 Toll-Free: 1-888-228-5003  
Email: [cweber@sha.state.md.us](mailto:cweber@sha.state.md.us)

The Maryland Relay Service can assist teletype users at 7-1-1. Persons requiring assistance to participate (interpreter for hearing/ speech difficulties or assistance with the English language) should contact Mr. Weber.

**Chinese:**

如蒙<中文版>的简报，请发电子邮件到 [shatitlevi@sha.state.md.us](mailto:shatitlevi@sha.state.md.us)。  
请在电子邮件主题栏标出 <Chinese>。

**Amharic:**

ፎካቲቪ@sha.state.md.us፡፡ አባኩ በኢ.ማ.ሪ.ሪ. ርህረ. ላይ <Amharic> ብለው ያጻፉኩ፡፡  
ፎካቲቪ@sha.state.md.us፡፡ አባኩ በኢ.ማ.ሪ.ሪ. ርህረ. ላይ <Amharic> ብለው ያጻፉኩ፡፡

**Vietnamese:**

Để nhận được bản tin này bằng tiếng Việt, xin vui lòng gửi email (thư điện tử) đến: [shatitlevi@sha.state.md.us](mailto:shatitlevi@sha.state.md.us). Xin vui lòng biểu thị <Vietnamese> trong dòng tiêu đề email.

**Spanish:**

Para recibir este boletín en español, por favor envíe un correo electrónico a: [shatitlevi@sha.state.md.us](mailto:shatitlevi@sha.state.md.us). Por favor indique <Spanish> en el asunto del correo electrónico.

**Larry Hogan, Governor** | **Boyd K. Rutherford, Lt. Governor** | **Pete K. Rahn, Secretary** | **Gregory Slater, Administrator**



printed on recycled paper