



**SANTA MARGARITA CATHOLIC HIGH SCHOOL • 2022-2023**

**PRINTED TEXTBOOKS AND  
E-BOOK SALES OFFERED ONLINE**

***Beginning at 8:00 a.m. on July 12***

Santa Margarita Catholic High School will use eCampus as our official textbook provider for the upcoming school year. Book sales will be available beginning at

**8:00 a.m. Tuesday, July 12, and will run through Monday, July 25.**

We recommend that you make your purchases as soon as possible so that there is time to set up your e-book accounts prior to the beginning of classes.

**An email with personalized login information was sent out on June 30.**

**If you did not receive your personalized login information by July 5,  
please email [textbooks@smhs.org](mailto:textbooks@smhs.org) for assistance.**

***How to Order Textbooks:***

- Your student's SMCHS credentials will be used to log into the eCampus site. If you are currently logged into Office 365 or Microsoft Teams under other credentials, please log out prior to accessing eCampus. (We use a single sign-on and eCampus uses the credentials from Office365).
- Go to <https://smhs.ecampus.com/>
- Select the View Books button under Shop By Schedule.
- Select the Log in with Clever button.
- Select the Log in with Active Directory button.
- You will login using the SMCHS student email and SMCHS student network password. This will automatically pull your student's schedule information and populate their customized booklist. We recommend copying and pasting the email and password to avoid typos.
- Enter your student's email and select Next.
- Enter your student's password and select Next.
- Select the books you would like to purchase, along with the preferred condition, and then select Add Item to Cart.
- Review your Shopping Cart and select Proceed to Checkout.
- When you reach the secure checkout screen, input your student's name and their @smhsstudents.org email listed above. The parent name and email address will be used for customer service contact, order communication, and school reporting. Select Continue.
- Fill out your shipping address, select your shipping method, enter your payment information, and then select Continue to review your order.
- If you are satisfied with your order, select Place Order and you're done! You will receive an order confirmation email for your records.

***Questions:***

- You can contact eCampus support at [k12support@ecampus.com](mailto:k12support@ecampus.com) or (844) 523-8980.

***Additional Details:***

- You will receive free standard shipping if you place your order July 12 through July 18 (excludes Marketplace purchases).
- Used textbooks, for those classes using printed texts, are available and sold on a first-come first-served basis.

- Returns for physical books are allowed within 30 days of the first day of school. New books must be returned in new condition, and shrink-wrapped items must remain unopened. Please visit the MY ACCOUNT section to create a Return ID Number to ensure your return is processed correctly. Returns for digital items are allowed within 14 days of the first day of school, with proof of class withdrawal. Credit for returns will be issued and processed within 2-4 weeks.
- Some additional course materials will be ordered and distributed directly through the school. Students enrolled in any of these courses will have the cost of these materials charged to the student's FACTS account in late August or early September. These courses are listed below.

### ***Courses Requiring Additional Materials Distributed Through the School:***

- Algebra 1 - ALEKS, \$59.09
- Algebra 2 - ALEKS, \$59.09
- All English Classes - Vocabulary, \$7.50
- AP Chinese Lang - eChinese, TBD
- AP Physics 1 - Pivot, \$7.50
- AP PhysicsC Mec - Pivot, \$7.50
- Bio Living Erth - Gizmo, \$7.62
- Bio Living Erth - Kognity NGSS, TBD
- Bio Lvng Erth H - Gizmo, \$7.62
- Bio Lvng Erth H - Biozone, \$37.45
- Biology HL 2 IB - Kognity IBDP Biology, \$82.50
- Biology SL IB - Kognity IBDP Biology, \$82.50
- Chem Earth Sys - Kognity NGSS, TBD
- Chem Earth Sys - Gizmo, \$7.62
- Chem Earth SysH - Gizmo, \$7.62
- Chem Earth SysH - WebAssign, \$16.00
- Chemistry Comm - Gizmo, \$7.62
- Chemistry SL IB - Kognity IBDP Chemistry, \$82.50
- Cncpts EnvirSci - Gizmo, \$7.62
- Earth Science - Gizmo, \$7.62
- Environmtl Sci - Gizmo, \$7.62
- EnvironSy IB SL - Kognity IBDP Environ Systems and Societies, \$82.50
- Geometry - ALEKS, \$59.09
- M.Chinese SL IB - eChinese, TBD
- Ocean/Mar Bio - Gizmo, \$7.62
- Physics HL 1 IB - Pivot, \$7.50
- Physics HL 2 IB - Pivot, \$7.50
- Physics HL 2 IB - Kognity IBDP Physics, \$82.50
- PhysicsUniverse - Physics Classroom, \$4.50
- Spanish 1 - Avancemos! Level 1, \$37.90
- Spanish 1 H - Avancemos! Level 1, \$37.90
- Spanish 2 - Avancemos! Level 2, \$37.90
- Spanish 2 H - Avancemos! Level 2, \$37.90
- Spanish 3 - Avancemos! Level 3, \$37.90
- Spanish 3 H - Avancemos! Level 3, \$37.90

# Ordering Books Through the eCampus Site

- If you are currently logged into Microsoft Office365, log out (we use a single sign-on and our textbook site uses the credentials from Office365).
- Go to <https://smhs.ecampus.com/>
- Select the **View Books** button under Shop By Schedule

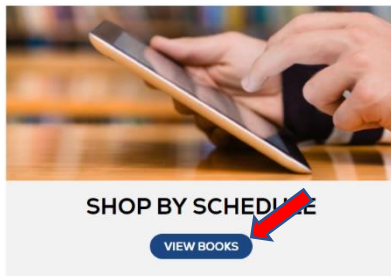

- Select the **Log in with Clever** button



- Select the **Log in with Active Directory** button



- You will login using your student's SMCHS email and SMCHS network password. This will automatically pull their schedule information to populate their customized booklist.
- Enter your student's email and select **Next**

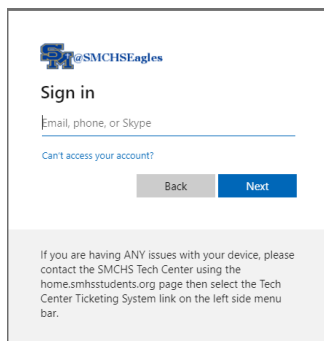

- Enter your student's password and select **Next**

---



← giselle.hollis@smhsstudents.org

**Enter password**

password

[Forgot my password](#)

[Sign in](#)

If you are having ANY issues with your device, please contact the SMCHS Tech Center using the home.smhsstudents.org page then select the Tech Center Ticketing System link on the left side menu bar.

- Select the books you would like to purchase, along with the preferred condition and select **Add Item to Cart**.
- Review your **Shopping Cart** and select **Proceed to Checkout**.
- When you reach the secure checkout screen, input your student's name and their @smhsstudents.org email. The parent name and email address will be used for customer service contact, order communication, and school reporting. Select **Continue**.
- Fill out your shipping address, select your shipping method, and enter your payment information and select **Continue** to review your order.
- If you are satisfied with your order, select **Place Order** and you're done! You will receive an order confirmation email for your records.