

# Quick Guide to Wireless Sync

- Use this feature to configure PBS to PBS (same phase) Wireless links to actuate to synchronize sounds (Walk & Clearance). Feature provides a link between PBS's on the same ped phase such that a button press on one unit enables the Walk and Clearance sound on the other units (same phase).
- Receiving button can also be programmed to activate/place a ped call – via a contact closure (will mirror other button push, extended push) “Remote Ped Call” Feature
- When the Wireless Sync feature is active, the Bluetooth radio is scanning for button pushes. That means the PBS is not able to connect to your iOS device or PC, via Bluetooth.
- *This may be circumvented by pressing the PBS pushbutton with an extended push and waiting 5 seconds. The PBs will accept connections until the start of the next Clearance Cycle.*

# Quick Guide to Wireless Sync

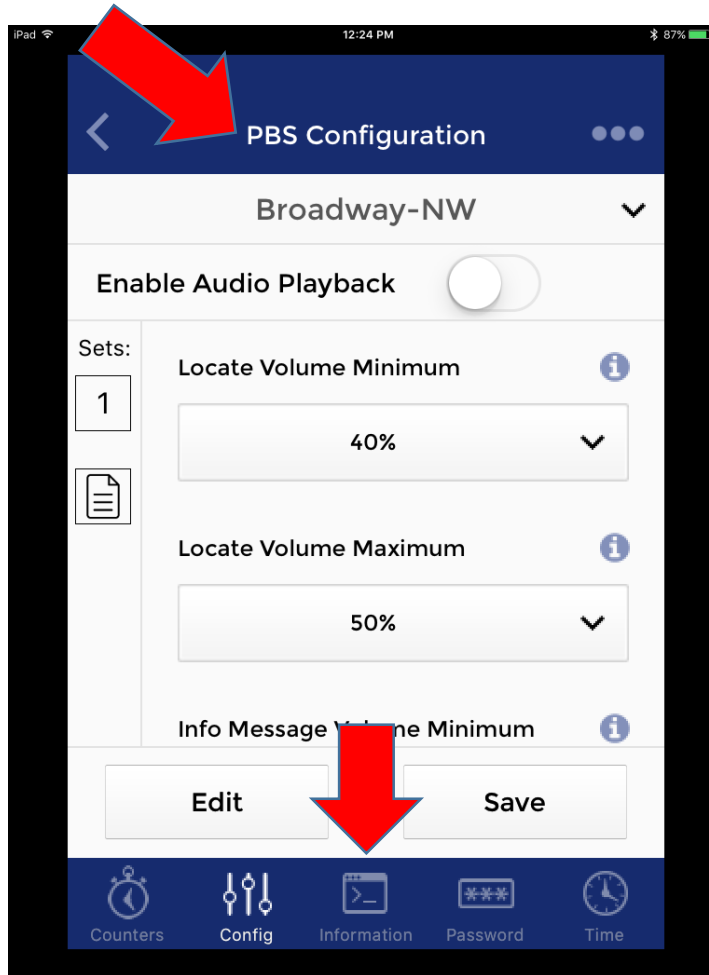

1. Go to **PBS Configuration** Page
2. Tap on **"Information"**



3. Tap on **"Wireless Sync"**

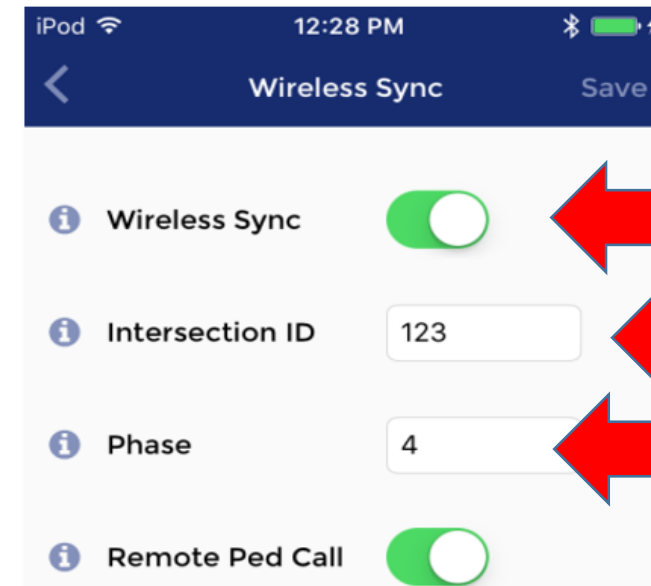

4. Turn on **"Wireless Sync" Button**
5. Assign a number in **"Intersection ID" box** (0-1000 – any number ok as long as different from number used on nearby intersection)
6. Assign a Ped Phase number in **"Phase" box** to match phase desired for button push sync
7. Hit **"Save"** and repeat for each PBS

## Remote Ped Call Option

**When the Remote Ped Call option is enabled, if that unit receives a button push indication from a Wireless Sync transmission, then it will also cause a Ped Call indication in the form of a contact closure on the terminal block wires to the traffic cabinet.**

**This can be useful if one side of intersection has button wires to the traffic cabinet but the other side does not. Then any button pushed from the unit without wires can transmit the button press status wirelessly to the other unit causing a Ped Call to be asserted. In this situation, only the units with button wires going to the traffic cabinet should have this option enabled.**