



# COVID 19 Health and Safety Plan

*Building Austin's future by upholding its legacy*





# Our COVID-19 Health Safety Plan

---

- Our Commitment
- Management Team Expectations
- Subcontractor & Vendor Communication Plan
- Onsite Health Safety Officer (HSO)
- Daily Health Safety Inspection Plan
- Essential COVID-19 Materials
- Community Communication Plan

# Our Commitment

---

## Building Austin's future by upholding its legacy

Construction Industry Team Member safety is always a top priority on Cumby Construction job sites. Personal Protection Equipment (PPE) is always required to ensure safety on every job. To comply with Center for Disease Control (CDC) and Travis County Health Officials recommendations, developed in an effort to reduce the incidence of COVID-19, effective immediately the following additional onsite safety practices will be followed by all Cumby Construction team members, subcontractors, and vendors. These additional health safety protocols will continue until further notice. We consider it a privilege to continue to work and provide an essential service to our community and the many families depending on the construction industry. We are committed to providing industry leadership by adopting and following the best health safety practices to offer a safe working environment for our team members and neighbors.





# Our Management Team Expectations

- Provide daily health safety support to the onsite health safety officer
- Include health safety screening log in the daily job report
- While practicing recommended distancing limit access to jobsite construction trailer to no more than two people at any time
- Enforce Cumby Construction site health safety protocol at all times
- Require use of PPE at all times
- Confirm regular onsite sanitation tasks are performed twice daily
- Require recommended personal distancing within the construction jobsite
- Advocate frequent hand washing and hand sanitizing
- Remove any person refusing to follow health safety protocols from the jobsite





# Our Subcontractor & Vendor Communication Plan

Cumby Construction is committed to working together to responsibly establish protocols that protect our industry partners and neighbors. During this challenging time we respectfully request your help by requiring complete participation from your team members while on our jobsites.

## What we need from our subcontractors and vendors

- Attend Cumby Construction's subcontractor and vendor COVID-19 conference calls
- Provide complete contact information for all team members to be used confidentially for our health safety screening log
- Require compliance with Cumby Construction's COVID-19 health safety protocol from your company
- Require your team to utilize the PPE provided by Cumby Construction
- Communicate questions or concerns related to Cumby Construction's COVID-19 safety protocols
- Require your jobsite team members to attend weekly project safety meetings
- Discourage carpooling to the jobsites







# Our Onsite Health Safety Officer (HSO)

Throughout the workday our onsite HSO will be performing Health Safety Screening of all individuals seeking access to the jobsite.

## Health Screening

- Record and confirm name, time, date and company in the screening log
- Take temperature with no-touch temperature gun and record pass or fail in the screening log
- Provide PPE kit with gloves, mask, english/spanish protocol safety card and record issuance in the screening log
- Communicate that additional PPE is available as needed

## If Access is Denied to site:

- Provide Access Denied Information
- Communicate negative screening results to the individuals employer

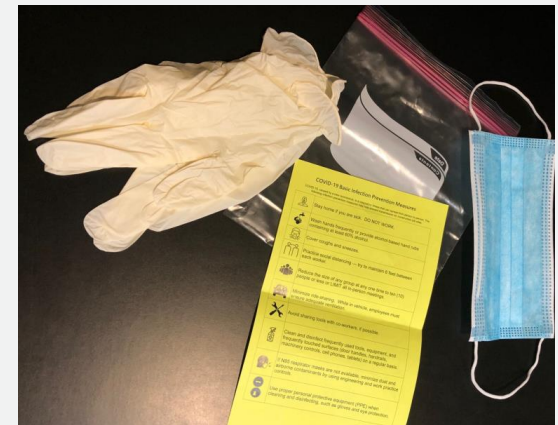



# Our Health Safety Screening Log

Throughout the workday our Health Safety Officer will record and confirm name, time, date and company in the screening log provided by Cumby Construction



## Health Safety Screening Log

Last Name	First Name	Company	Cell Phone	Address	City	State	Zip	Temp P/F	Approved Y/N	PPE Y/N
Adams	Jon	Cumby Construction	512-000-0000	9229 Watford Centre Blvd	Austin	TX	78758			
Andrews	Kyle	Cumby Construction	512-000-0000	9229 Watford Centre Blvd	Austin	TX	78758			
Balch	Bobby	Cumby Properties	512-111-1111	9229 Watford Centre Blvd	Austin	TX	78758			
Barton	Kardi	Cumby Construction	512-111-1111	9229 Watford Centre Blvd	Austin	TX	78758			
Brown	Melissa	Cumby Development	512-000-0000	9229 Watford Centre Blvd	Austin	TX	78758			
Burton	Hannah	Cumby Properties	512-111-1111	9229 Watford Centre Blvd	Austin	TX	78758			
Cassiday	Ryan	Cumby Construction	512-111-1111	9229 Watford Centre Blvd	Austin	TX	78758			
Cumby	Bryan	Cumby Construction	512-000-0000	9229 Watford Centre Blvd	Austin	TX	78758			
Cumby	James	Cumby Construction	512-000-0000	9229 Watford Centre Blvd	Austin	TX	78758			
Dickinson	Lynn	Cumby Development	512-000-0000	9229 Watford Centre Blvd	Austin	TX	78758			
Eisworth	Matt	Cumby Construction	512-000-0000	9229 Watford Centre Blvd	Austin	TX	78758			
Garcia	Adam	Cumby Construction	512-000-0000	9229 Watford Centre Blvd	Austin	TX	78758			
Garcia	Rodrigo	Cumby Equipment	512-000-0000	9229 Watford Centre Blvd	Austin	TX	78758			
Grierson	Steve	Cumby Construction	512-111-1111	9229 Watford Centre Blvd	Austin	TX	78758			
Hatley	Tara	Cumby Development	512-000-0000	9229 Watford Centre Blvd	Austin	TX	78758			
Kay	Donette	Cumby Group	512-111-1111	9229 Watford Centre Blvd	Austin	TX	78758			
Lafond	Scott	Cumby Equipment	512-111-1111	9229 Watford Centre Blvd	Austin	TX	78758			
McCaffrey	Sean	Cumby Construction	512-111-1111	9229 Watford Centre Blvd	Austin	TX	78758			
Milam	Patrick	Cumby Construction	512-000-0000	9229 Watford Centre Blvd	Austin	TX	78758			
Miller	Linda	Cumby Properties	512-111-1111	9229 Watford Centre Blvd	Austin	TX	78758			
Moore	Robin	Cumby Development	512-000-0000	9229 Watford Centre Blvd	Austin	TX	78758			
Nash	Jeff	Cumby Group	512-111-1111	9229 Watford Centre Blvd	Austin	TX	78758			
Pumphrey	Cameron	Cumby Group	512-111-1111	9229 Watford Centre Blvd	Austin	TX	78758			
Ramsey	Melinda	Cumby Construction	512-111-1111	9229 Watford Centre Blvd	Austin	TX	78758			
Rodriguez	Sonya	Cumby Properties	512-111-1111	9229 Watford Centre Blvd	Austin	TX	78758			
Sanders	Todd	Cumby Group	512-111-1111	9229 Watford Centre Blvd	Austin	TX	78758			
Terazzas	Noah	Cumby Properties	512-111-1111	9229 Watford Centre Blvd	Austin	TX	78758			
Weiss	John	Cumby Construction	512-111-1111	9229 Watford Centre Blvd	Austin	TX	78758			

Last Name	First Name	Company	Cell Phone	Address	City	State	Zip	Temp P/F	Approved Y/N	PPE Y/N
Adams	Jon	Cumby Construction	512-000-0000	9229 Watford Centre Blvd	Austin	TX	78758			
Andrews	Kyle	Cumby Construction	512-000-0000	9229 Watford Centre Blvd	Austin	TX	78758			
Balch	Bobby	Cumby Properties	512-111-1111	9229 Watford Centre Blvd	Austin	TX	78758			
Barton	Kardi	Cumby Construction	512-111-1111	9229 Watford Centre Blvd	Austin	TX	78758			

Last Name	First Name	Company	Cell Phone	Address	City	State	Zip	Temp P/F	Approved Y/N	PPE Y/N
Adams	Jon	Cumby Construction	512-000-0000	9229 Watford Centre Blvd	Austin	TX	78758			
Andrews	Kyle	Cumby Construction	512-000-0000	9229 Watford Centre Blvd	Austin	TX	78758			

Last Name	First Name	Company	Cell Phone	Address	City	State	Zip	Temp P/F	Approved Y/N	PPE Y/N
Adams	Jon	Cumby Construction	512-000-0000	9229 Watford Centre Blvd	Austin	TX	78758			
Andrews	Kyle	Cumby Construction	512-000-0000	9229 Watford Centre Blvd	Austin	TX	78758			

Last Name	First Name	Company	Cell Phone	Address	City	State	Zip	Temp P/F	Approved Y/N	PPE Y/N
Adams	Jon	Cumby Construction	512-000-0000	9229 Watford Centre Blvd	Austin	TX	78758			
Andrews	Kyle	Cumby Construction	512-000-0000	9229 Watford Centre Blvd	Austin	TX	78758			
Balch	Bobby	Cumby Properties	512-111-1111	9229 Watford Centre Blvd	Austin	TX	78758			
Barton	Kardi	Cumby Construction	512-111-1111	9229 Watford Centre Blvd	Austin	TX	78758			
Brown	Melissa	Cumby Development	512-000-0000	9229 Watford Centre Blvd	Austin	TX	78758			
Burton	Hannah	Cumby Properties	512-111-1111	9229 Watford Centre Blvd	Austin	TX	78758			

Last Name	First Name	Company	Cell Phone	Address	City	State	Zip	Temp P/F	Approved Y/N	PPE Y/N
Adams	Jon	Cumby Construction	512-000-0000	9229 Watford Centre Blvd	Austin	TX	78758			
Andrews	Kyle	Cumby Construction	512-000-0000	9229 Watford Centre Blvd	Austin	TX	78758			
Balch	Bobby	Cumby Properties	512-111-1111	9229 Watford Centre Blvd	Austin	TX	78758			
Barton	Kardi	Cumby Construction	512-111-1111	9229 Watford Centre Blvd	Austin	TX	78758			
Brown	Melissa	Cumby Development	512-000-0000	9229 Watford Centre Blvd	Austin	TX	78758			
Burton	Hannah	Cumby Properties	512-111-1111	9229 Watford Centre Blvd	Austin	TX	78758			

Last Name	First Name	Company	Cell Phone	Address	City	State	Zip	Temp P/F	Approved Y/N	PPE Y/N
Adams	Jon	Cumby Construction	512-000-0000	9229 Watford Centre Blvd	Austin	TX	78758			
Andrews	Kyle	Cumby Construction	512-000-0000	9229 Watford Centre Blvd	Austin	TX	78758			
Balch	Bobby	Cumby Properties	512-111-1111	9229 Watford Centre Blvd	Austin	TX	78758			
Barton	Kardi	Cumby Construction	512-111-1111	9229 Watford Centre Blvd	Austin	TX	78758			
Brown	Melissa	Cumby Development	512-000-0000	9229 Watford Centre Blvd	Austin	TX	78758			
Burton	Hannah	Cumby Properties	512-111-1111	9229 Watford Centre Blvd	Austin	TX	78758			

Last Name	First Name	Company	Cell Phone	Address	City	State	Zip	Temp P/F	Approved Y/N	PPE Y/N
Adams	Jon	Cumby Construction	512-000-0000	9229 Watford Centre Blvd	Austin	TX	78758			
Andrews	Kyle	Cumby Construction	512-000-0000	9229 Watford Centre Blvd	Austin	TX	78758			
Balch	Bobby	Cumby Properties	512-111-1111	9229 Watford Centre Blvd	Austin	TX	78758			
Barton	Kardi	Cumby Construction	512-111-1111	9229 Watford Centre Blvd	Austin	TX	78758			
Brown	Melissa	Cumby Development	512-000-0000	9229 Watford Centre Blvd	Austin	TX	78758			
Burton	Hannah	Cumby Properties	512-111-1111	9229 Watford Centre Blvd	Austin	TX	78758			

Last Name	First Name	Company	Cell Phone	Address	City	State	Zip	Temp P/F	Approved Y/N	PPE Y/N
Adams	Jon	Cumby Construction	512-000-0000	9229 Watford Centre Blvd	Austin	TX	78758			
Andrews	Kyle	Cumby Construction	512-000-0000	9229 Watford Centre Blvd	Austin	TX	78758			
Balch	Bobby	Cumby Properties	512-111-1111	9229 Watford Centre Blvd	Austin	TX	78758			
Barton	Kardi	Cumby Construction	512-111-1111	9229 Watford Centre Blvd	Austin	TX	78758			
Brown	Melissa	Cumby Development	512-000-0000	9229 Watford Centre Blvd	Austin	TX	78758			
Burton	Hannah	Cumby Properties	512-111-1111	9229 Watford Centre Blvd	Austin	TX	78758			



# Our Access Denied Information Card

Individuals screened by the HSO who exhibit commonly known symptoms of COVID-19 are denied access to the construction site and will be provided the informational card below.

**You are denied access to this and other construction sites**

- Contact your employer immediately
- Follow information below



**TEXAS**  
Health and Human  
Services

**Texas Department of State  
Health Services**

<https://www.dshs.texas.gov/coronavirus/>  
<https://www.dshs.texas.gov/coronavirus-sp/>  
telephone: #211 ext. #6



# Our Daily Health Safety Inspection Plan

Conduct daily health safety inspections utilizing the approved Cumby Construction health safety inspection checklist

Health Safety checklist includes the following items:

- Health safety screening taking place
- PPE mask and gloves are being utilized
- Hand sanitizer is available to all site team members
- Hand wash station is functioning properly
- Hand wash soap dispensers are full and functioning
- Daily sanitation of port-a-can and frequently touched surfaces is being performed
- Protocol signs are posted properly
- Extra PPE is available on site



The image shows a tablet displaying a digital version of the 'COVID19 Job Safety Checklist #1'. The checklist is organized into sections for communication, inspection details, and specific items. It includes a summary table at the top right with columns for '21/21 Items Inspected', '21 Safe', '0 At Risk', '0 N/A', and '0 Neutral'. The checklist also includes fields for 'TYPE', 'TRADE', 'SPEC SECTION', 'DESCRIPTION', 'ATTACHMENTS', 'INSPECTION DATE', 'ASSIGNEE', 'DUE DATE', 'RESPONSIBLE CONTRACTOR', and 'POINT OF CONTACT'. The bottom section lists specific inspection items with checkboxes for 'Safe', 'At Risk', and 'N/A'.

21/21 Items Inspected	21 Safe	0 At Risk	0 N/A	0 Neutral
TYPE: Safety STATUS: Open				
TRADE: LOCATION:				
SPEC SECTION: LINKED DRAWINGS:				
DESCRIPTION:				
ATTACHMENTS:				
INSPECTION DETAILS				
INSPECTION DATE: 4/6/2020 DUE DATE: 04/06/2020				
ASSIGNEE: RESPONSIBLE CONTRACTOR:				
POINT OF CONTACT:				
Communication				
1.1 Company COVID19 policies and procedures are being distributed to all subcontractor teams and company teams on the job site.				
Activity: 1 Response Change, 0 Attachments, 0 Photos, 0 Comments, 0 Observation				
Cameron Pumphrey responded with Safe on April 8th, 2020 at 06:14 PM CDT				
1.2 Company COVID19 policies and procedures are posted at the main gated entrance of the job site.				
Activity: 1 Response Change, 0 Attachments, 0 Photos, 0 Comments, 0 Observation				
Cameron Pumphrey responded with Safe on April 8th, 2020 at 06:14 PM CDT				
1.3 Company COVID19 policies and procedures have been made available to all subcontractor and vendor central offices.				
Activity: 1 Response Change, 0 Attachments, 0 Photos, 0 Comments, 0 Observation				



# Our Essential COVID-19 Materials

- Gloves and Masks
- No-touch temperature guns
- Hand washing stations
- Hand soap dispensers
- Industrial spray sanitizer
- Hand sanitizer
- Protocol signs
- Protocol hand-outs
- Access denied hand-outs
- Health safety screening log

## PPE Kit



Zip lock  
plastic bag



Gloves



Mask



Note (Spanish  
& English)

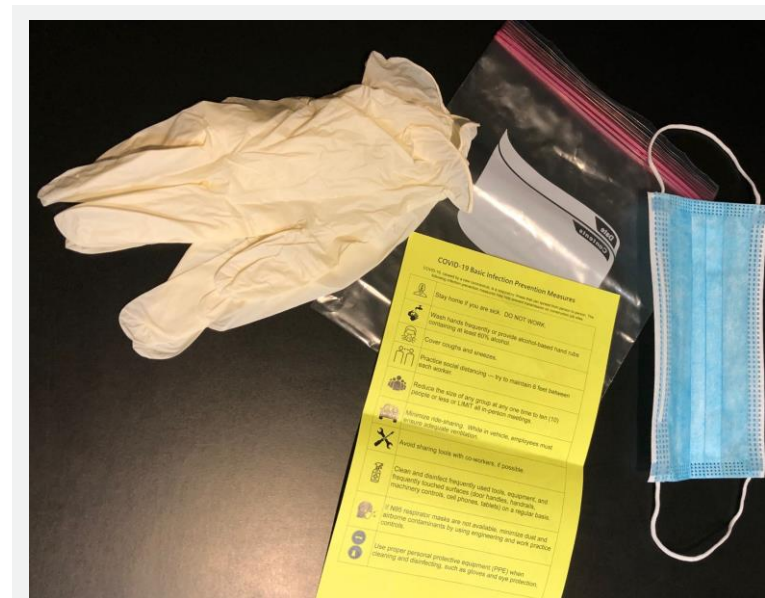



# Our Community Communication Plan

- Health Safety Protocol Signs are prominently posted at every jobsite
- Health safety protocols are shared with key industry groups:
  - Home Builders Association (HBA)
  - Austin Apartment Association
  - Austin Board of Realtors
  - Austin Chamber of Commerce
  - Real Estate Council (RECA)
  - Downtown Alliance
  - Associated Builders and Contractors (ABC)
  - AIA Austin
  - Austin LGBT Chamber of Commerce
  - Contractors and Engineers Association (ACEA)
  - Austin Infill Coalition (AIC)
- Health safety protocols are shared with the City of Austin, Travis County and State of Texas Officials
- Health Safety protocols are shared with neighborhood associations and neighbors within 500 feet of all jobsites



# Thank you for helping us Safely Build Austin's Future!

Steve Griessen

VP of Construction

[sgriessen@cumbyconstruction.com](mailto:sgriessen@cumbyconstruction.com)

O. 512.637.6635

Bryan Cumby

Founder and CEO

[bcumby@cumbygroup.com](mailto:bcumby@cumbygroup.com)

O. 512.637.1502

Melissa Brown

VP of Development

[mbrown@cumbydevelopment.com](mailto:mbrown@cumbydevelopment.com)

C. 512.688.9611

Jeff Nash

President & COO

[jnash@cumbygroup.com](mailto:jnash@cumbygroup.com)

O. 512.637.1544



**CUMBY**  
CONSTRUCTION