

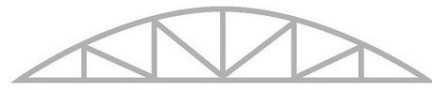

Bedford County
Chamber of Commerce
Leading Businesses. Leading Communities.™



P. JOSEPH LEHMAN, INC.
CONSULTING ENGINEERS

Present

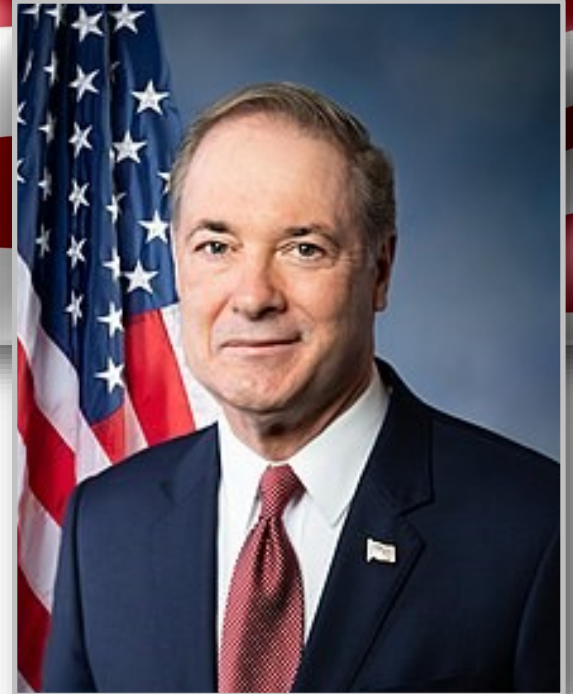

Government: *It's Your Business*
Breakfast
Featuring
Congressman John Joyce

*Join the business community of the Bedford County region
for a conversation with Congressman John Joyce.*

Topics expected to be discussed include:

Federal response to COVID-19, health care, jobs/unemployment and more...

Facilitated Q&A to follow prepared remarks.

Friday, August 14th

7:30am Breakfast; 8:00am Program

At the

Egolf Park Pavilion

2401 Egolf Road - Bedford

Please note: SOCIAL DISTANCING MEASURES

WILL BE IN PLACE for the safety of all,
including masks, no-touch buffet, seating limits, etc.

Thank you for your cooperation.

No-Touch Breakfast Buffet by:



\$25 Per Person

RSVP to 623-2233

Or Register Online



Musser Engineering, Inc.
an EARTHRES Company

www.BedfordCountyChamber.com



Bedford County
Chamber of Commerce
 Leading Businesses. Leading Communities.™

Breakfast with Congressman John Joyce
Friday, August 14, 2020
Egolf Park Pavilion

Government:

It's Your Business



The Bedford County Chamber of Commerce Government Affairs committee is proud to present the Government: It's Your Business Breakfast series, featuring our region's business leaders and elected officials, speaking about important issues relevant to the business community and citizens of our region. These sponsorships are a valuable opportunity to promote your business or organization to Chamber members and this special demographic of the socially engaged public.

Sponsor Levels & Benefits

(Please Check investment of your choice)

SOLD Blue Sponsor: \$300 (Only One Available per Event)

- Logo prominently displayed in front of room & included in all event advertising as blue "title" sponsor
- Inclusion in event promotion including logo/link on Chamber event webpage and email blasts, table tents, program, etc.
- Promotional program time to introduce your company (5 min.)
- Display table with literature available to sponsor and/or opportunity to place promotional items/information at each seat
- Inclusion in all news releases, print, web and social media postings concerning the event.
- Four (4) complimentary attendee registrations
- First right of refusal for renewal in subsequent year

Red Sponsor: \$200

- Inclusion in event promotion including logo/link on Chamber event webpage and email blasts, table tents, program, etc.
- Opportunity to place promotional items/information at each seat
- Inclusion in all news releases, print, web and social media postings concerning the event.
- Two (2) complimentary attendee registrations

White Sponsor: \$100

- Inclusion in event promotion including logo/link on Chamber event webpage and email blasts, table tents, program, etc.
- Opportunity to place promotional items/information at each seat & One (1) complimentary attendee registration

COMPANY_____ **CONTACT NAME**_____

ADDRESS_____ **PHONE**_____

EMAIL_____

If the sponsorship level I have chosen is not available, I would like the next available sponsorship: **Yes** **No**

Please Register These Attendees: _____

 (Complimentary attendees provided per sponsorship level; additional attendees, \$25 each)

Total Amount Due: _____ *Check Enclosed* ___ *Please Bill Me*

*For more information, including sponsorship availability, contact President-CEO Kellie Goodman Shaffer
 At the Chamber Office: (814) 623-2233 Or e-mail: Kellie@BedfordCountyChamber.org*