

Essex* East Orange City* (1605)

67 CRAWFORD ST LOT*

List Price: \$75,000

Land Agent Complete Report



MLS#: **3648554** Section:
 Status: **A** ZN:
 ZIP: **07018-1810*** GRS:
 MSJR:
 RZIP: HS:
 Block: **773*** Acres: **0.06***
 Lot: **17*** MinSz:
 #Lots: **1** LtSz: **25X100***
 FHA55+: **No** Zoned: **Residential Multi-Family, Residential 1 Family, Residential 2 Family**
 LotDesc: **Level Lot**
 GSMLS.com: **Yes**

LP: **\$75,000**
 OLP: **\$75,000**
 SP:
 LD: **07/15/2020**
 XD: **01/15/2021**
 UCD:
 ACD:
 CD:
 ADM: **103**
 DOM: **140**
 Terms:
 SDA: **No**

Directions: **Sanford to Rhode Island to Crawford**

Remarks: **Vacant lot(s) on quiet street. Never been built on. Ready for builders and investors. Adjoining lot is also available to double the opportunity. Realtor is owner**

GENERAL INFORMATION

Curruse: **Vacant/Improved** Locat: **Interior Lot, Residential Subdivision**
 Survey: **No**
 RdSurf: **Blacktop/Asphalt Road**

ADDITIONAL INFORMATION

RdDesc: **Blacktop/Asphalt Road**

UTILITIES

Sewer: **Public Sewer in Street** Water: **Public Water in Street**

FINANCIAL INFORMATION / TAX INFORMATION

Taxes: **\$2,295 / 2019** TaxRt: **5.400 / 2019** BidAsmt: **\$00** LndAsmt: **\$42,500** TotAsmt: **\$42,500**
 AssnFee: **\$ /** FarmAsm: **No** LenderAprrvReq: **No** Easement: **Unknown /**

SHOWING INFORMATION

Owner: **CMJ REALTY, LLC*** Sign **Yes**
 Posses: **pot**
 Show: **Owner is Licensed RE Agent, Text Agent, Vacant**

LISTING OFFICE INFORMATION

ListOff: **FIEDLER REAL ESTATE (3754)** Ph: **908-852-2200** Email: **cjacobs@frebac.com**
 ListAgt1: **CHRISTINE JACOBS (288057)** Ph: **908-797-3548** Fax:
 BB: **2.5%-\$100.00** SA: **0** TB: **0**
 LType: **Exclusive Right to Sell** BREL: **Disclosed Dual Agent** VarComm: **No**

Essex* East Orange City* (1605)

69 CRAWFORD ST LOT*

List Price: \$75,000

Land Agent Complete Report



MLS#:	3648558	Section:	
Status:	A	ZN:	
ZIP:	07018-1810*	GRS:	
RZIP:	07018	MSJR:	
Block:	773*	HS:	
Lot:	17.1*	Acres:	0.06*
#Lots:	1	MinSz:	
FHA55+:	No	LtSz:	25X100*
LotDesc:		Zoned:	Residential Multi-Family, Residential 1 Family, Residential 2 Family
GSMLS.com:	Yes		

LP:	\$75,000
OLP:	\$75,000
SP:	
LD:	07/15/2020
XD:	01/15/2021
UCD:	
ACD:	
CD:	
ADM:	103
DOM:	140
Terms:	
SDA:	

Directions: **Sanford to Rhode Island to Crawford**Remarks: **Vacant lot(s) on quiet street. Never been built on. Ready for builders and investors. Adjoining lot is also available to double the opportunity. Realtor is owner**

GENERAL INFORMATION

Curruse: Vacant/Unimproved	Survey: No
Bldgs: No Building	RdSurf: Blacktop/Asphalt Road, Public Maintained Road

ADDITIONAL INFORMATION

RdDesc: **Blacktop/Asphalt Road, Public Maintained Road**

UTILITIES

Sewer: Public Sewer in Street	Water: Public Water in Street
--------------------------------------	--------------------------------------

FINANCIAL INFORMATION / TAX INFORMATION

Taxes: \$2,295 / 2019	TaxRt: 5.400 / 2019	BldAsmt: \$00	LndAsmt: \$42,500	TotAsmt: \$42,500
AssnFee: \$ /	FarmAsm: No	LenderAprrvReq: No	Easement: Unknown /	

SHOWING INFORMATION

Owner: CMJ REALTY, LLC*	Sign Yes
Posses: pot	
Show: Owner is Licensed RE Agent, Text Agent, Vacant	

LISTING OFFICE INFORMATION

ListOff: FIEDLER REAL ESTATE (3754)	Ph: 908-852-2200	Email: cjacobs@frebac.com
ListAgt1: CHRISTINE JACOBS (288057)	Ph: 908-797-3548	Fax:
BB: 2.5%-\$100.00	SA: 0	TB: 0
LType: Exclusive Right to Sell	BREL: Disclosed Dual Agent	VarComm: No

Copyright, Garden State MLS, L.L.C.

****Info. deemed RELIABLE but not GUARANTEED - ALL Room Sizes are Approx.****

STUART L. DAVIS

Essex* East Orange City* (1605)

16 HAWTHORNE PL LOT*

List Price: \$59,900

Land Agent Complete Report



MLS#: **3630540**
 Status: **UC**
 ZIP: **07018-3330***
 RZIP: **07018**
 Block: **210***
 Lot: **3***
 #Lots: **1**
 FHA55+: **No**
 LotDesc:
 GSMLS.com: **Yes**

Section:
 ZN:
 GRS:
 MSJR:
 HS:
 Acres: **0.10***
 MinSz:
 LtSz: **35x 119**
 Zoned: **Residential 1 Family**

LP: **\$59,900**
 OLP: **\$59,900**
 SP:
 LD: **05/04/2020**
 XD: **10/29/2020**
 UCD: **10/20/2020**
 ACD: **12/20/2020**
 CD:
 ADM: **169**
 DOM: **169**
 Terms:
 SDA: **No**

Directions: **Off Central Ave**
 Remarks: **vacant land**
 Agent Remarks: **Please submit all offers to offers@weichertnewgroup.com**

GENERAL INFORMATION

Curruse: **Vacant/Unimproved**
 Survey: **No**
 RdFront: **35**
 RdSurf: **Blacktop/Asphalt Road**

ADDITIONAL INFORMATION

RdDesc: **Blacktop/Asphalt Road**

UTILITIES

Sewer: **Public Sewer in Street**
 OthUtil: **See Remarks**
 Water: **See Remarks**

FINANCIAL INFORMATION / TAX INFORMATION

Taxes: **\$2,764 / 2019** TaxRt: **5.400 / 2019** BldAsmt: **\$00** LndAsmt: **\$51,200** TotAsmt: **\$51,200**
 AssnFee: **\$ /** FarmAsm: LenderAprrvReq: **No** Easement: **Unknown /**

SHOWING INFORMATION

Owner: **NUBETO DEVELOPMENT LLC***
 Instr: **Go direct**
 Show: **Call Listing Office**
 Posses: **TBA**
 Sign: **Yes**

LISTING OFFICE INFORMATION

ListOff: **WEICHERT REALTORS NEW GROUP (3217)** Ph: **973-741-3000** Email: **augusto@weichertnewgroup.com**
 ListAgt1: **AUGUSTO VERISSIMO (233455)** Ph: **973-741-3000** Fax: **973-741-3030**
 BB: **3%-200** SA: **0** TB: **3%-200**
 LType: **Exclusive Right to Sell** BREL: **Disclosed Dual Agent** VarComm: **No**

Essex* East Orange City* (1605)

56 N ORATON PKY*

List Price: \$65,000

Land Agent Complete Report

MLS#: **3601885** Section:
 Status: **S** ZN:
 ZIP: **07017-4314*** GRS:
 RZIP: MSJR:
 Block: **252*** HS:
 Lot: **23*** Acres: **0.09***
 #Lots: **1** MinSz:
 FHA55+: **No** LtSz: **35X115**
 LotDesc: Zoned: **Residential 2 Family**
 GSMLS.com: **Yes**

LP: **\$65,000**
 OLP: **\$99,900**
 SP: **\$65,000**
 LD: **11/14/2019**
 XD: **11/13/2020**
 UCD: **08/14/2020**
 ACD: **09/11/2020**
 CD: **09/10/2020**
 ADM: **294**
 DOM: **274**
 Terms: **Cash**
 SDA: **No**

Sorry,
 No picture
 available

Directions: **Davis pl to N Oraton pkwy**

GENERAL INFORMATION

Survey: **Yes**
 RdSurf: **See Remarks**

ADDITIONAL INFORMATION

RdDesc: **See Remarks**

UTILITIES

Sewer: **Public Sewer in Street** Water: **See Remarks**

FINANCIAL INFORMATION / TAX INFORMATION

Taxes: **\$3,093 / 2018** TaxRt: **5.333 / 2018** BldAsmt: **\$2** LndAsmt: **\$58,000** TotAsmt: **\$58,000**
 AssnFee: **\$ /** FarmAsm: LenderAprrvReq: **No** Easement: **Unknown /**

SHOWING INFORMATION

Owner: **BH ESTATE PROPERTIES, LLC*** Poses: **ASAP**
 Instr: **Go direct** Sign **Yes**
 Show: **Text Agent, Vacant**

LISTING OFFICE INFORMATION

ListOff: **IMPERIAL HOME SALES, INC. (4061)** Ph: **973-743-1777** Email: **yariv.one@gmail.com**
 ListAgt1: **YARIV RAICH (266603)** Ph: **201-832-1460** Fax: **300681**
 ListAgt2: **LIAT WEISS (289236)** Ph: **267-333-2511** Email: **liat@imperial-hs.com**
 BB: **2.5%-200** SA: **2.5%-200** TB: **2.5%-200**
 LType: **Exclusive Right to Sell** BREL: **Disclosed Dual Agent** VarComm: **No**

SELLING OFFICE INFORMATION

SellOff: **RE/MAX FIRST REALTY II (5205)** Ph: **908-664-1500** Email: **mecooperhomes@gmail.com**
 SellAgt1: **MICHELLE COOPER (300681)** Ph: **9737052515** Fax: **300681**

3648554 • 67 CRAWFORD ST LOT*, East Orange City* • (1605)



Empty Lot

Copyright, Garden State MLS, L.L.C.

****Info. deemed RELIABLE but not GUARANTEED - ALL Room Sizes are Approx.****

STUART L. DAVIS

3648558 • 69 CRAWFORD ST LOT*, East Orange City* • (1605)



Vacant Lot

Copyright, Garden State MLS, L.L.C.

****Info. deemed RELIABLE but not GUARANTEED - ALL Room Sizes are Approx.****

STUART L. DAVIS

3630540 • 16 HAWTHORNE PL LOT*, East Orange City* • (1605)

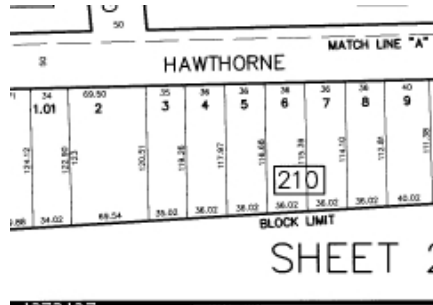

Front

Front

Copyright, Garden State MLS, L.L.C.

Info. deemed RELIABLE but not GUARANTEED - ALL Room Sizes are Approx.

STUART L. DAVIS

3601885 • 56 N ORATON PKY*, East Orange City* • (1605)

Copyright, Garden State MLS, L.L.C.

****Info. deemed RELIABLE but not GUARANTEED - ALL Room Sizes are Approx.****

[STUART L. DAVIS](#)