

Parts List			
ITEM	QTY	PART NUMBER	DESCRIPTION
1	1	CV10005	PSI DECAL (N/S)
2	1	CV21505	CV 1/2 LBF SPRING
3	1	CV30055AV	3" FP POPPET ASSEMBLY, FKM
4	1	MCV30054	3" FP MNFLD FEMALE CV BODY HALF
5	1	MCV30056	3" FP MALE HALF CV END PLATE
6	1	VL1005	FKM DECAL (N/S)

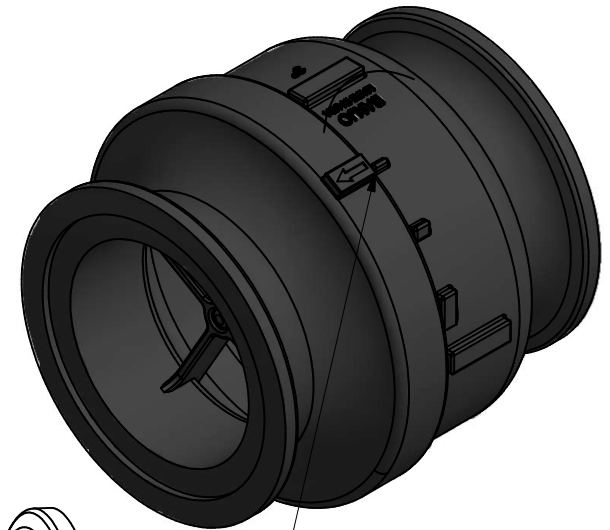

LUG TO BE ALIGNED WITH 1ST NOTCH

NOTE:
1/2 LBF SPRING
POPPET RELEASE LESS THAN 1/2 PSI

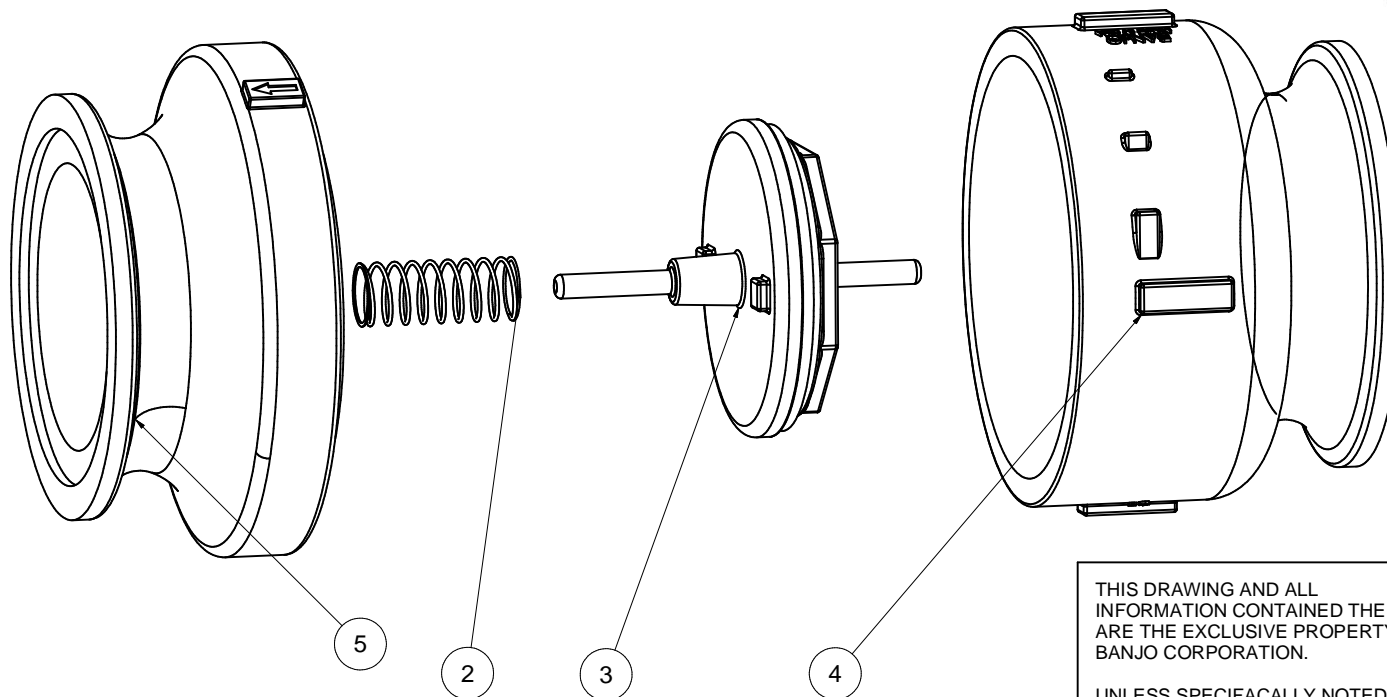

THIS DRAWING AND ALL
INFORMATION CONTAINED THEREON
ARE THE EXCLUSIVE PROPERTY OF
BANJO CORPORATION.

UNLESS SPECIFICALLY NOTED, THIS
DRAWING AND ITEMS SHOWN ON
THIS DRAWING ARE SUBJECT TO
CHANGE AT ANY TIME.



BANJO CORPORATION

150 BANJO DRIVE, CRAWFORDSVILLE, IN 47933
WEB SITE: WWW.BANJOCORP.COM
E-MAIL: SALES1@BANJOCORP.COM

DESCRIPTION
**3" FULL PORT MANIFOLD
CHECKVALVE, FKM**

PART NUMBER

MCV301V



This document was created with the Win2PDF "print to PDF" printer available at
<http://www.win2pdf.com>

This version of Win2PDF 10 is for evaluation and non-commercial use only.

This page will not be added after purchasing Win2PDF.

<http://www.win2pdf.com/purchase/>