



# UP8501/8503 1/4"-3"

**Bronze Ball Valve For Potable Water**  
**Two-Piece • Full Port (1/4"-3/4")**  
**Standard-Port (1"-3")**  
**Blow-Out Proof Stem**  
**600 PSIG WOG**  
**Threaded Ends**

**Dimensions and workmanship conform to MSS SP-110**

MATERIAL LIST			
ITEM	PART	MATERIAL	ASTM SPEC.
1	Body	Cast Bronze	B584 C89833
2	Tailpiece	Cast Bronze	B584 C89833
3	Ball	Brass w/Hard Chrome Plating	B283 C27450
		316 STAINLESS STEEL (1)	A276 S31600
4	Seat	RPTFE, 15% Glass Filled	
5	Stem	Brass	B21 C46400, H02
		316 STAINLESS STEEL (1)	A276 S31600
6	Thrust Washer	RPTFE, 25% Glass Filled	
7	Packing	PTFE	
8	Packing Nut	Brass	B16 C36000
9	Handle	Steel w/Zinc Plating	B633
10	Handle Grip	Vinyl	
11	Handle Nut	Steel w/Zinc Plating	B633
12**	Body Seal	RPTFE, 15% Glass Filled	

(1) Ball and stem are stainless for UPBA100S

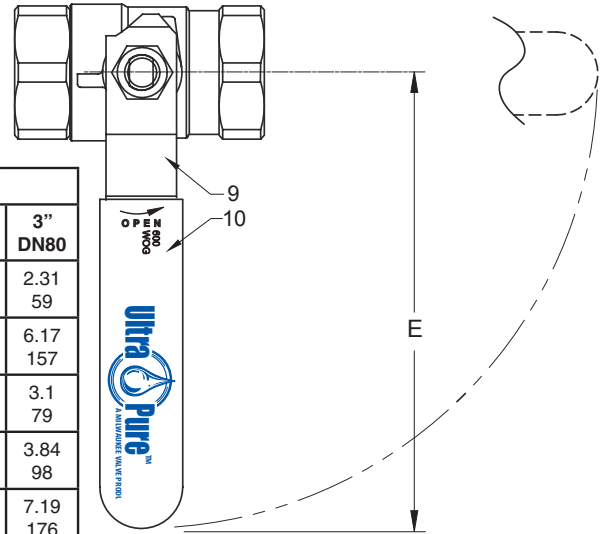
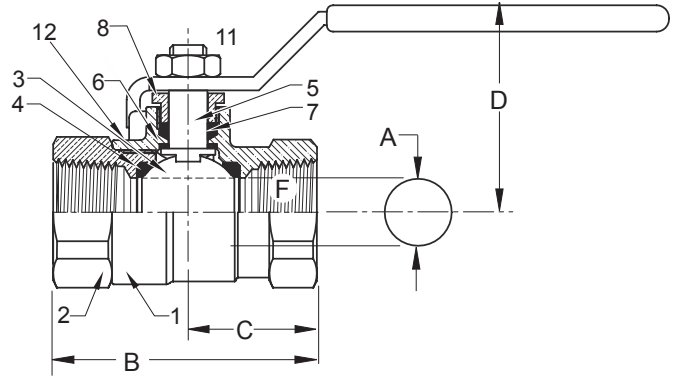

DIMENSIONS												
	UNITS	1/4" DN6	3/8" DN10	1/2" DN15	3/4" DN20	1" DN25	1 1/4" DN32	1 1/2" DN40	2" DN50	2 1/2" DN65	3" DN80	
A (DIA)	INCHES	0.38	0.38	0.5	0.76	0.88	1.06	1.31	1.56	2.00	2.31	
	mm	10	10	13	19	22	27	33	40	51	59	
B	INCHES	1.86	1.86	2.19	2.64	3.17	3.50	3.96	4.30	5.58	6.17	
	mm	46	46	54	65	78	86	97	105	142	157	
C	INCHES	1.00	1.00	1.10	1.30	1.58	1.74	1.97	2.15	2.79	3.1	
	mm	25	25	27	32	39	43	48	53	71	79	
D	INCHES	1.78	1.81	1.91	2.08	2.25	2.66	2.84	3.00	3.44	3.84	
	mm	44	44	47	51	55	65	70	74	87	98	
E	INCHES	3.81	3.81	3.81	4.56	4.56	6.31	6.31	7.19	7.19	7.19	
	mm	93	93	93	112	112	155	155	176	176	176	
F	THREADED SIZE	1/4" NPT	3/8" NPT	1/2" NPT	3/4" NPT	1" NPT	1 1/4" NPT	1 1/2" NPT	2" NPT	2 1/2" NPT	3" NPT	
	Cv	7	7	13	30	38	61	87	121	228	305	

Note: DN (Diameter Nominal)=Metric equivalent size.

Hammond Valve  
 16550 W. Stratton Drive  
 New Berlin, WI 53151  
 Phone: 262-432-2702  
 Fax: 262-432-2703

\* 3rd Party Certified as Milwaukee UPBA100/100S

\*\* 2 1/2" and 3" Only

**Note:** Lead free refers to the wetted surface of the pipe, fittings and fixtures in potable water systems that have a weighted average lead content ≤ 0.25%. Source: California Health and Safety Code (116875).

The information presented on this sheet is correct at the time of publication. Hammond Valve reserves the right to change design, and/or material specifications without notice. For the Installation, Operation and Maintenance Manual (IOM) see the Technical/Service Information section on our website. For the most current information access [www.hammondvalve.com](http://www.hammondvalve.com)  
 Hammond Valve is a registered trade mark of Milwaukee Valve Company.





# UP8511/8513 3/8" - 3"

**Bronze Ball Valve For Potable Water**  
**Two-Piece • Standard-Port**  
**Blow-Out Proof Stem**  
**600 PSIG WOG**  
**Solder Ends**

**Dimensions and workmanship conform to MSS SP-110**

MATERIAL LIST			
ITEM	PART	MATERIAL	ASTM SPEC.
1	Body	Cast Bronze	B584 C89833
2	Tailpiece	Cast Bronze	B584 C89833
3	Ball	Brass w/Hard Chrome Plating	B283 C27450
		316 STAINLESS STEEL (1)	A276 S31600
4	Seat	RPTFE, 15% Glass Filled	
5	Stem	Brass	B21 C46400, H02
		316 STAINLESS STEEL (1)	A276 S31600
6	Thrust Washer	RPTFE, 25% Glass Filled	
7	Packing	PTFE	
8	Packing Nut	Brass	B16 C36000
9	Handle	Steel w/Zinc Plating	B633
10	Handle Grip	Vinyl	
11	Handle Nut	Steel w/Zinc Plating	B633
12**	Body Seal	RPTFE, 15% Glass Filled	

(1) Ball and stem are stainless for UP8513

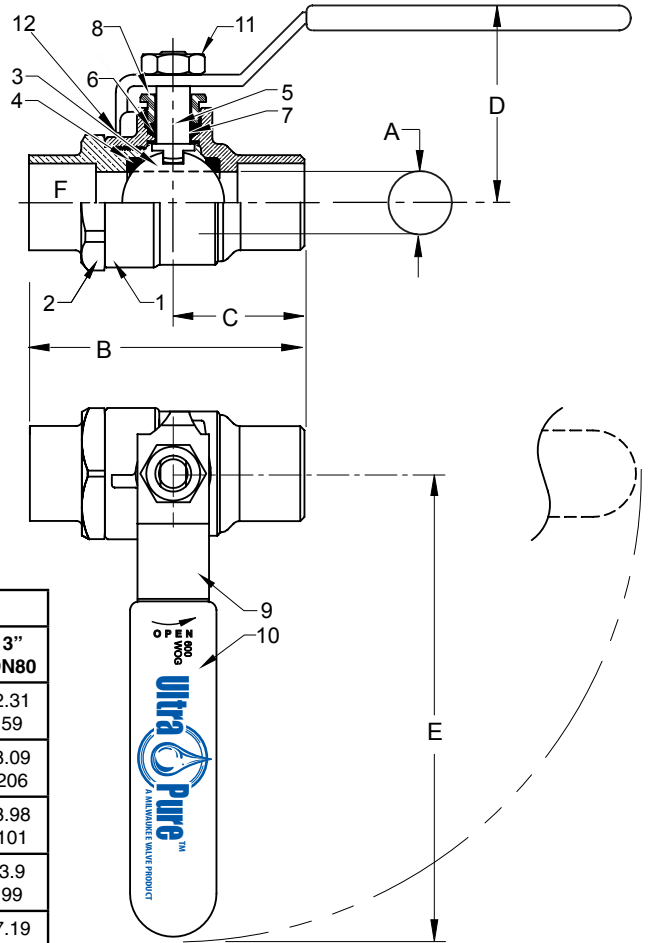

DIMENSIONS										
	UNITS	3/8" DN10	1/2" DN15	3/4" DN20	1" DN25	1 1/4" DN32	1 1/2" DN40	2" DN50	2 1/2" DN65	3" DN80
A (DIA)	INCHES	0.38	0.5	0.76	0.88	1.06	1.31	1.56	2.00	2.31
	mm	10	13	19	22	27	33	40	51	59
B	INCHES	1.86	2.19	2.64	3.17	3.50	3.96	4.30	7.36	8.09
	mm	46	54	65	78	86	97	105	187	206
C	INCHES	1.00	1.10	1.30	1.58	1.74	1.97	2.15	3.67	3.98
	mm	25	27	32	39	43	48	53	93	101
D	INCHES	1.81	1.91	2.08	2.25	2.66	2.84	3.00	3.44	3.9
	mm	44	47	51	55	65	70	74	87	99
E	INCHES	3.81	3.81	4.56	4.56	6.31	6.31	7.19	7.19	7.19
	mm	93	93	112	112	155	155	176	176	176
F	TUBE SIZE Ø	.51	.63	.88	1.13	1.38	1.63	2.13	2.63	3.13
Cv		7	13	35	38	61	87	121	196	231

Note: DN (Diameter Nominal)=Metric equivalent size.

Hammond Valve  
 16550 W. Stratton Drive  
 New Berlin, WI 53151  
 Phone: 262-432-2702  
 Fax: 262-432-2703

\* 3rd Party Certified as Milwaukee UPBA150/150S  
 \*\* 2 1/2" and 3" Only

**Note:** Lead free refers to the wetted surface of the pipe, fittings and fixtures in potable water systems that have a weighted average lead content ≤ 0.25%. Source: California Health and Safety Code (116875).

The information presented on this sheet is correct at the time of publication. Hammond Valve reserves the right to change design, and/or material specifications without notice. For the Installation, Operation and Maintenance Manual (IOM) see the Technical/Service Information section on our website. For the most current information access [www.hammondvalve.com](http://www.hammondvalve.com)  
 Hammond Valve is a registered trade mark of Milwaukee Valve Company.

