

D I S T I N C T I V E
D E T A I L S

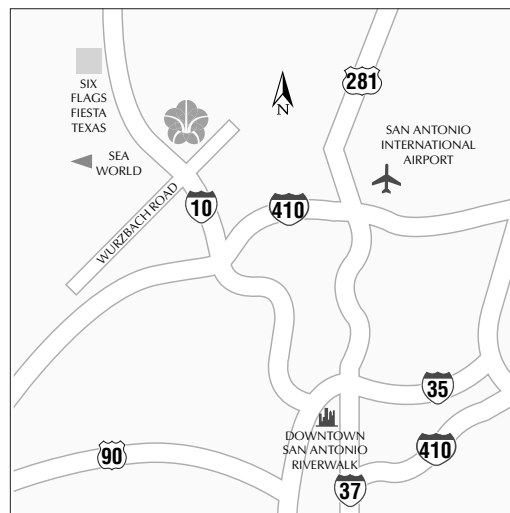

DIRECTIONS

From San Antonio International Airport: I-410 West to I-10 West; Exit Wurzbach to the Colonnade Office Complex; Hotel is located on the right.

From I-35: Exit 1604 West (Anderson Loop) to I-10 East to San Antonio; Exit Wurzbach, cross under I-10 in turn-around lane; Hotel will be on the right.

DESTINATIONS

In the heart of Texas lies a unique jewel of Texas hospitality, the Omni San Antonio Hotel at the Colonnade. Alive with the spirit of San Antonio, this four-diamond hotel captures the essence of the city with impeccable service and charm. Overlooking the rolling Texas Hill Country, this 19-story high-rise is close to the area's most exciting sites and attractions such as the historic Alamo, SeaWorld, Six Flags Fiesta Texas, the Shops at La Cantera, North Star Mall, and the enchanting Riverwalk. After a long day of sightseeing, return to your private guest room for an in-room massage, or sit back and enjoy live piano music in the Lobby Bar while our first-class staff caters to your every need.

LOCATION

- Located in northwest San Antonio at I-10 and Wurzbach Road in the Colonnade Office Complex
- 3 minutes/1 mile to the Medical Center
- 15 minutes/8 miles from the San Antonio International Airport
- 15 minutes/12 miles to the San Antonio Riverwalk area
- Convenient to I-10 and Loop 410
- Numerous restaurants, a beauty salon, jewelry store, coffee bar and ice cream shop in the neighboring Colonnade Office Complex
- 15 minutes/12 miles to the Alamo, "The Cradle of Texas Liberty," where 189 Texas patriots died on March 6, 1836, after a 13-day battle with Mexican General Antonio Lopez de Santa Anna
- 15 minutes/12 miles to El Mercado (Market Square) – a unique area patterned after an authentic Mexican market
- 15 minutes/12 miles to the Riverwalk – El Paseo del Rio. Located in the heart of downtown, the Riverwalk is the pride of the city. Lush green foliage lines the banks of this peaceful jade-green historic river. Cobblestone walkways lead visitors to the river level restaurants and shops. River cruisers travel the Riverwalk's three miles past unique retail shops, restaurants and nightclubs.

ATTRACTIONS

- 5 minutes/3 miles to Six Flags Fiesta Texas Theme Park
- 5 minutes/5 miles to the North Star Mall, the largest mall in San Antonio
- 5 minutes/5 miles to the Shops at La Cantera
- Within 10 minutes to 3 PGA Championship golf courses
- 12 minutes/10 miles to La Villita – an arts and crafts community with 26 shops, featuring working artists, three restaurants and a post office
- 15 minutes/12 miles to the H.B. Gonzalez Convention Center
- 15 minutes/12 miles to the Alamodome
- 25 minutes/18 miles to SeaWorld San Antonio, a marine life water theme park

TEMPERATURE

- San Antonio enjoys mild temperatures during the winter, spring and fall, with an average temperature of 78°.

SAN ANTONIO WEATHER

Month	High	Low
January	65.1	55.1
February	70.7	60.7
March	79.0	69.0
April	85.6	75.6
May	90.6	80.6
June	93.4	83.4
July	92.7	82.7
August	98.0	78.0
September	80.1	70.1
October	71.1	61.1
November	68.3	58.3
December	61.9	51.9

TRANSPORTATION

- Complimentary airport transportation
- San Antonio International Airport is located 8 miles from the hotel.
- Our guest services staff can arrange for car rental pick-ups and drop-offs.

ACCOMMODATIONS

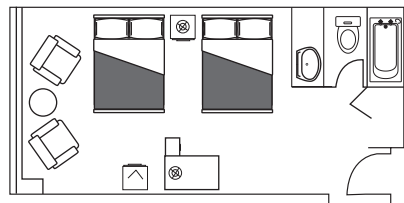

DOUBLE/DOUBLE

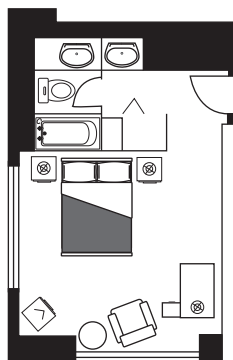

CORNER KING BEDROOM

GUEST ROOMS

Each of our 326 guest rooms includes an in-room refreshment center, coffee maker, hair dryer, iron and ironing board, on-demand hit movies, Nintendo® 64 games, two telephones with high-speed wireless Internet access. The Parlor King features a bedroom with separate seating area, while the Corner King has a large open room with two windows with views of the city.

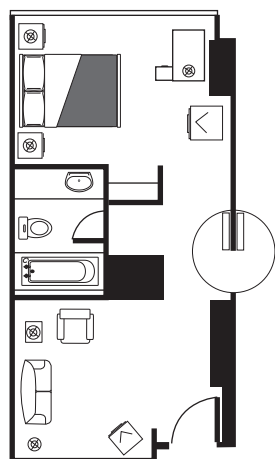

PARLOR KING

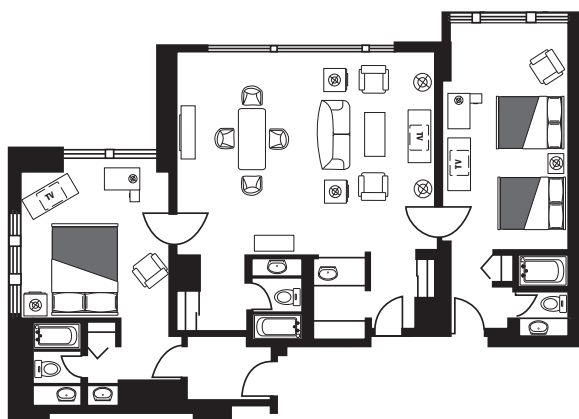

PRESIDENTIAL SUITE

SUITES

We feature two magnificent two-bedroom suites, the Presidential and Governor's Suites, each with breathtaking views of the Texas Hill Country. Our one-bedroom Omni Suite is ideal for executives, small meetings, interviews or for honeymooners.

GUEST ROOM INVENTORY

Room Category	Number	Square Feet	Special Features
Double/Double	159	400	Hill Country, city or pool view with large bay window
Corner King Bedroom	64	300	Hill Country, city or pool view with large bay window
Parlor King	63	410	Hill Country, city or pool view with large bay window - twin soft bed
Sitting King	32	400	Hill Country, city or pool view with large bay window - double soft bed
Governor's Suite	1	1,200	Located on 20th floor. Formal dining room (seats eight), wet bar, two bedrooms, three bathrooms, two closets, refrigerator, Hill Country view.
Omni Suite	1	800	Located on 20th floor. Dining table (seats six), wet bar, one bedroom, two bathrooms, two closets, refrigerator, Hill Country view.
Presidential Suite	1	1,200	Located on 20th floor. Formal dining room (seats eight), living room, two bedrooms, wet bar, three bathrooms, two closets, refrigerator, Hill Country view.
Omni Sensational Kids Suite	1	810	Kids room has two twin beds, two bean bag chairs, a child-size desk and a wall-mounted TV and DVD player.

All guest rooms equipped with fully stocked refreshment center, iron and ironing board, bathrobes, work desk and chair, hair dryer, coffee maker, dual phone lines, two phones with dataports, LodgeNet system featuring on-demand hit movies and Nintendo® 64 video games and sitting area.