

BUT YOU ARE A **CHOSEN RACE**  
»—☆—☆—☆—»  
**ROYAL** **HOLY** **PEOPLE**  
PRIESTHOOD **NATION** FOR HIS OWN  
POSSESSION  
THAT YOU MAY PROCLAIM  
THE EXCELLENCIES OUT OF DARKNESS  
OF HIM WHO INTO HIS MARVELOUS  
**CALLED YOU LIGHT** ☼  
«—ONCE—»  
YOU WERE NOT A PEOPLE  
BUT NOW **GOD'S PEOPLE**  
YOU ARE  
ONCE YOU HAD NOT RECEIVED MERCY BUT NOW  
YOU HAVE RECEIVED  
**M E R C Y**

1 PETER 2:9-10

# Cornerstone Church Retreat 2017

Dear Cornerstone Family,

I am so excited that we are gathering again at Liebenzell for a weekend of rest, relaxation, and learning about how we can better follow Jesus in our lives. While we will have some time for fun and games, we will also be diving deep into the application of our faith. Our theme this year is “No Longer A Slave.” In pursuing this theme, we are going to examine how our church can be involved in enjoying our freedom in Christ and seeking to offer that freedom to others in practical ways. It’s going to be a great weekend!

In Christ,  
Pastor Nate

*But you are a chosen race, a royal priesthood, a holy nation,  
a people for his own possession,  
that you may proclaim the excellencies of him  
who called you out of darkness into his marvelous light.  
Once you were not a people, but now you are God's people;  
once you had not received mercy, but now you have received mercy.  
1 Peter 2:9-10*



## **Cornerstone Retreat Schedule:**

### **Friday:**

- 3:00: Check in at Liebenzell Retreat Center – Ebenezer House –
  - ***See Lesley upon arrival for your room number.***
- 6:00: Dinner in the Dining Hall
- 7:00: Bonfire in front of the Ebenezer House
- 9:00: Free Time in the Ebenezer House or outdoors
  - Games/Snacks in the Dining Hall. – Please, NO eating outside the Dining Hall or the Gathering Room.
  - Relax in the Parlor or the Library
- 11:00 – 7:00am: Quiet Hours, no outdoor activities

### **Saturday:**

- 8:00: Breakfast in the Dining Hall
- 8:45: Prayer Walk
- 9:45: Morning Session in the Chapel – adults and children
  - Older Children will be dismissed for their own session outdoors
  - There will be a gated area set up in the Chapel for the babies
- 12:30: Lunch in the Dining Hall
- 2:00: Hayride - meet outdoors behind the Ebenezer House in the parking lot
- 3:00 – 5:30: Recreation Time at the Playground, meet in the parking lot behind the Ebenezer to drive over to the playground
  - Playground, swings, slides for the children
  - Basketball, Volleyball, Kickball, etc.
  - Lots of room to sit and enjoy the sun if you don't want to play
- 6:00: Dinner at the Dining Hall
- 8:00: Evening Session for adults in the Parlor
- 9:30: Free Time in the Ebenezer House
  - Games/Snacks in the Dining Hall. – Please, NO eating outside the Dining Hall or the Gathering Room
  - Relax in the Parlor or the Library
  - Ping Pong in the Lounge
- 11:00 – 7:00am: Quiet Hours, no outdoor activities

### **Sunday:**

- 8:00: Breakfast in the Dining Hall
- 8:45: Prayer Walk
- 10:00: Outdoor Worship Service in the lawn behind the Ebenezer House
  - adults and children, bring a towel or camp chair to sit on
- 12:30: Lunch in the Dining Hall
- 2:00: Check Out

## **Directions to Liebenzell USA Guest House:**

### **Travel Information:**

- Liebenzell USA Guest House
- GPS Address: 13 Heath Lane, Long Valley, NJ 07853

From Bay Ridge:

- Take 278 W toward Staten Island – Verrazano Bridge
- Take Exit 5 to 440 S toward Outerbridge Crossing
- Stay on 440 to 287 N
- Continue on 287 (About 18 miles)
- Take Exit 21B toward 78 W / Easton Pa
- Continue on 78
- Take Exit 24 for Old Turnpike Road (Co. Rd. 523/Oldwick Rd.toward Co. Rd. 51)
- Turn Right on Co. Rd. 523/Oldwick Rd.
- Stay on this road and it will turn into Old Turnpike Rd. then Fairmount Rd, and then into Schooley's Mt. Rd. It is about 13 miles from 78 to get to Liebenzell.
- Turn left on Heath Ln.
- Park in the back of Ebenezer Guest House

Once you turn right on Oldwick Rd. you will spot 4 creatures by the time you make it to Liebenzell. If you can name all 4 correctly, there will be a prize!

1.

2.

3.

4.

## **Information about Liebenzell and the Ebenezer House:**

### **Ebenezer House:**

- Everything we do indoors will be in the Ebenezer House.
- All linens and towels will be provided for you in your room. Soap is provided as well.
- Most rooms share a bathroom with the other rooms on their floor. Many of the rooms have a sink in the room as well.

### **Outdoors:**

- There is a lot of space to run around, play in the grass, read a book, take a walk, etc. Cornerstone will provide volleyball, basketball, kickball, and general sports equipment. Feel free to bring any other outdoor equipment you desire to use.
- Feel free to bring a picnic blanket and/or camping chairs if you want. There are benches and picnics tables throughout the area.
- Children are welcome to bring tractors, trucks, and outdoor toys to play with.
- Bring Sunscreen – AND RAIN GEAR!

### **Safety:**

- There is a road between the house and pond that is accessed by cars. Parents, please keep an eye on children especially while playing in the front yard and near the pond.
- There are a few areas in the Ebenezer House where children should not run or play.

**These areas will be marked with a stop sign.**

### **Bonfire:**

- The bonfire area is located in front of the Ebenezer House. There is a pond near the bonfire area. It would be appreciated if everyone can please help keep an eye on the children.

### **Food:**

- All meals will be held in the Dining Hall. Please NO eating in your rooms or in the common areas of the Ebenezer House. All snacks will be kept in the Gathering Room (the snack room near the dining room). Feel free to bring any snacks for yourself or to share during free time. There will be coffee/hot tea/hot chocolate and water in the Gathering Room during the day. There is also access to a refrigerator on the first floor and a microwave in the Dining Hall.
- You will be given a meal bracelet at check in. Bracelets must be worn for meals.

### **Nursery/Playroom:**

- The nursery/playroom is reserved for our church all weekend. The children are welcome to play throughout the day, please help your children to clean up when they are done. All toys must remain in the room.

### **Chapel/Lounge:**

- Cornerstone will be meeting in the Chapel this year. There will be another group meeting in the Lounge Friday and Saturday morning. Please be respectful to their meetings when they are in the Lounge. As a result, the ping pong tables may not be available until after lunch on Saturday.

## Ebenezer House:

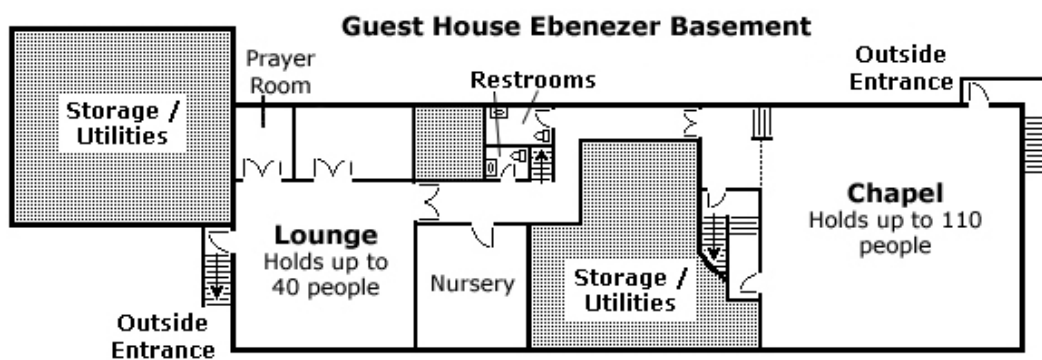
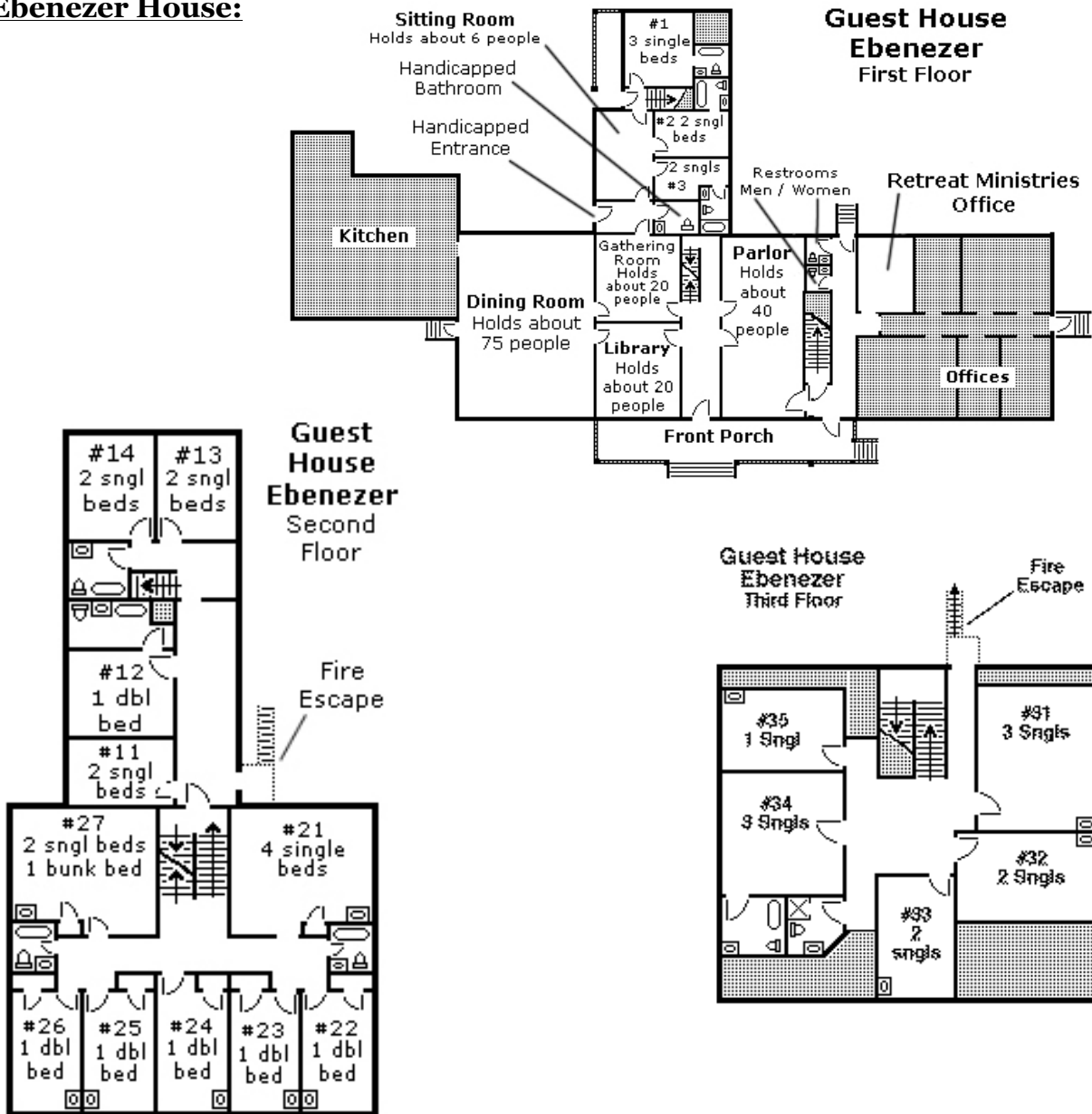

## **Prayer Walk:**

On Saturday morning and Sunday morning we will start the day off with a prayer walk for those who want to join us. The walk goes through two grass fields on Liebenzell's property; please wear good shoes to make the walk. The walk is about a mile.

Prayer Points to Consider:

- Our summer events – Summer Celebration & VBS. Pray for all the details to come together and pray for us to impact the neighborhood with the gospel.
- Our missionaries around the world – that they would be able to initiate relationships with the lost and see churches planted.
- Our church – pray for us to grow deeper in our faith during and after our retreat and for new people to come and hear about the love of Jesus.
- Individually – pray for God to lead you as you make big decisions in your own life  
“I will instruct you and teach you in the way you should go; I will counsel you with my eye upon you.” – Psalm 32:8

\* Encourage your children to spend this time praying for the children that will come to VBS and Summer Celebration, that God can use them to invite their friends to these events, and that they would be bold to share their faith with others!

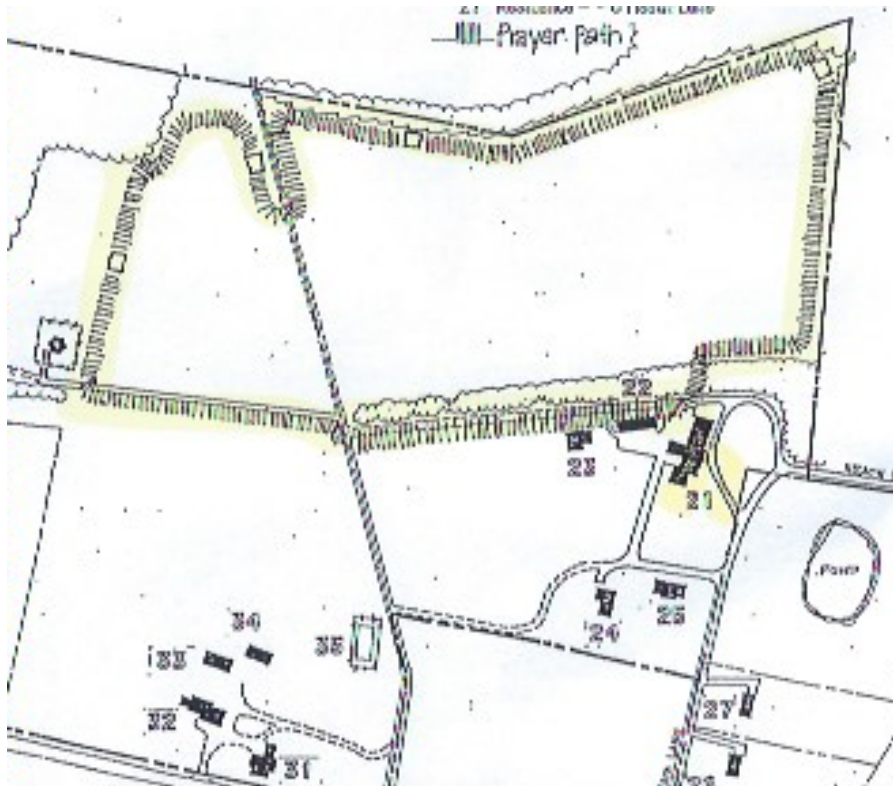

## Recreation Area:

On Saturday from 3:00 – 5:30 we will have a recreation time at the Playground. We will meet in the parking lot behind the Ebenezer to drive over to the playground. We will have some sporting equipment, feel free to bring blankets or chairs to sit on.

You may park at the play area.

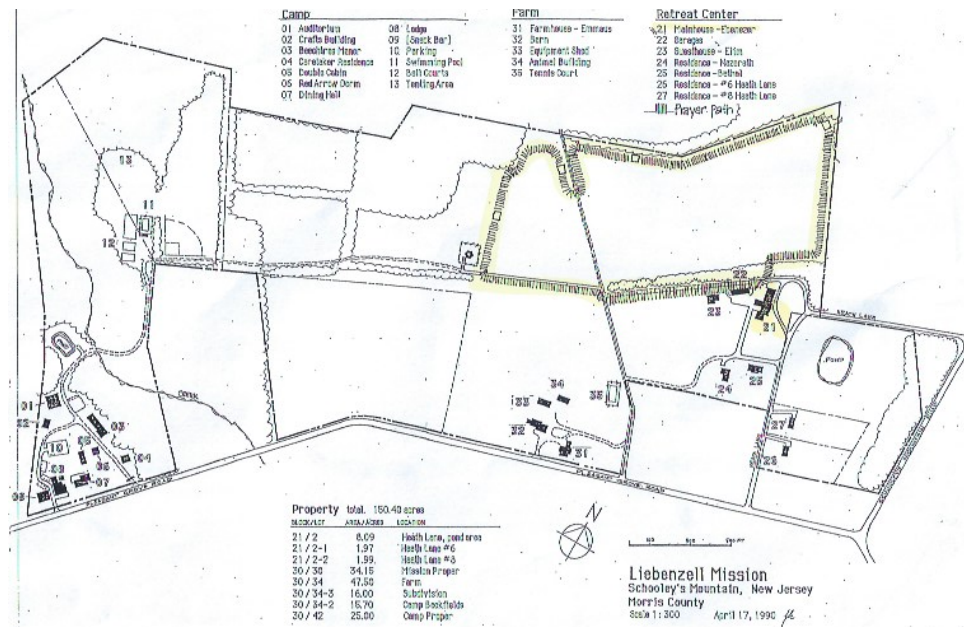

## Map Key:

- 15 - Playground, swings, slides
- 14, 13 - Basketball, Volleyball
- 20 - Kickball
- 16 - Picnic Tables
- 21 - Huge field for kids to run!

